



Yew Tree Cottage Thurlow Road
Newmarket, CB8 9LW
£425,000

MA
Morris Armitage
01638 560221
www.morrisarmitage.co.uk

A rare and exciting opportunity to purchase a plot set in a desirable location within the village of Great Bradley and offering spectacular views across open countryside.

With planning permission in place to remove the existing property and replace with a 2,300 sq ft detached family home with accommodation including living room, snug, open plan kitchen/dining room, utility room and cloakroom to ground floor, with 4 double bedrooms, all en-suite, and office/study to the first floor.

Planning permission can be viewed on West Suffolk Planning Portal ref: DC/22/2136/FUL

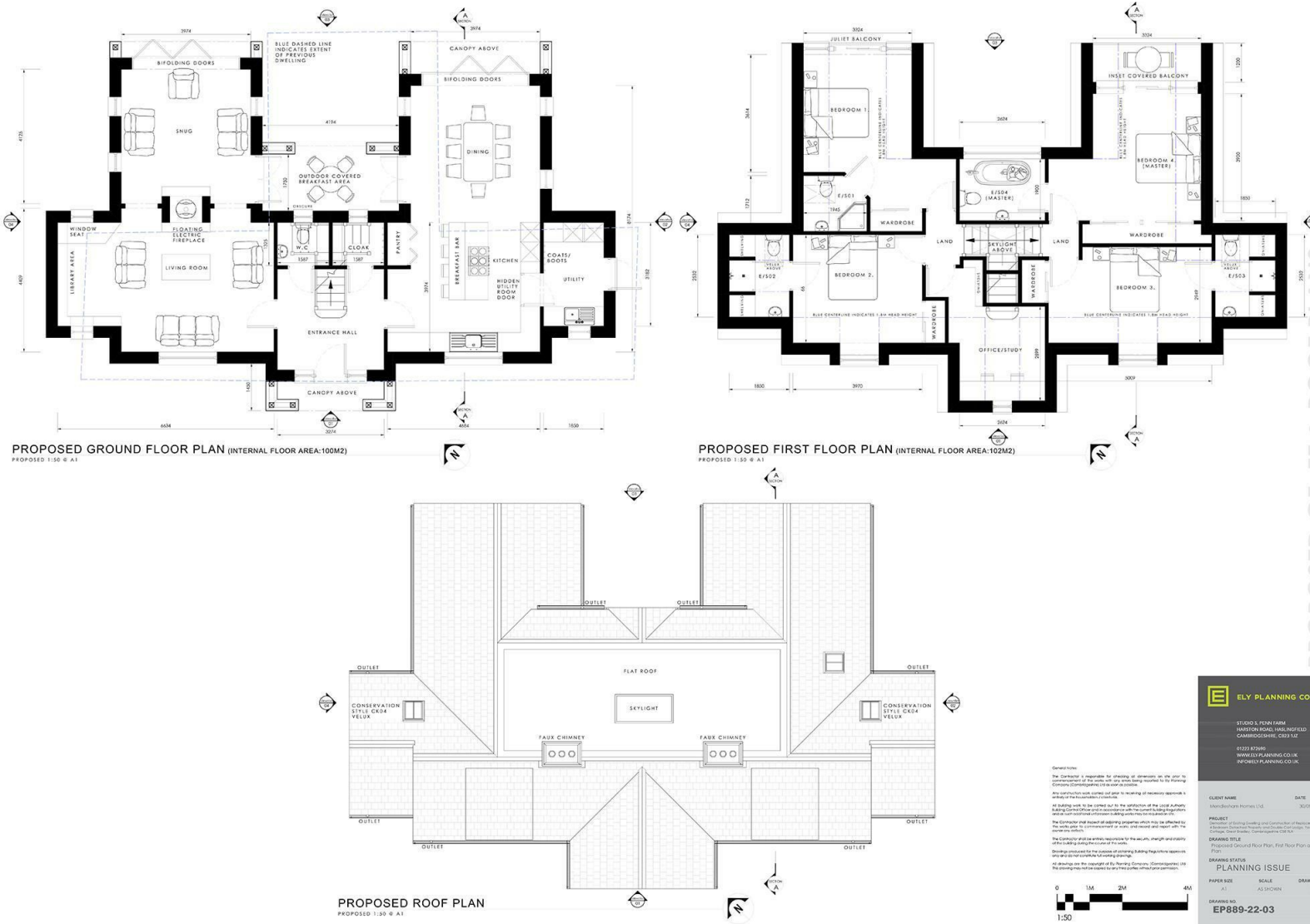

ELY PLANNING CO.

STUDIO 3, PENN FARM
HAYDON ROAD, HAY, IPFIED,
CAMBRIDGESHIRE, CB24 3JL

01223 873695
WWW.ELYPLANNING.CO.UK
INFO@ELYPLANNING.CO.UK

CLIENT NAME DATE
Dorchester Homes Ltd. 20/09/22

PROJECT
Removal of Existing Dwelling and Construction of Replacement 2-Storey Detached Residential Development on the Site of an Existing 1-Storey Detached Residential Development

DRAWING TITLE
Proposed Ground Floor Plan, First Floor Plan and Roof Plan

DRAWING NUMBER
PLANNING ISSUE

PAPER SIZE **SCALE** **DRAWN BY**
A1 AS SHOWN D.H.

DRAWING NO.
EP889-22-03

A



This document and any marketing relating to the property has been prepared in good faith to give a fair overall view of the property and should not be relied upon as statements or representations of fact. It is suggested that undertake enquiries by inspections, survey or other investigation to ascertain the viability of any purchase. Any areas, measurements or distances referred to are given as a guide only and are not precise and no liability can be accepted for errors arising from them. Photographs are not necessarily comprehensive nor current; no assumption should be made that any contents shown are included in the sale. Morris Armitage have not tested any services or equipment and nothing in these particulars should be deemed to be a statement that they are in good working order nor that the property is in good structural condition.



