

Tel: 01923 677755  
Fax: 01923 680729

[www.claytons.co.uk](http://www.claytons.co.uk)

Claytons 



**TUDOR WALK, WATFORD - £585,000**  
**3 Bedroom Semi-detached House**







Charming 3 bed semi-detached house set in the popular Tudor Estate and benefitting from a rear extension, garage and garden office.

The ground floor contains; living room, lounge, utility room (with downstairs toilet) and rear extension with kitchen / dining room.

The first floor contains; 2 double bedrooms, family bathroom, additional separate toilet and good sized 3rd bedroom.

To the rear is a spacious east-facing garden with garden office and pond.

To the front there is off street parking and a single garage.

Council Tax Band - D (Watford)

- 3 bed semi-detached house
- 2 double bedrooms
- Rear extension with kitchen
- Living room
- Additional lounge
- Utility room with Downstairs toilet
- Set on the popular Tudor Estate
- Garden office

Due to its brilliant location, the house is in close proximity to excellent schools, has easy access to the major road links of M1 and M25 and is only a short distance to all local amenities.

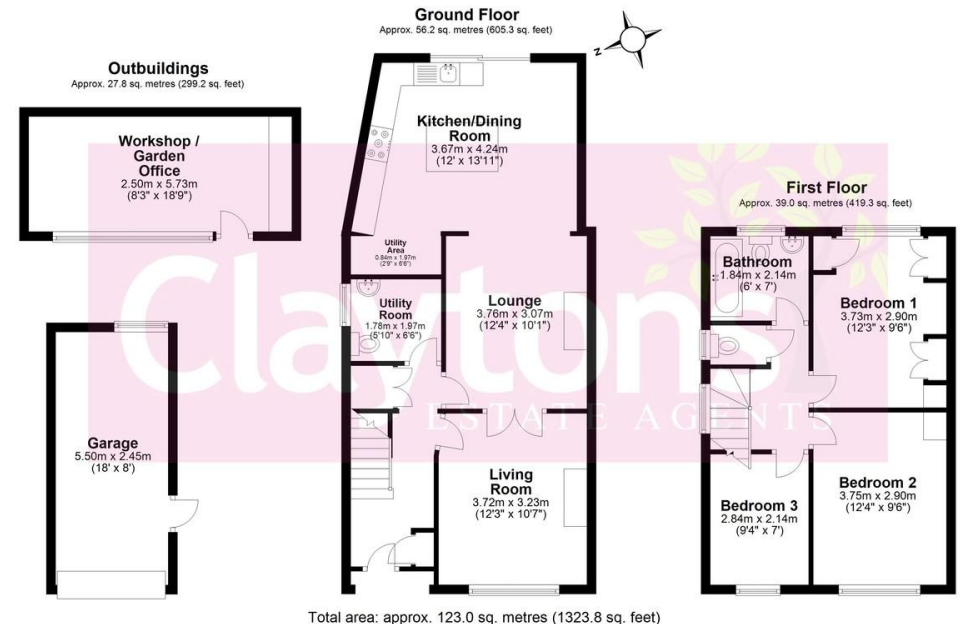

 **VIEWING BY APPOINTMENT THROUGH CLAYTONS 01923 677755**

#### **FREE VALUATIONS & MARKETING ADVICE**

Can we assist you in the sale of your property? If your home is situated within the catchment area of one of our sales offices we would be pleased to offer you a free valuation and market appraisal, a service which we provide without obligation. Competitive fees are always available for both sole and multiple agency. Please contact David Clayton on 01923 677755.

NB 1) We have not tested any appliances and/or services mentioned in these property particulars and do not intend to imply they are in full working order. Photographs are for illustrative purposes only and may show items that are not included in the sale of this property. 2) Due to Money Laundering Regulations 2003 we will ask all prospective purchasers for identification. 3) Buyers should seek verification from their solicitor about the legal title of this property.

These particulars are intended only to give fair description of the property, as a guide to prospective buyers. Accordingly, a) their accuracy is not guaranteed and neither Claytons nor the Vendor(s) accept any liability in respect of their contents; b) they do not constitute an offer or contract of sale, and c) any prospective purchaser should satisfy themselves by inspection or otherwise as to the correctness of any statements or information on these particulars.

Claytons & Hayes Ltd • Registered in England No. 2655243 • Registered Office: 4 Garston Park Parade, Garston, Watford, Herts WD25 9LQ • vat No. 579331903

**See all our properties at [www.claytons.co.uk](http://www.claytons.co.uk)**

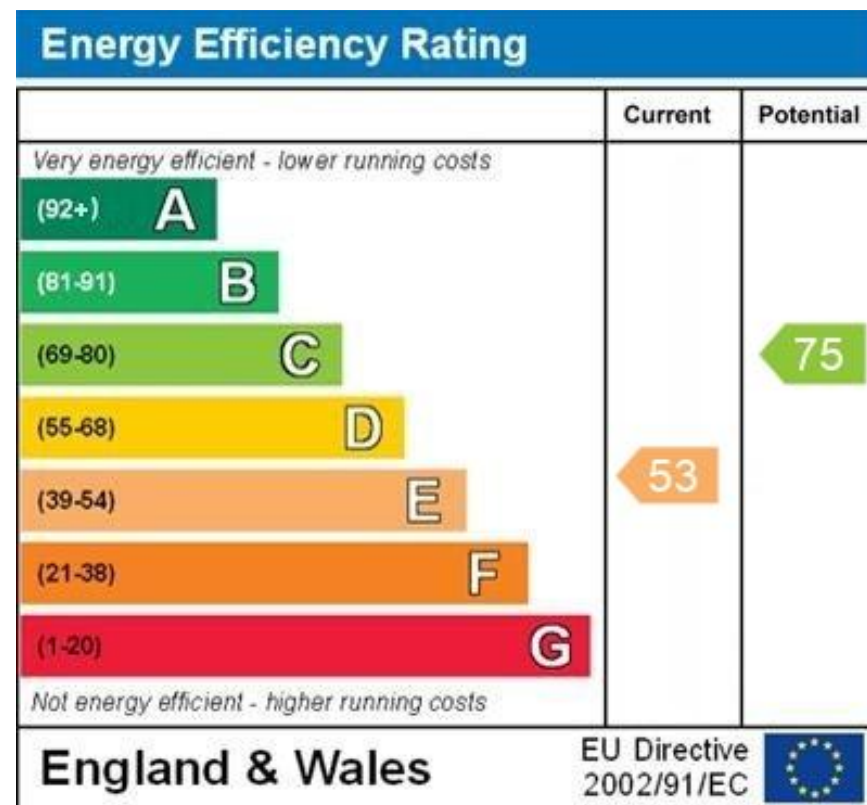

WWW.EPC4U.COM