

Tel: 01923 677755
Fax: 01923 680729

www.claytons.co.uk

Claytons 



HEMPSTEAD ROAD, WATFORD - £1,500,000
5 Bedroom Detached House



Substantial 5 double bedroom detached house on a large plot of land with lots of potential to extend (STPP) on the popular Cassiobury Estate.

The ground floor contains; Modern kitchen, dining room with feature fireplace, extended living room, study room, utility room, downstairs toilet, plenty of storage and internal access to the garage.

The first floor contains; 5 large double bedrooms and 2 bathrooms.

To the rear is a very large (approx.) 45m / 147 ft west-facing garden with patio, plenty of mature trees, allotment and side access.

To the front there is a spacious driveway and single garage.

- 5 bed detached house
- 5 double bedrooms
- 2 family bathrooms
- Modern Kitchen
- Extended living room
- Dining room with feature fireplace
- Set on the popular Cassiobury Estate
- Utility Room
- Council Tax Band - G (Watford)

Due to its brilliant location, the house is in close proximity to excellent schools, has easy access to the major road links of the M1 & M25 and is only a short distance to all local amenities.

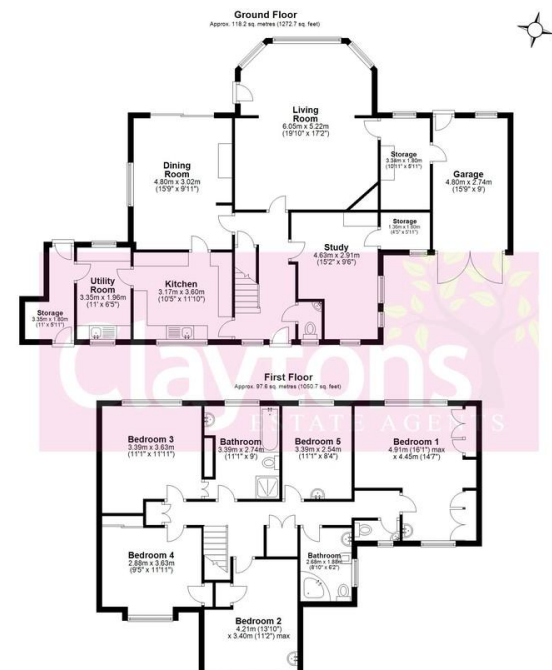

 **VIEWING BY APPOINTMENT THROUGH CLAYTONS 01923 677755**

FREE VALUATIONS & MARKETING ADVICE

Can we assist you in the sale of your property? If your home is situated within the catchment area of one of our sales offices we would be pleased to offer you a free valuation and market appraisal, a service which we provide without obligation. Competitive fees are always available for both sole and multiple agency. Please contact David Clayton on 01923 677755.

%epcGraph_c_1_434%

NB 1) We have not tested any appliances and/or services mentioned in these property particulars and do not intend to imply they are in full working order. Photographs are for illustrative purposes only and may show items that are not included in the sale of this property. 2) Due to Money Laundering Regulations 2003 we will ask all prospective purchasers for identification. 3) Buyers should seek verification from their solicitor about the legal title of this property.

These particulars are intended only to give fair description of the property, as a guide to prospective buyers. Accordingly, a) their accuracy is not guaranteed and neither Claytons nor the Vendor(s) accept any liability in respect of their contents; b) they do not constitute an offer or contract of sale, and c) any prospective purchaser should satisfy themselves by inspection or otherwise as to the correctness of any statements or information on these particulars.

Claytons & Hayes Ltd • Registered in England No. 2655243 • Registered Office: 4 Garston Park Parade, Garston, Watford, Herts WD25 9LQ • vat No. 579331903

See all our properties at www.claytons.co.uk