



OFFERS IN THE REGION OF

£220,000

Walton Lane

Wakefield, WF2 6AL



HODSONS

Offered for sale with no onward chain is this superb ground floor apartment set within the exclusive Sandal Grange development with extensive landscaped gardens and ample parking. The building itself dates back to circa 1840 when it was constructed as a private mansion house and was converted into luxury apartments just over 15 years ago. The apartment has recently undergone a full upgrade to incorporate high quality fixtures and elegant decor whilst tastefully retaining the charm and character of the original building. The gas centrally heated apartment is predicted to have wide appeal from a professional person / couple to those of retirement age looking to down size. Sandal Grange is set within private landscaped grounds accessed off Walton Lane. Sandal is one of Wakefield's premier locations within close proximity to a full range of local amenities, facilities and schools, and offering excellent commuter links to the Yorkshire region by both road and rail.

2



1



1









Approx Gross Internal Area
50 sq m / 533 sq ft

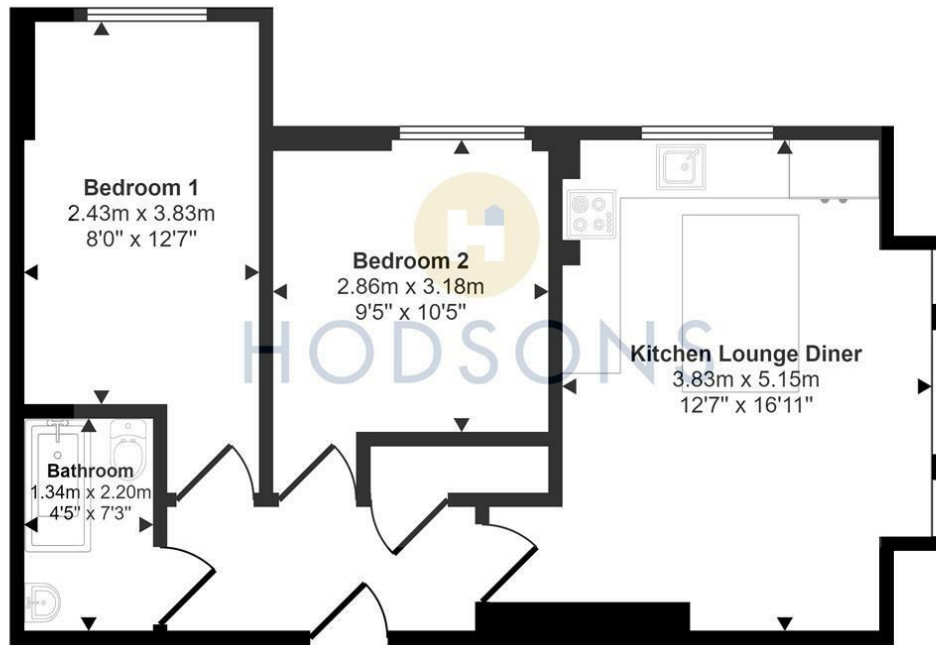

Floorplan

This floorplan is only for illustrative purposes and is not to scale. Measurements of rooms, doors, windows, and any items are approximate and no responsibility is taken for any error, omission or mis-statement. Icons of items such as bathroom suites are representations only and may not look like the real items. Made with Made Snappy 360.

LOCAL AUTHORITY

Wakefield

TENURE

Leasehold

COUNCIL TAX BAND

C

VIEWINGS

By prior appointment only

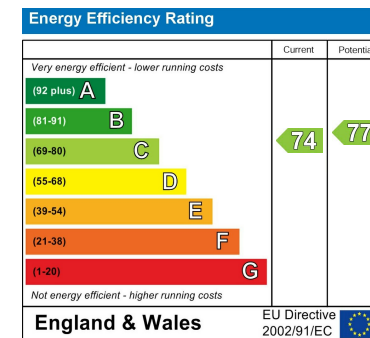

Agents Note: Whilst every care has been taken to prepare these particulars, they are for guidance purposes only. All measurements are approximate and are for general guidance purposes only and whilst every care has been taken to ensure their accuracy, they should not be relied upon and potential buyers/tenants are advised to recheck the measurements



OFFICE ADDRESS

37-39 George Street
Wakefield
West Yorkshire
WF1 1LX

OFFICE DETAILS

01924 200544
wakefield@hodsonsproperty.co.uk
www.hodsonsproperty.co.uk