



# HODSONS



OFFERS IN THE REGION OF

**£169,950**

**Shepstye Road**

Wakefield, WF4 5BE

## PROPERTY SUMMARY

We are pleased to bring to the open market, this good sized, TWO DOUBLE BEDROOM end terrace property, situated in the popular village of Horbury within easy reach of the M1 motorway network and Wakefield Centre.

2



1



1









GROUND FLOOR

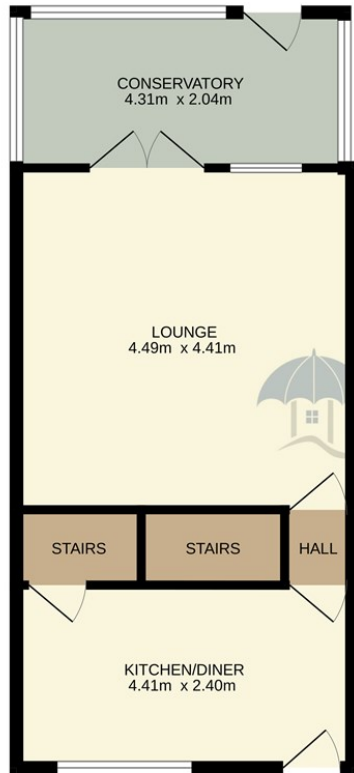

1ST FLOOR

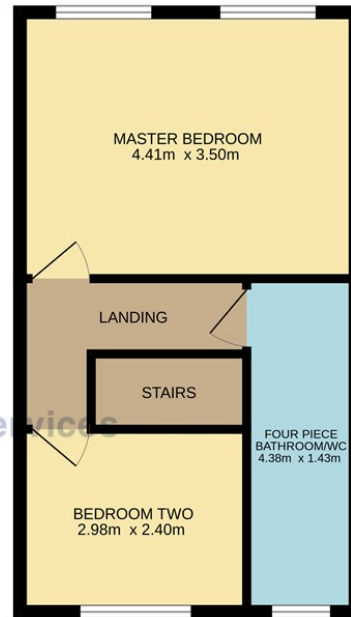

Whilst every attempt has been made to ensure the accuracy of the floorplan contained here, measurements of doors, windows, rooms and any other items are approximate and no responsibility is taken for any error, omission or mis-statement. This plan is for illustrative purposes only and should be used as such by any prospective purchaser. The services, systems and appliances shown have not been tested and no guarantee as to their operability or efficiency can be given.  
Made with Metropix ©2023

**LOCAL AUTHORITY**

Wakefield Metropolitan District council

**TENURE**

Freehold

**COUNCIL TAX BAND****VIEWINGS**

By prior appointment only

Energy Efficiency Rating		Current	Potential
<i>Very energy efficient - lower running costs</i>			
(82 plus) A			
(81-81) B			
(69-80) C			74
(55-68) D		53	
(39-54) E			
(21-38) F			
(1-20) G			
<i>Not energy efficient - higher running costs</i>			
<b>England &amp; Wales</b>		EU Directive 2002/91/EC	

Agents Note: Whilst every care has been taken to prepare these particulars, they are for guidance purposes only. All measurements are approximate and are for general guidance purposes only and whilst every care has been taken to ensure their accuracy, they should not be relied upon and potential buyers/tenants are advised to recheck the measurements

**OFFICE ADDRESS**

37-39 George Street  
Wakefield  
West Yorkshire  
WF1 1LX

**OFFICE DETAILS**

01924 200544  
wakefield@hodsonsproperty.co.uk  
www.hodsonsproperty.co.uk