



**16 SALMONS ROAD
CHESSINGTON
SURREY
KT9 2JE
OFFERS IN EXCESS OF
£600,000**

DOUBLE FRONTED DETACHED BUNGALOW

THREE BEDROOMS

TWO RECEPTION ROOMS

9'10 X 8'3 KITCHEN

MAJORITY DOUBLE GLAZED WINDOWS

WHITE BATHROOM SUITE

SOUTH WESTERLY FACING REAR GARDEN

GARAGE AND DRIVEWAY

UPDATING REQUIRED

NO FORWARD CHAIN

Ground Floor
106.5 sq.m. (1147 sq.ft.) approx.

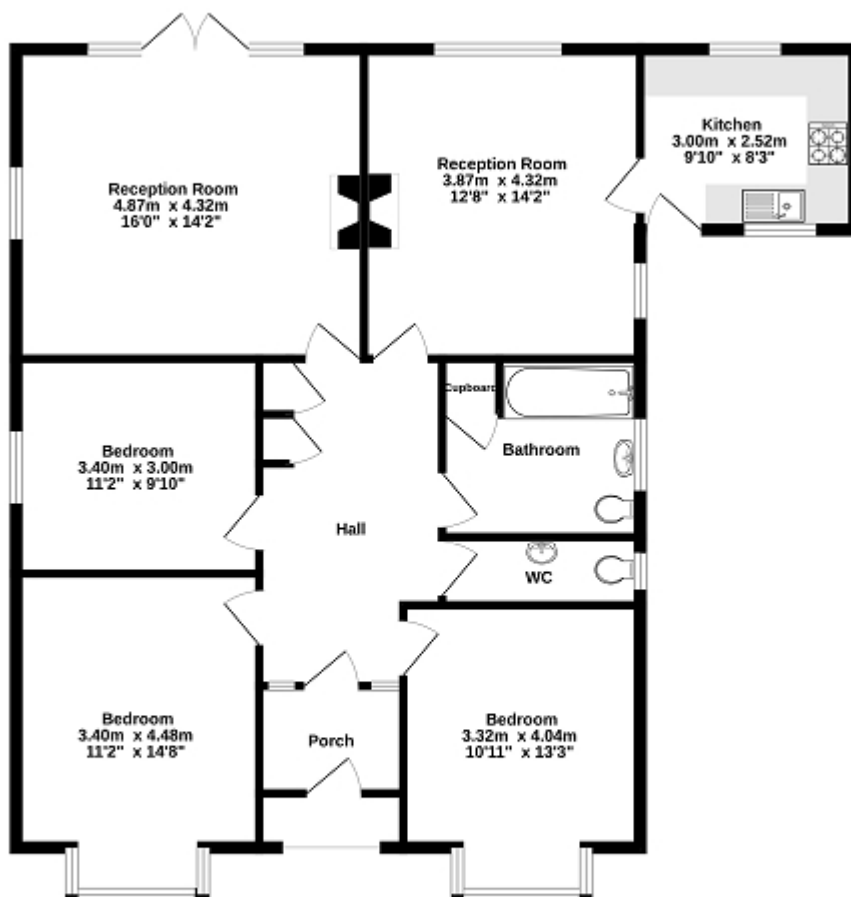

TOTAL FLOOR AREA : 106.5 sq.m. (1147 sq.ft.) approx.

While every attempt has been made to ensure the accuracy of the floorplan contained herein, measurements of doors, windows, rooms and any other items are approximate and no responsibility is taken for any error, omission or misstatement. This plan is for illustrative purposes only and should be used as such by any prospective purchaser. The services, systems and appliances shown have not been tested and no guarantee as to their operability or efficiency can be given.
Made with Metloq: ©2014



Energy Efficiency Rating

	Current	Potential
<i>Very energy efficient - lower running costs</i>		
(92+) A		
(81-91) B		81
(69-80) C		
(55-68) D		
(39-54) E	49	
(21-38) F		
(1-20) G		
<i>Not energy efficient - higher running costs</i>		
England, Scotland & Wales	EU Directive 2002/91/EC	

The energy efficiency rating is a measure of the overall efficiency of a home. The higher the rating the more energy efficient the home is and the lower the fuel bills will be.