



**2 LONGFELLOW ROAD
WORCESTER PARK
SURREY
KT4 8BB
OFFERS IN EXCESS OF
£450,000**

VICTORIAN END TERRACE HOUSE

25'1 X 13'9 LOUNGE DINING ROOM

9'4 X 8'3 MODERN KITCHEN

WHITE BATHROOM SUITE

DOUBLE GLAZED WINDOWS

GAS CENTRAL HEATING

25' SOUTH EASTERLY GARDEN

WELL PRESENTED

CLOSE TO TRANSPORT AND SHOPS

AN IDEAL FIRST TIME BUY

Ground Floor
39.3 sq.m. (423 sq.ft.) approx.

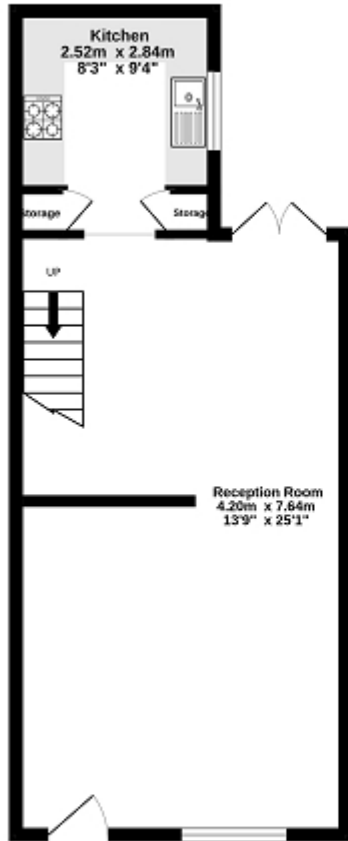

1st Floor
39.3 sq.m. (423 sq.ft.) approx.

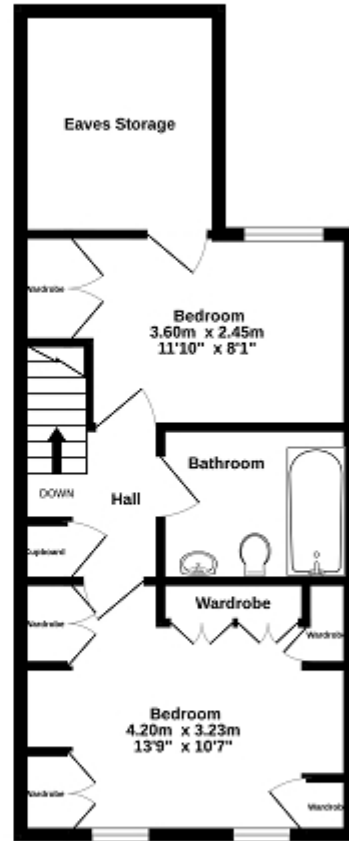

TOTAL FLOOR AREA : 78.6 sq.m. (846 sq.ft.) approx.

We'll every attempt has been made to ensure the accuracy of the floorplan contained here. Measurements of doors, windows, rooms and any other items are approximate and no responsibility is taken for any error, omission or mis-statement. This plan is for illustrative purposes only and should be used as such by any prospective purchaser. The services, systems and appliances shown have not been tested and no guarantee as to their operability or efficiency can be given.
Made with MetIQs 12/2014



Energy Efficiency Rating		
	Current	Potential
Very energy efficient - lower running costs		
(92+) A		
(81-91) B		82
(69-80) C		
(55-68) D	55	
(39-54) E		
(21-38) F		
(1-20) G		
Not energy efficient - higher running costs		
England, Scotland & Wales	EU Directive 2002/91/EC	

The energy efficiency rating is a measure of the overall efficiency of a home. The higher the rating the more energy efficient the home is and the lower the fuel bills will be.