

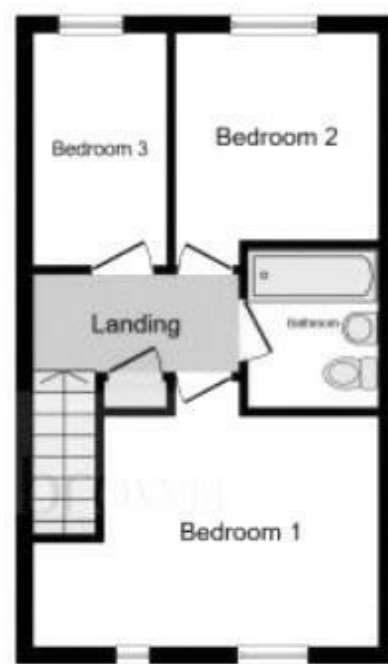

Ground Floor



First Floor



21 Morris Way, Needham Market, Ipswich, IP6 8TD

£235,000

This three bedroom terraced home is located in the town of Needham Market which includes ample living accommodation. The property includes, living room, kitchen, three bedrooms, family bathroom, gardens to front and rear, garage and off road parking.

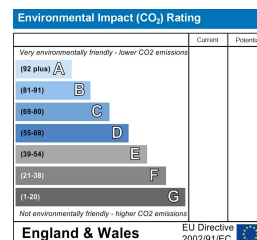
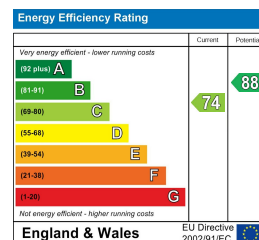

THE PROPERTY MISDESCRIPTIONS ACT 1991

The Agent has not tested any apparatus, equipment, fixtures and fittings or services and so cannot verify that they are in working order or fit for the purpose. A Buyer is advised to obtain verification from their Solicitor or Surveyor. References to the Tenure of a Property are based on information supplied by the Seller. The Agent has not had sight of the title documents. A Buyer is advised to obtain verification from their Solicitor. Items shown in photographs are NOT included unless specifically mentioned within the sales particulars. They may however be available by separate negotiation. Buyers must check the availability of any property and make an appointment to view before embarking on any journey to see a property.

DATA PROTECTION ACT 1998

Please note that all personal information provided by customers wishing to receive information and/or services from the estate agent will be processed by the estate agent for the purpose of providing services associated with the business of an estate agent and for the additional purposes set out in the privacy policy (copies available on request) but specifically excluding mailings or promotions by a third party. If you do not wish your personal information to be used for any of these purposes, please notify your estate agent.



21 Morris Way, Needham Market, Ipswich, IP6 8TD

NEEDHAM MARKET:

Needham Market lies in the heart of Mid Suffolk between the towns of Bury St Edmunds and Ipswich. Facilities include butchers, bakers, post office, co-op supermarket and a number of individual shops. Needham Market also has a rail station with mainline connections to Ipswich and Stowmarket where in turn there are main line services to London Liverpool Street. The town also has the Needham Lake conservation area with a number of countryside walks and the county town of Ipswich is just eight miles away with all the social, shopping and leisure facilities.

ENTRANCE HALL:

Door to...

LIVING ROOM: 14'4" x 12'0" (4.37 x 3.66)

Double glazed window to front, gas fireplace, stairs to first floor, radiator and door to...

KITCHEN: 14'4" x 11'8" (4.37 x 3.58)

Two double glazed windows to rear, door to rear garden, range of wall and base units, wooden effect work tops, stainless steel sink and drainer with mixer tap, integrated oven, hob and extractor, space for fridge freezer and washing machine, radiator and vinyl flooring.

FIRST FLOOR LANDING:

Access to loft, airing cupboard and doors to...

BEDROOM ONE: 11'3" x 9'4" (3.45 x 2.87)

Two double glazed windows to front and radiator.

BEDROOM TWO: 8'5" x 7'6" (2.59 x 2.29)

Double glazed window to rear and radiator.

BEDROOM THREE:

Double glazed window to rear and radiator.

BATHROOM:

Paneled bath with shower over, vanity hand wash basin, low level w/c, tiled walls and heated towel rail.

OUTSIDE:

REAR GARDEN:

Patio, shingle area, fenced surround and rear access gate.

FRONT GARDEN:

Storage shed and off road parking.

GARAGE:

Up and over door.

NEEDHAM MARKET:

Hamilton Smith Needham Market
01449 722 242
needham@hamilton-smith.com
www.hamilton-smith.com

