



Lindsey Court
Green Lanes, N

 2
Bedrooms

 1
Bathroom





****CHAIN FREE**** Addison Townsend are pleased to offer this lovely ground floor flat for sale in Palmers Green. The property is conveniently located within 0.3miles of Palmers Green Overground Station, as well as close proximity to local shops, restaurants pubs, local bus routes and is within easy reach of the A406 and the A10. The accommodation offers one reception room, two double bedrooms, kitchen, bathroom and storage. Further benefits include share of freehold, gas central heating, double glazed windows throughout, communal parking and communal gardens. The property is being offered chain free.



Approximate Gross Internal Area 671 sq ft – 62 sq m

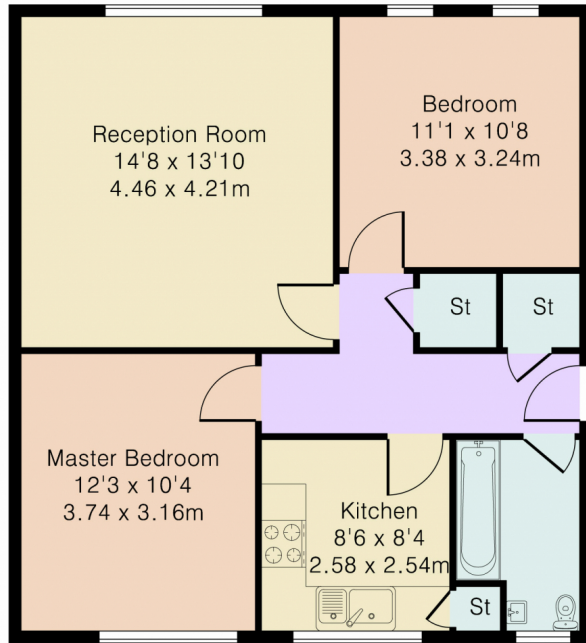

Ground Floor

Energy Efficiency Rating		
	Current	Potential
<i>Very energy efficient - lower running costs</i>		
(92+) A		
(81-91) B		
(69-80) C		77
(55-68) D	56	
(39-54) E		
(21-38) F		
(1-20) G		
<i>Not energy efficient - higher running costs</i>		
England, Scotland & Wales		EU Directive 2002/91/EC

Address: Green Lanes, N13



Although Pink Plan Ltd ensures the highest level of accuracy, measurements of doors, windows and rooms are approximate and no responsibility is taken for error, omission or misstatement. These plans are for representation purposes only as defined by RICS code of measuring practise. No guarantee is given on total square footage of the property within this plan. The figure icon is for initial guidance only and should not be relied on as a basis of valuation.

