



7 Munkman Close, Pottton, Sandy, Bedfordshire, SG19 2BY

£260,000

Modern three bedroom property located at the end of a small 18 month old gated development. Accommodation includes an integrated kitchen, L-shaped lounge/dining room, downstairs cloakroom, family bathroom, master bedroom with en-suite and two further bedrooms. Outside there is a fully enclosed rear garden while parking is provided via a car port and an additional parking space. Available chain free.



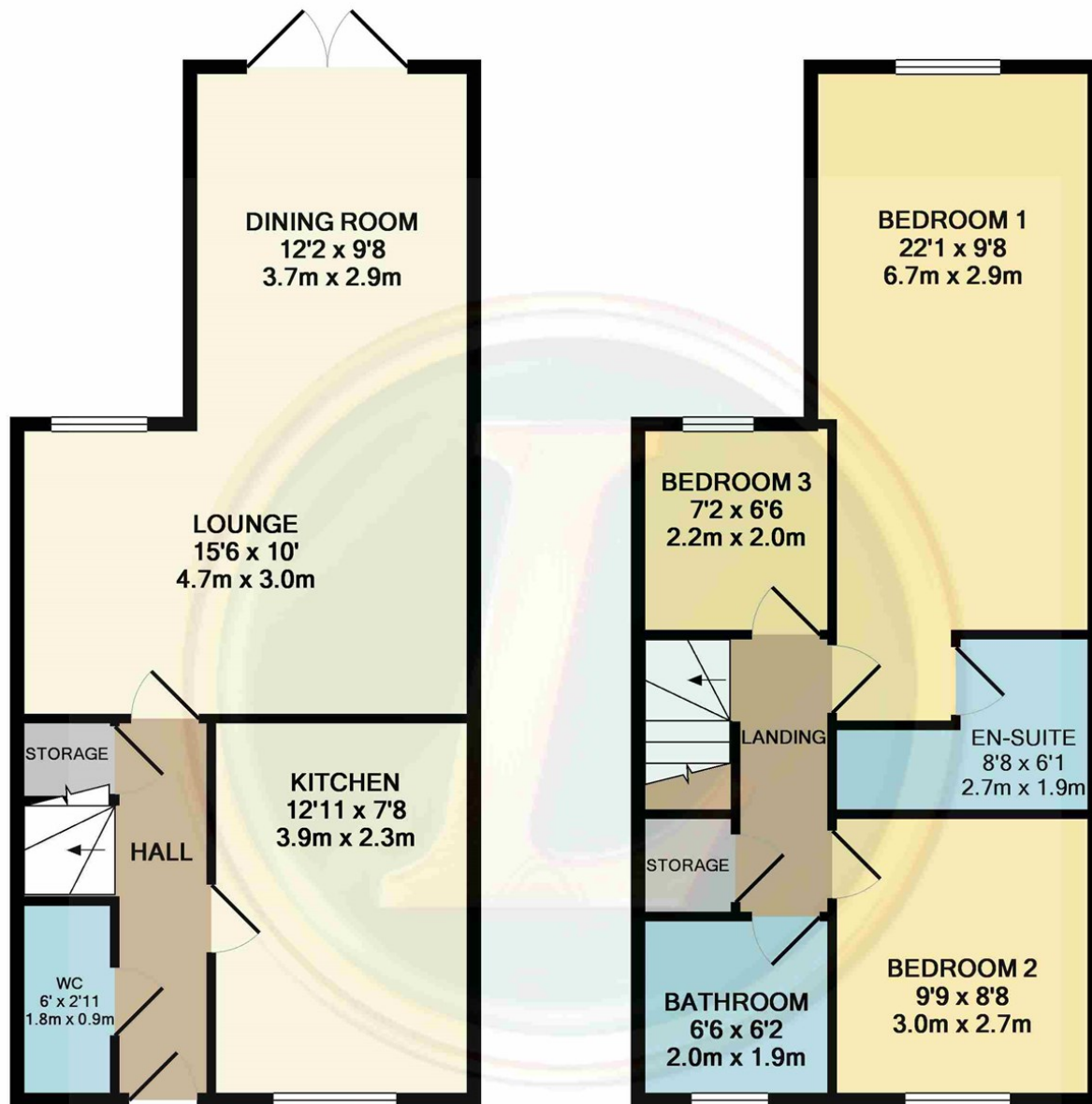

GROUND FLOOR
APPROX. FLOOR AREA 473 SQ.FT. (44.0 SQ.M.)

1ST FLOOR
APPROX. FLOOR AREA 473 SQ.FT. (44.0 SQ.M.)

TOTAL APPROX. FLOOR AREA 947 SQ.FT. (88.0 SQ.M.)
Measurements are approximate. Not to scale. Illustrative purposes only
Made with Metropix ©2018

- MODERN THREE BEDROOM FAMILY HOME
- ONLY 18 MONTHS OLD
- SMALL GATED DEVELOPMENT
- MASTER BEDROOM WITH EN-SUITE
- L-SHAPED LOUNGE/DINING ROOM
- INTEGRATED KITCHEN
- CAR PORT & PARKING SPACE
- NHBC WARRANTY
- AVAILABLE CHAIN FREE
- OPEN TO OFFERS

