

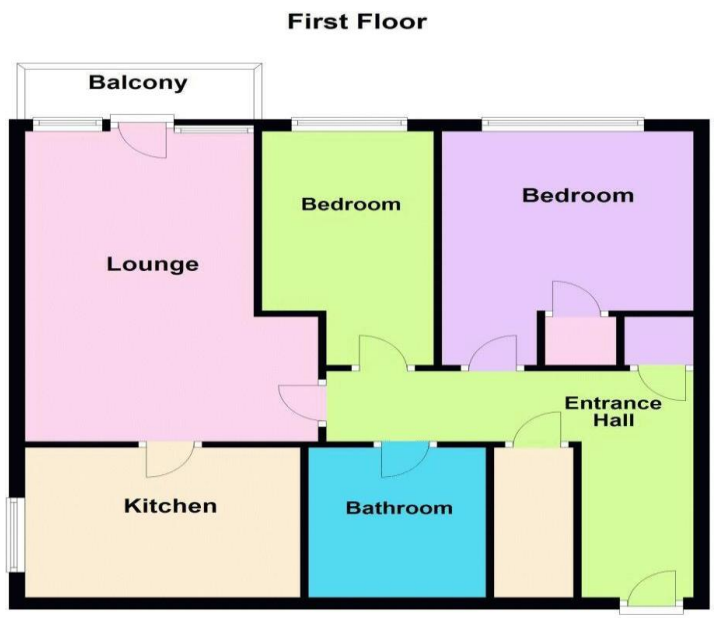

Picardy Road, Belvedere, DA17 5QR
Price Guide Price £240,000-£260,000



Score	Energy rating	Current	Potential
92+	A		
81-91	B		82 B
69-80	C	77 C	
55-68	D		
39-54	E		
21-38	F		
1-20	G		



This plan is for general layout guidance and may not be to scale. Plan produced using PlanUp.

To arrange an appointment to view this property or to book a valuation on your own property, contact hi residential for a professional Prompt and friendly service

experience the hi residential way

Property Details

Don't miss the opportunity to view this delightful two-bedroom, first-floor flat situated in a well-kept development in Upper Belvedere. Just a short stroll from Nuxley Village, this flat is ideally positioned for easy access to all local amenities including shops, restaurants, and cafes, as well as Belvedere train station, which offers convenient links for commuting. This purpose-built flat is beautifully maintained and offers a welcoming atmosphere the moment you step inside. The layout includes a spacious living area that provides a comfortable space for relaxation and social gatherings. Each of the two bedrooms is well-proportioned, offering ample space for personalization and rest. Viewing this property is essential to fully appreciate the thoughtful layout and the serene environment of the development. It's perfect for anyone from first-time buyers to small families, or investors looking for a property in a sought-after location. Contact us today to schedule your viewing and see firsthand the potential and comfort this lovely flat has to offer.

