

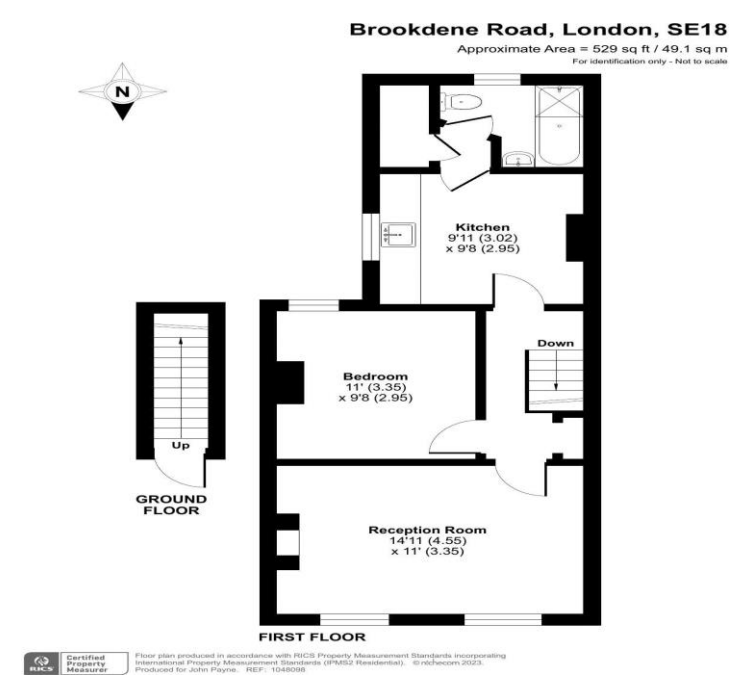

# Brookdene Road, Plumstead, SE18 1EW

## Price Guide Price £215,000 - £225,000

Score	Energy rating	Current	Potential
92+	A		
81-91	B		
69-80	C		
55-68	D	63 D	66 D
39-54	E		
21-38	F		
1-20	G		



*To arrange an appointment to view this property or to book a valuation on your own property, contact hi residential for a professional Prompt and friendly service*

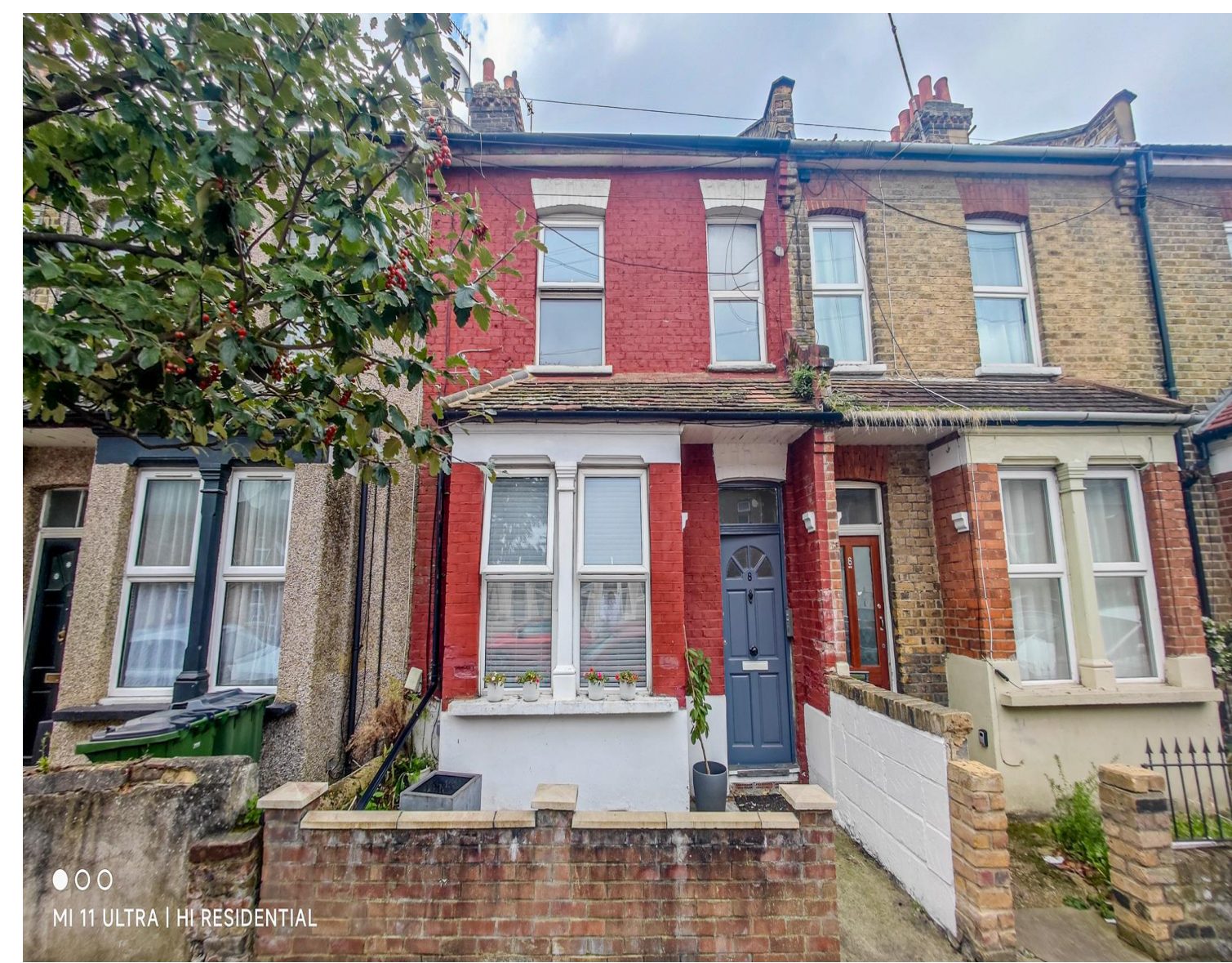



## experience the hi residential way

### Property Details

Guide Price £225,000 - £245,000. On offer is a beautifully presented one-bedroom flat situated on the first floor of a Victorian conversion, a property that also benefits from holding the freehold interest for the entire building. This flat is ideally located for easy access to local shops, bus routes, and Plumstead mainline station, making it perfect for commuters or anyone seeking convenience within a vibrant community. The interior of the flat is presented to a high standard, featuring a bright and airy 14ft lounge with double glazed windows to the front. These large windows ensure the room is bathed in natural light, enhancing the overall feel of space and comfort. The kitchen is well-fitted with modern amenities including a built-in oven, hob, and filter hood, alongside space for additional appliances. The bedroom is a comfortable double, boasting fitted carpets and a serene atmosphere for relaxation. Completing this appealing flat is a modern, fully tiled three-piece bathroom suite equipped with a shower above the bath. Key additional benefits of this flat include gas central heating and double glazing throughout, ensuring a warm and energy-efficient living space. Free street parking and an intercom entry system add layers of convenience and security. This flat represents an excellent opportunity, whether as a first-time purchase or a buy-to-let investment. Early viewing is highly recommended to fully appreciate the quality and potential of this delightful property. Contact us today to schedule your internal viewing and take the first step towards owning a piece of Victorian charm mixed with modern living.

