

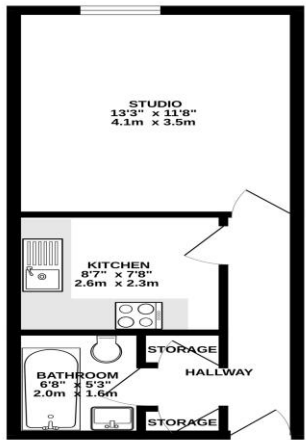

Score	Energy rating	Current	Potential
92+	A		
81-91	B		85 B
69-80	C		
55-68	D	65 D	
39-54	E		
21-38	F		
1-20	G		

FIRST FLOOR  
322 sq ft (29.9 sq m.) approx.



TOTAL FLOOR AREA: 322 sq ft (29.9 sq m.) approx.  
We do not warrant the accuracy of the information contained in this document. It is provided for information only and should not be relied upon for any purpose. It is not intended to constitute an offer of any financial product or service. It is not intended to be used as a basis for any investment decision. It is not intended to be used as a basis for any investment decision. It is not intended to be used as a basis for any investment decision.

*To arrange an appointment to view this property or to book a valuation on your own property, contact hi residential for a professional Prompt and friendly service*

Hi Residential Limited. Registered in England No. 10082765. Registered office: Heritage House, 34b North Cray Road, Bexley, United Kingdom, DA5 3LZ

24 Plumstead Common Road, SE183TN  
020 8316 6616  
sales@hi-residential.com  
lettings@hi-residential.com  
www.hi-residential.com



## Chadwick Way, Thamesmead, SE28 8NP

### Price £145,000 Leasehold



Hi Residential Limited. Registered in England No. 10082765. Registered office: Heritage House, 34b North Cray Road, Bexley, United Kingdom, DA5 3LZ

24 Plumstead Common Road, SE183TN  
020 8316 6616  
sales@hi-residential.com  
lettings@hi-residential.com  
www.hi-residential.com



# experience the hi residential way

## Property Details

Entrance Hall  
Lounge/Bedroom 13' 3" x 11' 8" (4.05m x 3.55m)  
Kitchen 8' 8" x 7' 8" (2.63m x 2.34m)  
Bathroom 6' 8" x 5' 3" (2.03m x 1.60m)  
Allocated Parking

Looking for a cozy studio flat in North Thamesmead? Look no further! Introducing Chadwick Way, a superb 1st floor studio flat situated off Crossways. This well-maintained property is in an excellent location, with convenient access to bus routes leading to Thamesmead Town Centre and public transport links connecting you to Plumstead and Abbey Wood railway stations. Perfectly suited for a comfortable lifestyle, Chadwick Way offers an entrance hall, spacious lounge/bedroom, fitted kitchen, and bathroom. With its prime location and easy accessibility to public transportation options, this flat is ideal for professionals or students who desire a convenient commute. Additionally, Chadwick Way is surrounded by great educational institutions, ensuring that your children have access to quality schools within the vicinity. Don't miss out on this amazing opportunity! Contact us today to arrange a viewing and secure your new home at Chadwick Way. #ChadwickWay #NorthThamesmead #StudioFlat #ForRent #ConvenientLocation #GreatTransportLinks #QualitySchools

