



393 Main Road, Chelmsford, CM1 7EJ

£375,000

\*\* NO ONWARD CHAIN - NEEDS MODERNISATION - AMPLE SCOPE FOR LOFT CONVERSION AND EXTENSION TO REAR (stpp) - FARMLAND VIEWS TO FRONT - CLOSE TO BROOMFIELD HOSPITAL - EXCELLENT BUS SERVICES IN TO CHELMSFORD CITY CENTRE  
\*\* A TWO BEDROOM SEMI DETACHED BUNGALOW with sitting/dining room, kitchen (needs updating) and shower room. The property has upvc double glazing and gas radiator heating.



#### LOCALITY INFORMATION

The bungalow is located to the north side of Chelmsford with frequent bus services in to the city centre with a wide variety of shopping and recreational facilities available and the mainline railway station to London Liverpool Street. The property is also situated near Broomfield hospital.

#### FARMLAND VIEWS TO FRONT

#### ACCOMMODATION COMPRISES

Upvc entrance door with attractive stained leaded light window to entrance hall.

#### ENTRANCE HALL



Radiator, picture rails, doors to sitting/dining room.

**SITTING/DINING ROOM** 17'1 x 13 maximum (5.21m x 3.96m maximum)



Feature fireplace, two radiators, upvc double glazed window to rear, door to kitchen.

#### FURTHER VIEW



**KITCHEN** (needs refitting) 10'4 maximum x 6'7 (3.15m maximum x 2.01m)



Range of worktops with drawers and cupboards below, wall mounted cabinets, Stoves electric four ring ceramic hob, Neff oven/grill and microwave, upvc double glazed window to rear and frosted window to side, built in cupboard housing the Glow Worm gas boiler, upvc part frosted double glazed door to side.

ADDITIONAL VIEW



FITTED WARDROBES AND DRAWER UNITS



BEDROOM ONE 14 maximum x 9'10 (4.27m maximum x 3.00m)



Radiator, range of fitted wardrobes and drawer units, upvc double glazed bay window to front with farmlands across the road.

BEDROOM TWO 8'7 x 7'8 (2.62m x 2.34m)



Radiator, upvc double glazed bay window to front with farmlands across the road.



## SHOWER ROOM



White suite with low level wc, vanity wash hand basin, walk in double width shower unit, radiator, tiled walls, frosted upvc double glazed window to side.

## FURTHER VIEW



## FRONT GARDEN

Laid to lawn with various shrubs.

## LONG REAR GARDEN



There is a large brick paved patio to the rear elevation and leads on to the lower garden area which is laid to lawn with fenced boundaries.

## LOWER GARDEN AREA



REAR ELEVATION



AMPLE DRIVEWAY PARKING AND DETACHED GARAGE



There is a long driveway providing plenty of off road parking which leads to the side of the property and the detached garage beyond the rear elevation.

FARMLAND VIEWS TO FRONT



**Outbuilding**



**Outbuilding**

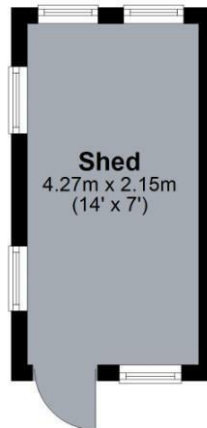

**Ground Floor**

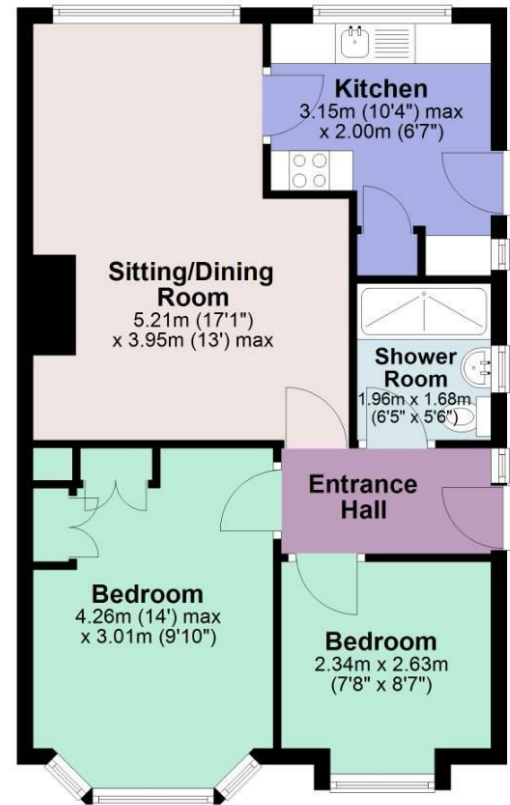

Total area: approx. 75.2 sq. metres (809.3 sq. feet)

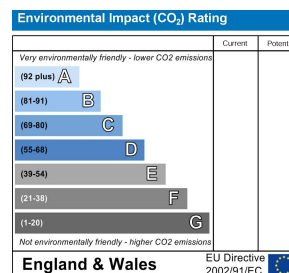
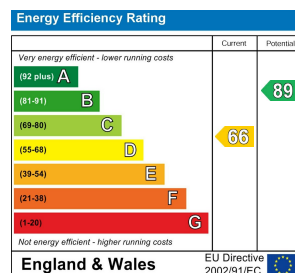

DISCLAIMER: You may download, store and use the material for your own personal use and research. You may not republish, retransmit, redistribute or otherwise make the material available to any party or make the same available on any website, online service or bulletin board of your own or of any other party or make the same available in hard copy or in any other media without the website owner's express prior written consent. At Leonard Gray, we aim to ensure our sales particulars are accurate and reliable. However, they do not constitute any offer or contract, nor are they to be taken as statements or representations of fact. No tests have been carried out by us in respect of services, systems or appliances contained in the specification. No guarantee as to their operating ability or efficiency is given. All measurements are a guide only and, therefore, are not necessarily precise. Fixtures and fittings, apart from those mentioned in the particulars, are to be agreed with the seller. Some particulars, please note, may also be awaiting the seller's approval. If clarification or further information is required, please contact us.