



# FIELDHOUSE

T: +44 (0)20 7013 0770  
F: +44 (0)20 7731 1964  
PROPERTY@FHRES.CO.UK  
FHRES.CO.UK



## Flat 5 Blake Court, 223-229 Rye Lane, Peckham, London, SE15 4TP

BRAND NEW THREE-BEDROOM APARTMENT IDEALLY LOCATED IN PECKHAM TOWN CENTRE. This beautifully presented, unfurnished apartment is finished to a high standard throughout.

The apartment comprises a light and spacious open-plan kitchen and living room with terrace, three double bedrooms and a bathroom with shower over bath. This property also benefits from gas central heating. Available Immediately!

Minimum Length of Tenancy: 12 Months  
Council Tax: Southwark Borough Council  
Council Tax Band: TBC

- BRAND NEW APARTMENT
- THREE DOUBLE BEDROOM
- OPEN PLAN KITCHEN LIVING ROOM
- UNFURNISHED
- IDEALLY LOCATED ON RYE LANE
- AVAILABLE IMMEDIATELY

**£3,300 \***

Rye Lane

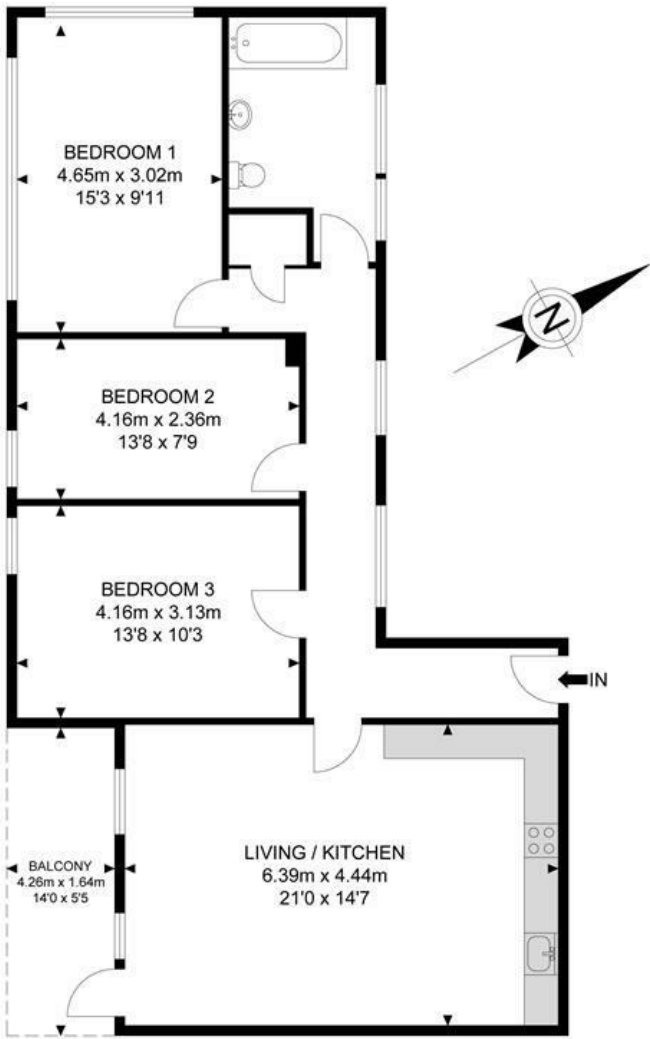

3rd Floor



APPROX. GROSS INTERNAL FLOOR AREA 931.07 SQ FT / 86.50 SQM  
APPROX. GROSS EXTERNAL FLOOR AREA 77.50 SQ FT / 7.20 SQM

Whilst every attempt has been made to ensure the accuracy of the floor plan contained here, measurements of doors, windows, rooms and any other items are approximated and no responsibility is taken for any error, omission or mis-statement. This plan is for illustrative purposes only and should be used as such by any prospective purchaser. The service, system and appliances shown have not been tested and no guarantee as to their operability or efficiency can be given.

© SpacePhoto

Photography and Floor Plan

Energy Efficiency Rating		
	Current	Potential
Very energy efficient - lower running costs		
(92 plus) A	86	
(81-91) B		
(69-80) C		
(55-68) D		
(39-54) E		
(21-38) F		
(1-20) G		
Not energy efficient - higher running costs		
England & Wales		
EU Directive 2002/91/EC		

Environmental Impact (CO <sub>2</sub> ) Rating		
	Current	Potential
Very environmentally friendly - lower CO <sub>2</sub> emissions		
(92 plus) A		
(81-91) B		
(69-80) C		
(55-68) D		
(39-54) E		
(21-38) F		
(1-20) G		
Not environmentally friendly - higher CO <sub>2</sub> emissions		
England & Wales		
EU Directive 2002/91/EC		



**FIELDHOUSE RESIDENTIAL LIMITED**  
Registered Address: 94 Wandsworth Bridge Road, London SW6 2TF  
Registered in England No. 5097508 **VAT No. GB 839 5267 87**

