



FIELDHOUSE

T: +44 (0)20 7013 0770
F: +44 (0)20 7731 1964
PROPERTY@FHRES.CO.UK
FHRES.CO.UK



Flat 2, 51a Tooting High Street, Tooting, London, SW17 0SP

UNFURNISHED THREE DOUBLE BEDROOM SECOND AND THIRD FLOOR FLAT situated above commercial premises and within close proximity of Tooting Broadway Station. The property consists of open plan kitchen living room, three double bedrooms and shower room. The property also benefits from double glazing and gas central heating. Available Immediately.

PLEASE NOTE THERE IS NO PARKING AVAILABLE WITH THIS PROPERTY.

Minimum Length of Tenancy: 12 Months
Council Tax: Wandsworth Borough Council
Council Tax Band: C

- THREE DOUBLE BEDROOMS
- OPEN PLAN LIVING ROOM AND KITCHEN
- CENTRAL LOCATION
- AVAILABLE IMMEDIATELY

£2,500 PCM*

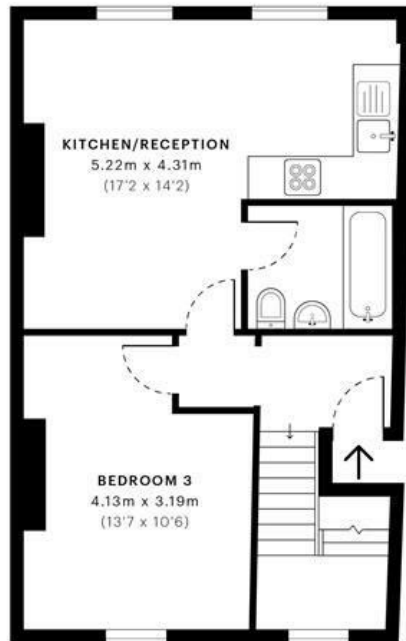

— Ground Floor

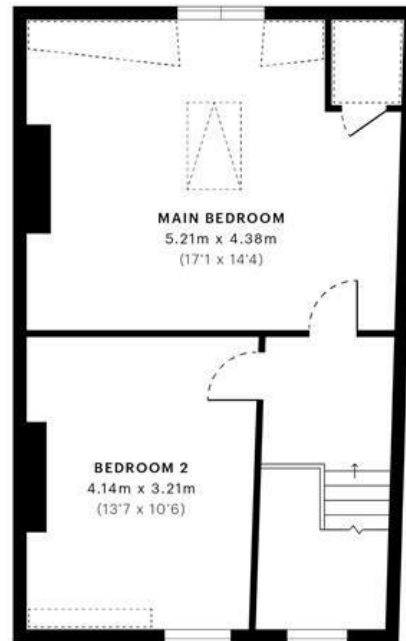

— First Floor



87.21 sqm / 938.72 sqft



78.48 sqm / 844.75 sqft



0.00 sqm / 0.00 sqft



3.40 sqm / 36.60 sqft



Spec verified floor plans are produced in accordance with Royal Institution of Chartered Surveyors' Property Measurement Standards. Plans and gardens are illustrative only and excluded from all area calculations. Due to rounding, numbers may not add up precisely. All measurements shown for the individual room lengths and widths are the maximum points of measurements captured in the scan.

PLAN 00: RECEPTIONAL 87.21 sqm / 938.72 sqft
PLAN 01: RECEPTIONAL 78.48 sqm / 844.75 sqft

SPEC ID: 5635d7698f02b4d0dd4952717

| Energy Efficiency Rating | | |
|---|-------------------------|-----------|
| | Current | Potential |
| Very energy efficient - lower running costs | | |
| (92 plus) A | | |
| (81-91) B | | |
| (69-80) C | | |
| (55-68) D | | |
| (39-54) E | | |
| (21-38) F | | |
| (1-20) G | | |
| Not energy efficient - higher running costs | | |
| England & Wales | EU Directive 2002/91/EC | 75 |

| Environmental Impact (CO ₂) Rating | | |
|---|-------------------------|-----------|
| | Current | Potential |
| Very environmentally friendly - lower CO ₂ emissions | | |
| (92 plus) A | | |
| (81-91) B | | |
| (69-80) C | | |
| (55-68) D | | |
| (39-54) E | | |
| (21-38) F | | |
| (1-20) G | | |
| Not environmentally friendly - higher CO ₂ emissions | | |
| England & Wales | EU Directive 2002/91/EC | |

