

EST. 1999

WILLIAMS AND DONOVAN

EXCELLENCE IN ESTATE AGENCY

The Close, The Dome Village, Hockley, SS5 5LX



Guide Price £100,000 - £120,000

Situated on the popular Dome Village for the over 50's is this recently refurbished one bedroom park with own rear garden and driveway.

OFFERED WITH NO ONWARD CHAIN.

Viewing advised. Council Tax Band: A. Our Ref: 20218.

1 Woodlands Parade, Main Road, Hockley, Essex SS5 4QU

sales@wdhockley.com | sales@wdbenfleet.com | lettings@wdlets.com
01702 200666 | www.williamsanddonovan.com



Accommodation comprises:

Entrance via double glazed entrance door to entrance hall.

ENTRANCE HALL

Wood effect flooring. Door to shower room. Door to bedroom.

BEDROOM 11' 8" x 8' 8" (3.56m x 2.64m)

Double glazed window to front aspect. Radiator. Wood effect flooring. Plastered ceiling. Door to shower room.



SHOWER ROOM

A three piece suite comprising corner shower cubicle with electric shower, pedestal wash hand basin with chrome mixer taps and close coupled wc. Radiator. Tiled walls. Wood effect flooring. Plastered ceiling with inset spotlighting.



KITCHEN 11' 8" x 7' 10" (3.56m x 2.39m)

Double glazed window to front and rear aspects. A range of base and eye level units incorporating roll edge work surface with inset one and a half stainless steel sink drainer unit. Space for freestanding cooker. Space and plumbing for washing machine. Wall mounted boiler. Tiled splash backs. Door to lounge.



LOUNGE 11' 8" x 10' 6" (3.56m x 3.2m)

Double glazed bay window to front aspect. Double glazed windows to side aspect. Double glazed door providing access to garden. Radiator. Wood effect flooring. Plastered ceiling.



EXTERIOR.

There is a **SECLUDED GARDEN** to the rear of the property with patio area. Laid to lawn. **DRIVEWAY** to side providing off street parking for one vehicle.



Agents Note:

The vendors advise that the property has recently been fully reinsulated with certification available.

*There is a maximum two pets permitted.
Ground rent : To be confirmed.*



GROUND FLOOR
365 sq.ft. (34.0 sq.m.) approx.

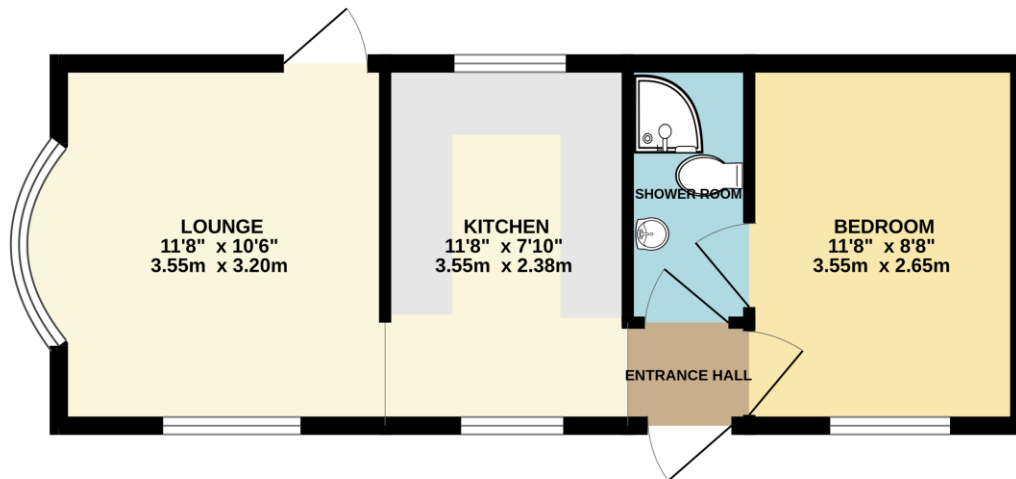

TOTAL FLOOR AREA: 365 sq.ft. (34.0 sq.m.) approx.
Whilst every attempt has been made to ensure the accuracy of the floorplan contained here, measurements of doors, windows, rooms and any other items are approximate and no responsibility is taken for any error, omission or mis-statement. This plan is for illustrative purposes only and should be used as such by any prospective purchaser. The services, systems and appliances shown have not been tested and no guarantee as to their operability or efficiency can be given.
Made with Metropix ©2025

Consumer Protection from Unfair Trading Regulations 2008.

The Agent has not tested any apparatus, equipment, fixtures and fittings or services and so cannot verify that they are in working order or fit for the purpose. A Buyer is advised to obtain verification from their Solicitor or Surveyor. References to the Tenure of a Property are based on information supplied by the Seller. The Agent has not had sight of the title documents. A Buyer is advised to obtain verification from their Solicitor. Items shown in photographs are NOT included unless specifically mentioned within the sales particulars. They may however be available by separate negotiation. Buyers must check the availability of any property and make an appointment to view before embarking on any journey to see a property.