



Rose Cottage, 99 Trap Lane, Sheffield, S11 7RF



# Rose Cottage, 99 Trap Lane Sheffield, S11 7RF

## Description

A spacious 3/4 bed detached bungalow with versatile accommodation on the ground floor and an occasional loft room which is currently used as a large double bedroom. The property has been extended to the rear giving excellent proportions which are particularly evident in the lovely breakfast kitchen and the south westerly facing garden is also sure to appeal. Bents Green is a very desirable locality and Trap Lane is situated a short stroll away from the run of amenities on Ringinglow Road including regular transport links that can whisk you into town in under 20 minutes. At the end of Trap Lane there is pedestrian access out to the walking trails around the Mayfield Valley and a short drive up the hill has you in the beautiful surrounding countryside of the Peak District in less than 5 minutes.

- Two double bedrooms
- Versatile third bedroom/home office
- Bayed sitting room with stripped and stained floorboards
- Breakfast room/Morning room overlooking the sunny gardens
- Extended breakfast kitchen with pantry, timber work tops and a Belfast sink
- Main bathroom and a second W.C
- Occasional loft room used as a double bedroom (ideal for guests or as a hobby room)
- Reception lobby and hall
- Lovely South, South Westerly facing gardens enclosed by hedgerows
- Block paved off road parking and a decent garage









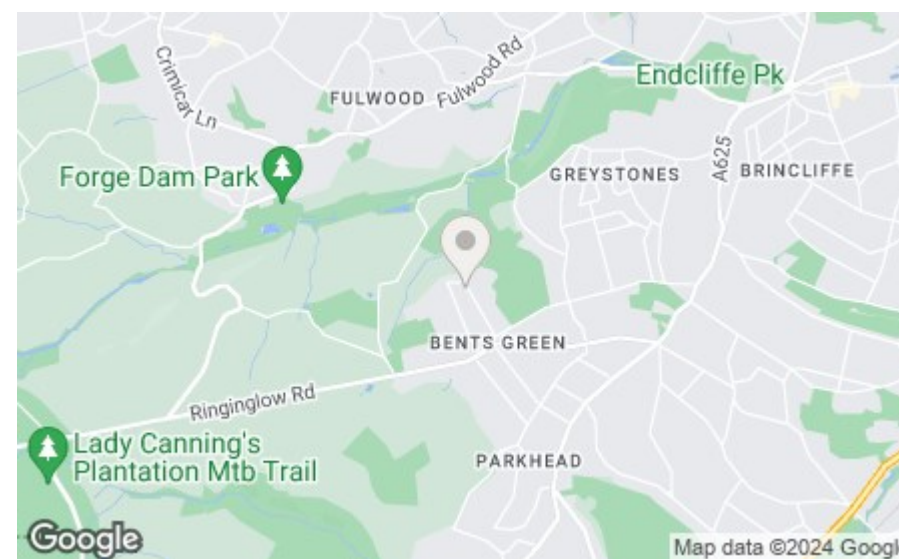
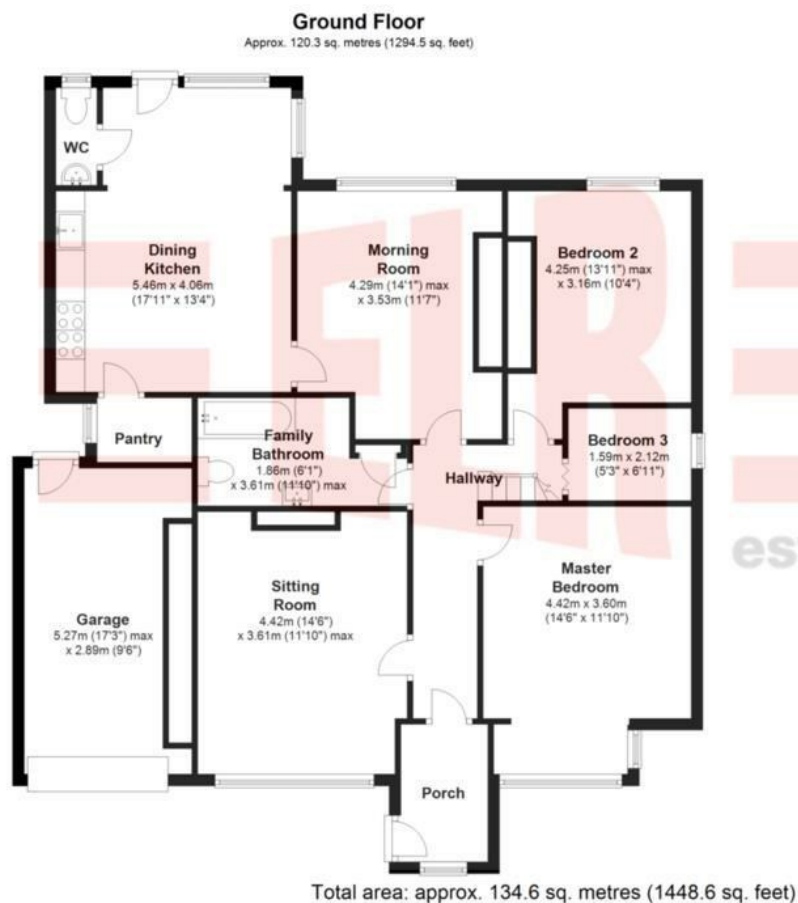

**Bakewell**  
3 Royal Oak Place  
Matlock Street  
Bakewell DE45 1HD  
T: 01629 700699  
E: bakewell@elr.co.uk

**Banner Cross**  
888 Ecclesall Road  
Banner Cross  
Sheffield S11 8TP  
T: 01142 683388  
E: bannercross@elr.co.uk

**Dore**  
33 Townhead Road  
Sheffield  
S17 3GD  
T: 0114 2362420  
E: dore@elr.co.uk

**Hathersage**  
Main Road, Hathersage  
Hope Valley  
Derbyshire S32 1BB  
T: 01433 651888  
E: peakdistrict@elr.co.uk

**Rotherham**  
149 Bawtry Road  
Wickersley  
Rotherham S66 2BW  
T: 01709 917676  
E: wickersley@elr.co.uk

**EADON  
LOCKWOOD  
& RIDDLE**  
ESTD 1840