



37 Sheldon Road

Nether Edge Village, Sheffield, S7 1GT

Price Guide £250,000

37 Sheldon Road



Description

*** CASH BUYERS ONLY***

GUIDE PRICE £250,000 to £260,000. An opportunity to continue the recent renovations that have been started at this deceptively spacious, five bedroom family home. The location, in the middle of Nether Edge Village, couldn't be more on trend. 'The Village' is often referred to as the most fashionable place to live in the Steel City, with local restaurants, cafes, bars and pubs combining with broad, tree lined avenues creating a truly unique feel and an amazing place to live. This large villa is in need of renovations and as such is available to CASH BUYERS ONLY.

- Five bedrooms.
- Sitting room with bay window.
- Offshot kitchen with access to the garden.
- Ground floor utility room.
- CASH BUYERS ONLY.
- Three bathrooms (one ensuite).
- Dining room.
- Rear garden.
- No onward chain.
- Freehold, Council Tax Band currently exempt as it used to be three flats, UPVC double glazing.

Floor Plan

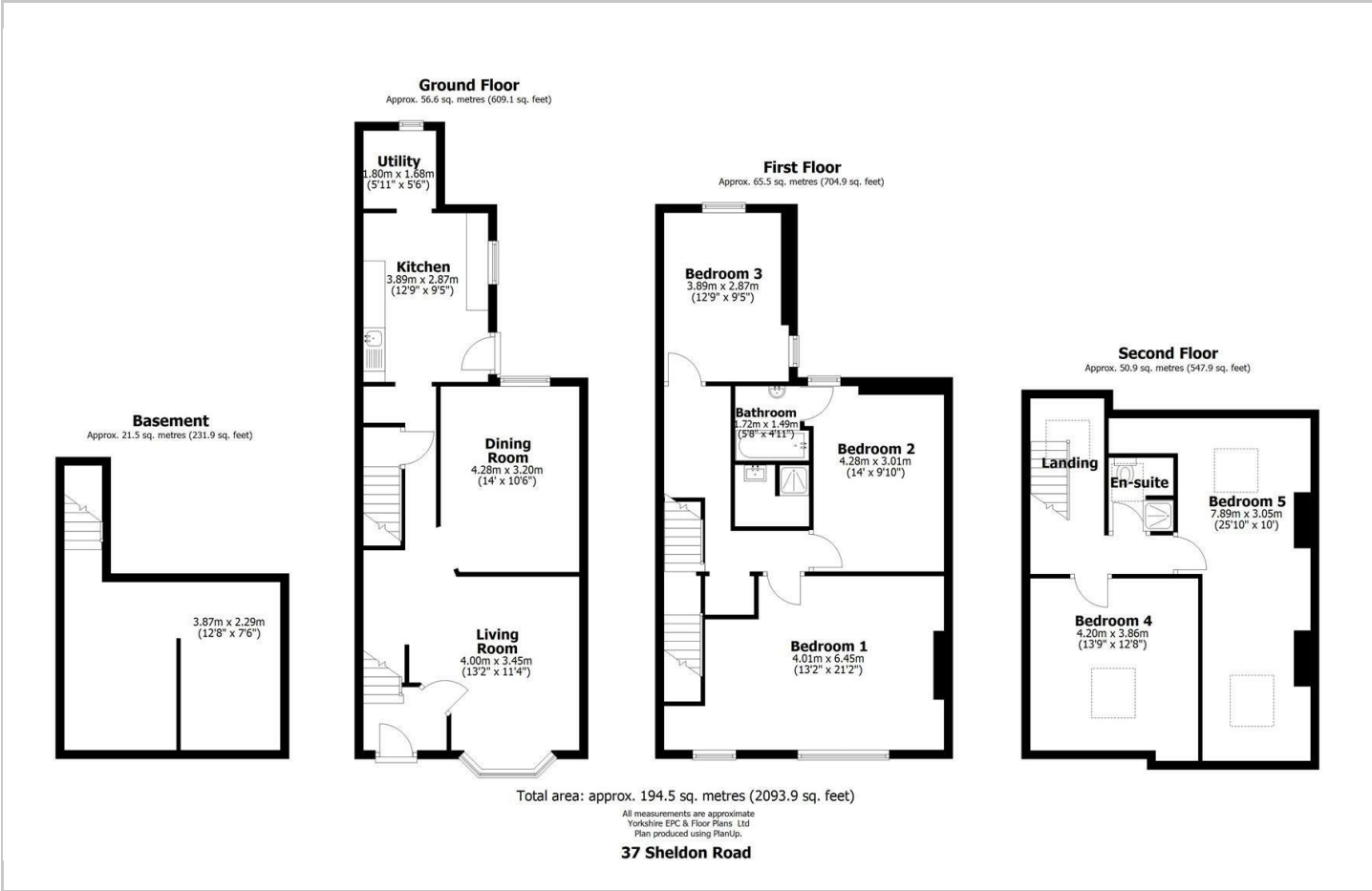

Area Map

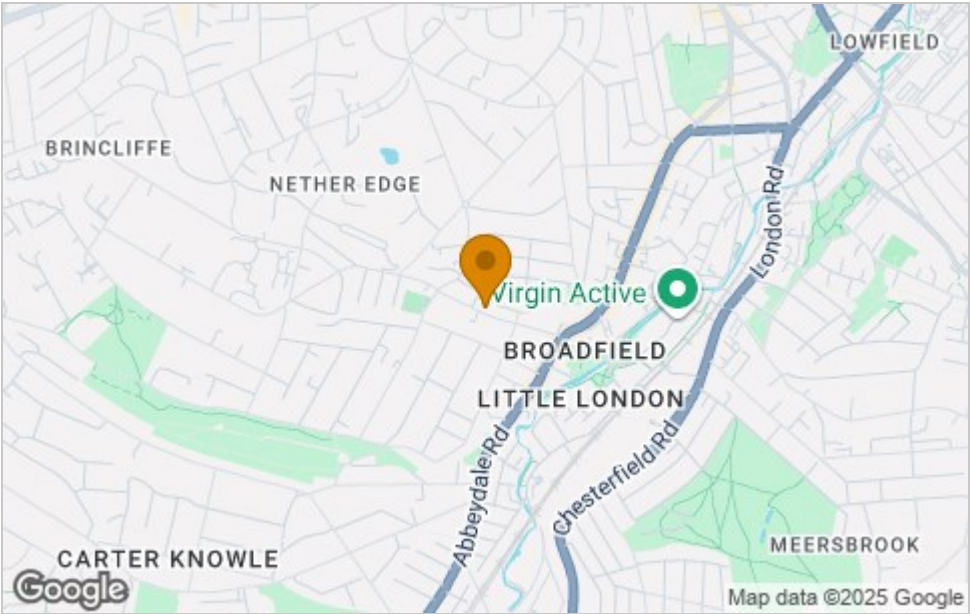

Viewing

Please contact our ELR Banner Cross Office on 0114 268 3388 if you wish to arrange a viewing appointment for this property or require further information.

These particulars, whilst believed to be accurate are set out as a general outline only for guidance and do not constitute any part of an offer or contract. Intending purchasers should not rely on them as statements of representation of fact, but must satisfy themselves by inspection or otherwise as to their accuracy. No person in this firms employment has the authority to make or give any representation or warranty in respect of the property.

Energy Efficiency Graph

