



Apt 322a Print Works, 85 Headford Street, Sheffield, S3 7WQ

Apt 322a Print Works, 85 Headford Street

Sheffield, S3 7WQ

Description

A stylish studio apartment that forms part of this modern development that was constructed in 2016. These studios will appeal to a broad range of buyer including the investor market who will be encouraged by the great yields they can get from buying at £50,000 and renting back out for approx £750 pcm. The location is ideal for people who work in the city centre, everything can be found close by, within a short walk with the lower, cosmopolitan part of Ecclesall Road being accessed just over the ring road. The property is located just down the road from Devonshire Green which is a fabulous place in the warmer months of the year and hosts some of the events during the Tramlines Festival. This super development includes residents laundry facilities and a good gymnasium and this property is available with no onward chain.

- Studio apartment.
- No onward chain.
- Superb rental returns of approx £750 pcm.
- 186 years left on the lease (ground rents and service charges to be confirmed)
- Council Tax Band A.
- Modern fixtures and fittings in all the right places.
- Residents Gymnasium with modern equipment.
- Residents laundry room.
- Superb location in the city centre, close to the universities and hospitals.
- Excellent EPC rating of C78.





Third Floor

Approx. 15.6 sq. metres (167.9 sq. feet)

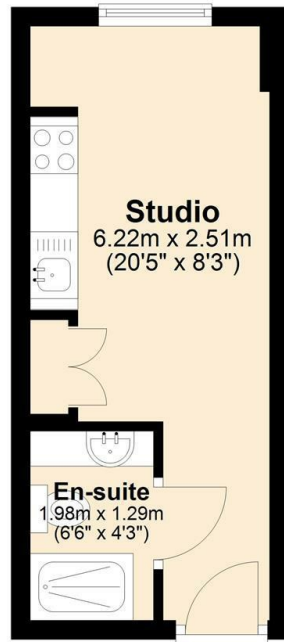

Total area: approx. 15.6 sq. metres (167.9 sq. feet)

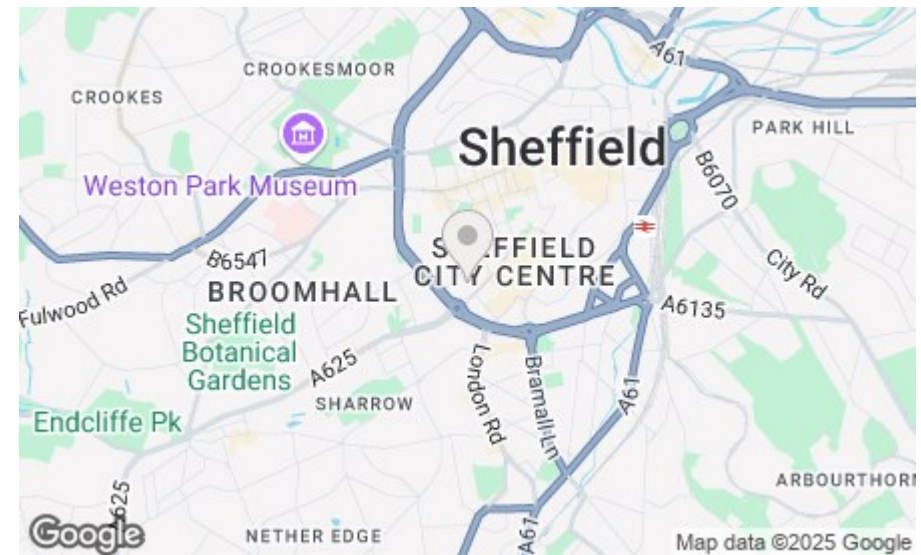

Bakewell
3 Royal Oak Place
Matlock Street
Bakewell DE45 1HD
T: 01629 700699
E: bakewell@elr.co.uk

Banner Cross
888 Ecclesall Road
Banner Cross
Sheffield S11 8TP
T: 01142 683388
E: bannercross@elr.co.uk

Dore
33 Townhead Road
Sheffield
S17 3GD
T: 0114 2362420
E: dore@elr.co.uk

Hathersage
Main Road, Hathersage
Hope Valley
Derbyshire S32 1BB
T: 01433 651888
E: peakdistrict@elr.co.uk

Rotherham
149 Bawtry Road
Wickersley
Rotherham S66 2BW
T: 01709 917676
E: wickersley@elr.co.uk

**EADON
LOCKWOOD
& RIDDLE**
ESTD 1840