



28, Club Street, Sheffield, S11 8DE

28, Club Street

Sheffield, S11 8DE

Description

A spacious three bedroom terraced home with accommodation laid out over three floors. The property is situated close to excellent local amenities and within a short walk of Sheffield city centre. It will be ideal for first time buyers wishing to get on the property ladder and investors looking for a buy to let in a popular/lettable area. The property has a modern shower room and a pleasing feel throughout, with generous proportions in the dining kitchen and two of the three bedrooms. Next door has added a dormer window to the loft which suggests this may also be possible here to perhaps add a second bathroom or split the loft to form a valuable fourth bedroom if required (subject to regs). This Freehold property is available with no onward chain and an early viewing is very much advised.

- No onward chain.
- Three bedrooms including two good doubles.
- Potential buy to let or of interest to first time buyers.
- Popular location close to town, the universities and excellent facilities around both Londo Road and Ecclesall Road.
- Modern shower room with contemporary tiling and sanitary ware. The property was re wired in 2009.
- Sitting room at the front with fireplace.
- Dining kitchen with French windows to the garden and part stripped and stained floorboards.
- Freehold and Council Tax Band A.
- Enclosed rear garden.
- Gas central heating, double glazed (majority UPVC) and EPC rated E49.





Ground Floor

Approx. 30.1 sq. metres (324.4 sq. feet)

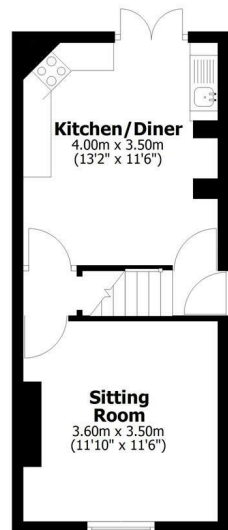

First Floor

Approx. 34.4 sq. metres (370.4 sq. feet)

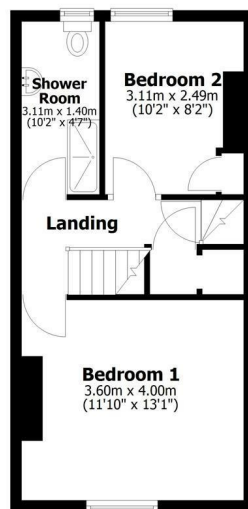

Second Floor

Approx. 23.0 sq. metres (248.0 sq. feet)



Total area: approx. 87.6 sq. metres (942.9 sq. feet)

All measurements are approximate
Yorkshire EPC & Floor Plans Ltd
Plan produced using PlanUp.

28, Club Street



Bakewell
3 Royal Oak Place
Matlock Street
Bakewell DE45 1HD
T: 01629 700699
E: bakewell@elr.co.uk

Banner Cross
888 Ecclesall Road
Banner Cross
Sheffield S11 8TP
T: 01142 683388
E: bannercross@elr.co.uk

Dore
33 Townhead Road
Sheffield
S17 3GD
T: 0114 2362420
E: dore@elr.co.uk

Hathersage
Main Road, Hathersage
Hope Valley
Derbyshire S32 1BB
T: 01433 651888
E: peakdistrict@elr.co.uk

Rotherham
149 Bawtry Road
Wickersley
Rotherham S66 2BW
T: 01709 917676
E: wickersley@elr.co.uk

**EADON
LOCKWOOD
& RIDDLE**
ESTD 1840

All rooms have been measured with electronic laser and are approximate measurements only. None of the services to the above property have been tested by ourselves, and we cannot guarantee that the installations described in the details are in perfect working order. Eadon Lockwood & Riddle for themselves, and for the vendors or lessors, produce these brochures in good faith, and are a guideline only. They do not constitute any part of a contract and are correct to the best of our knowledge at the time of going to press.