



# 19, Moorthorpe Green

Sheffield, S20 6RS

## Description

A spacious garden flat that has its own private entrance, private garden and allocated, off road parking. The end of cul sac location is ideal and the property is conveniently situated, close to both bus and tram links that provide access into town or the surrounding areas of Hackenthorpe, Crystal Peaks and Owlthorpe which all have an excellent range of amenities. This lovely flat will be perfect for anyone looking to downsize or alternatively start their journey on the property ladder, being available with no onward chain, UPVC double glazing and gas central heating.

- Spacious garden flat.
- Private rear garden.
- Two double bedrooms.
- Modern bathroom.
- Fitted kitchen.
- Large living room with defined seating and dining areas.
- Allocated off road parking for one car.
- No onward chain.
- Council Tax Ban A and EPC rating C78.
- 125 year lease from 1983 @ an annual ground rent of £20.





GROUND FLOOR FLAT

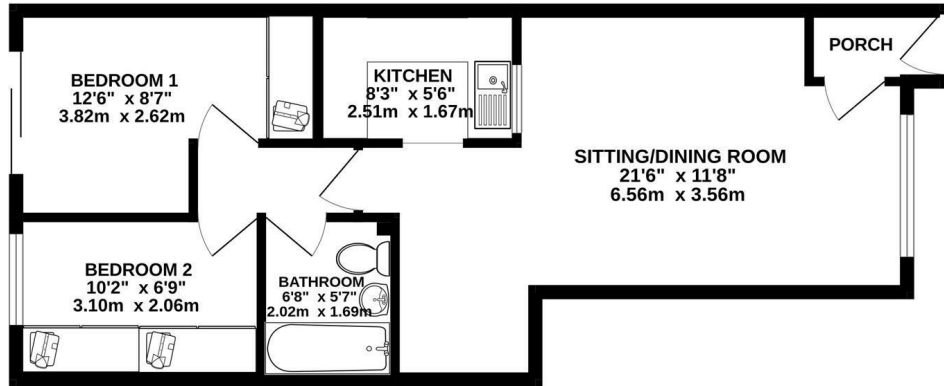

TOTAL FLOOR AREA: 535sq.ft. (49.7 sq.m.) approx.

Whilst every attempt has been made to ensure the accuracy of the floorplan contained here, measurements of doors, windows, rooms and any other items are approximate and no responsibility is taken for any error, omission or mis-statement. This plan is for illustrative purposes only and should be used as such by any prospective purchaser. The services, systems and appliances shown have not been tested and no guarantee as to their operability or efficiency can be given.  
Made with Metropix ©2024



**Bakewell**  
3 Royal Oak Place  
Matlock Street  
Bakewell DE45 1HD  
T: 01629 700699  
E: bakewell@elr.co.uk

**Banner Cross**  
888 Ecclesall Road  
Banner Cross  
Sheffield S11 8TP  
T: 01142 683388  
E: bannercross@elr.co.uk

**Dore**  
33 Townhead Road  
Sheffield  
S17 3GD  
T: 0114 2362420  
E: dore@elr.co.uk

**Hathersage**  
Main Road, Hathersage  
Hope Valley  
Derbyshire S32 1BB  
T: 01433 651888  
E: peakdistrict@elr.co.uk

**Rotherham**  
149 Bawtry Road  
Wickersley  
Rotherham S66 2BW  
T: 01709 917676  
E: wickersley@elr.co.uk

