





## 6, Mayfield Terrace, Hathersage

Hope Valley, S32 1BE

A UPVC glazed porch opens to the sitting room with front facing aspect, fireplace and lovely view across the village. Two archways lead to a dining room and open under-stairs storage. An adjoining kitchen features solid wood units with worktops over incorporating stainless steel sink and drainer, four burner gas hob with extractor over, oven, freezer and space for under-counter fridge and washing machine. A door from the kitchen leads to a rear porch which opens to the patio garden.

Stairs rise to the first floor landing with fitted storage and access to all rooms. Bedroom one is a front facing double bedroom with fitted storage and lovely view across the village. Bedroom three is a generous single bedroom with fitted storage and rear facing aspect. A family bathroom features a suite consisting of a low flush WC, bath with shower over, bidet and washbasin.



- A three bedroomed, mid terrace cottage in the village of Hathersage
- Dining room
- Family bathroom
- UPVC double glazing
- Level access to village facilities
- Kitchen
- Easily maintained front and rear patio gardens
- Sitting room
- Front and rear porches
- Superb views across the village





From the landing stairs lead to a spacious double bedroom with a dormer window and fitted storage.

Outside to the front of the property is a patio garden with wrought iron gates and pathway to the front door. Its west facing orientation will enjoy evening sun at the front of the house. To the rear of the property is an easily maintained patio garden with stone built outbuilding and external WC.















### Ground Floor

Approx. 40.3 sq. metres (433.9 sq. feet)

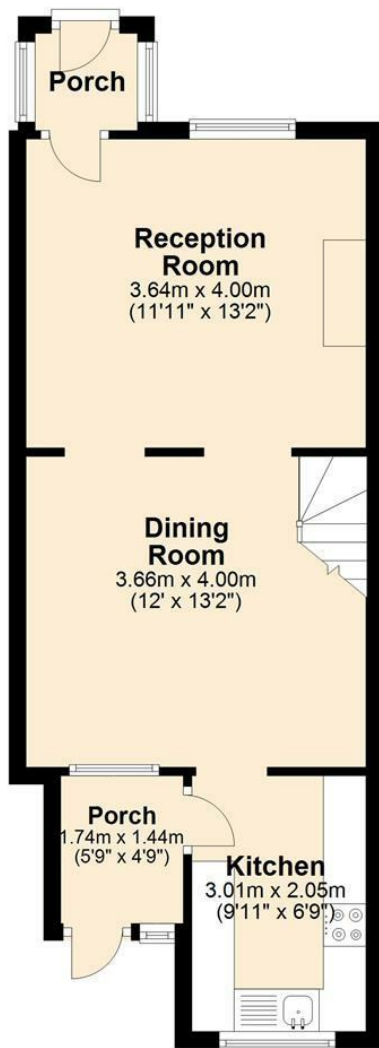

### First Floor

Approx. 35.6 sq. metres (383.0 sq. feet)

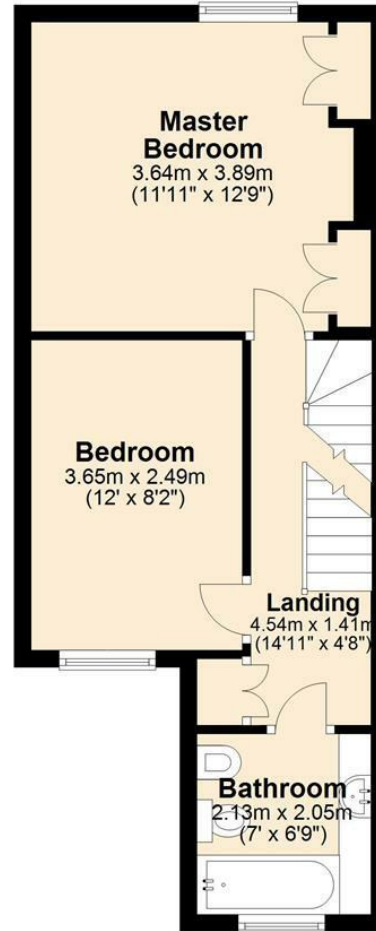

### Second Floor

Approx. 16.3 sq. metres (176.0 sq. feet)



Total area: approx. 92.2 sq. metres (992.9 sq. feet)





#### Bakewell

3 Royal Oak Place  
Matlock Street  
Bakewell DE45 1HD  
T: 01629 700699  
E: bakewell@elr.co.uk

#### Banner Cross

888 Ecclesall Road  
Banner Cross  
Sheffield S11 8TP  
T: 01142 683388  
E: bannercross@elr.co.uk

#### Dore

33 Townhead Road  
Sheffield  
S17 3GD  
T: 0114 2362420  
E: dore@elr.co.uk

#### Hathersage

Main Road, Hathersage  
Hope Valley  
Derbyshire S32 1BB  
T: 01433 651888  
E: peakdistrict@elr.co.uk

#### Rotherham

149 Bawtry Road  
Wickersley  
Rotherham S66 2BW  
T: 01709 917676  
E: wickersley@elr.co.uk

**EADON  
LOCKWOOD  
& RIDDLE**  
ESTD 1840