



19 Whitfeld Road

Ashford, TN23 7TS

Offers In The Region Of £200,000

Older style three bedroom mid terrace house with good sized sunny rear garden, within easy walking distance of mainline station and town centre.

No Chain.

- OLDER STYLE MID TERRACE HOUSE
- THREE BEDROOMS
- GOOD SIZE SUNNY REAR GARDEN
- WALKING DISTANCE OF STATION & TOWN CENTRE
- TWO RECEPTION ROOMS
- NO ONWARD CHAIN

Viewing

Please contact our Ashford Office on 01233 646411 if you wish to arrange a viewing appointment for this property or require further information.

Floor Plan

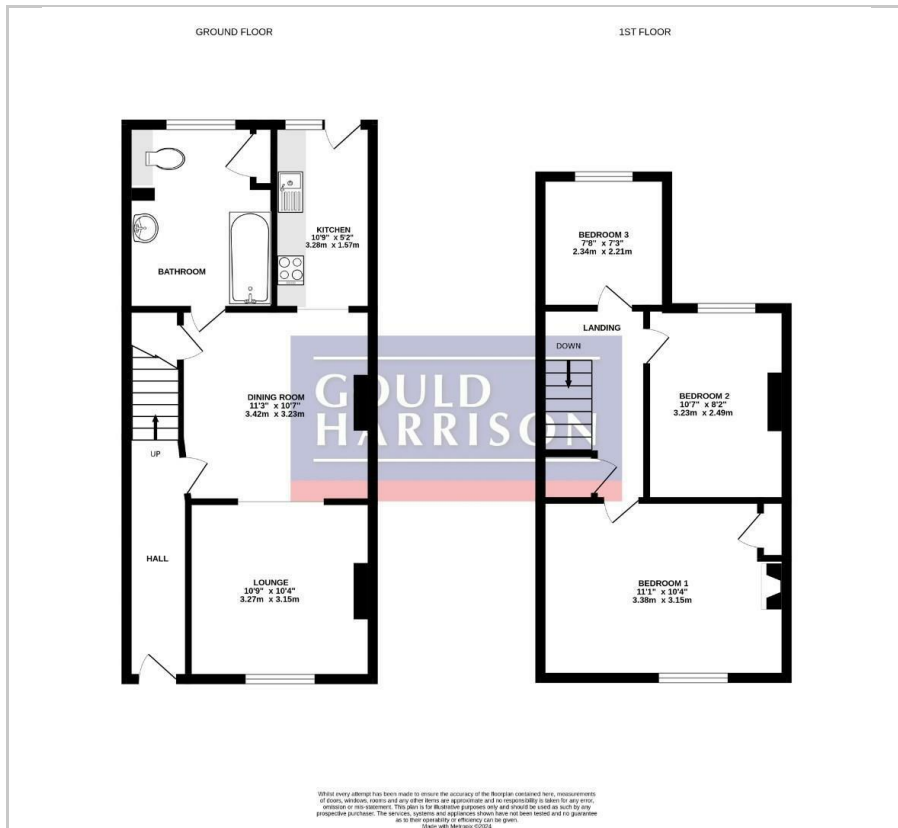

Area Map



Energy Efficiency Graph

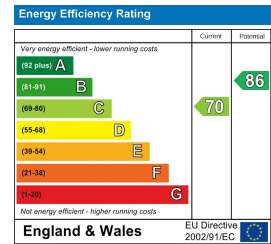

These particulars, whilst believed to be accurate are set out as a general outline only for guidance and do not constitute any part of an offer or contract. Intending purchasers should not rely on them as statements of representation of fact, but must satisfy themselves by inspection or otherwise as to their accuracy. No person in this firm's employment has the authority to make or give any representation or warranty in respect of the property.