



18 Manorfield

Ashford, TN23 5YW

Price £227,500

A pleasantly appointed terraced home offered for sale with no onward chain.

The property comprises an entrance hall, sitting/dining room, kitchen, two bedrooms & bathroom/WC. An enclosed garden can be found to the rear with the property also benefitting from gas central heating, double glazing and allocated parking.

Local schools, shops and doctors are all within easy reach as are many countryside walks.

- TERRACED HOUSE
- TWO BEDROOMS
- ENCLOSED REAR GARDEN
- ALLOCATED PARKING
- GAS CENTRAL HEATING
- DOUBLE GLAZING
- CLOSE TO LOCAL SCHOOLS & SHOPS
- NO ONWARD CHAIN

Viewing

Please contact our Ashford Office on 01233 646411 if you wish to arrange a viewing appointment for this property or require further information.



Floor Plan

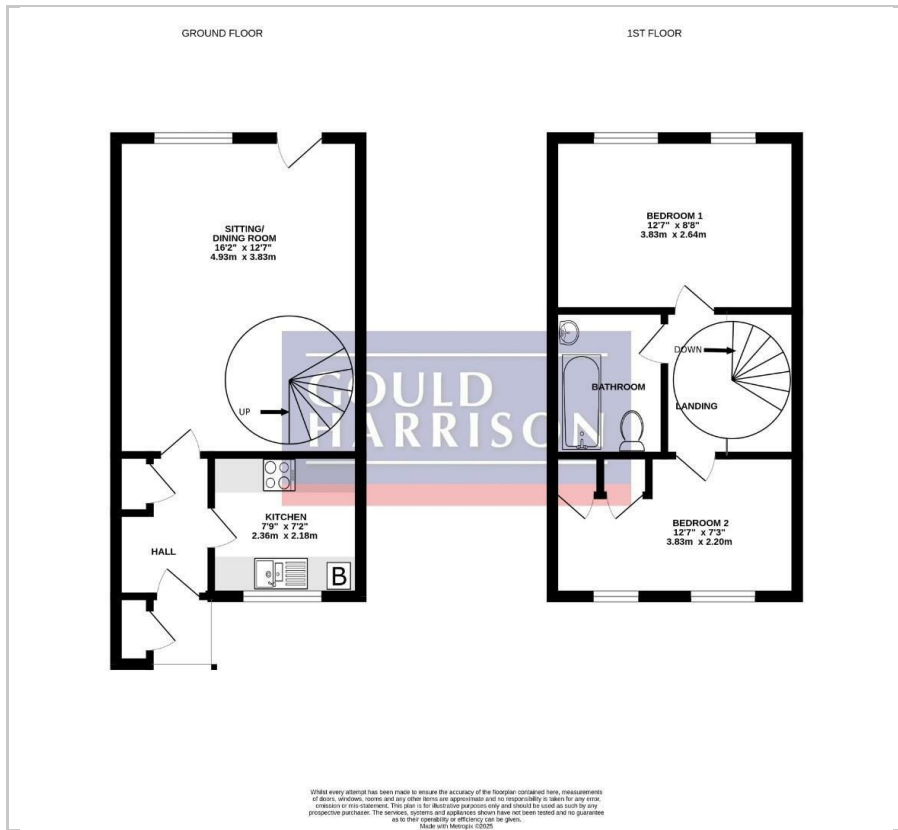

Area Map



Energy Efficiency Graph

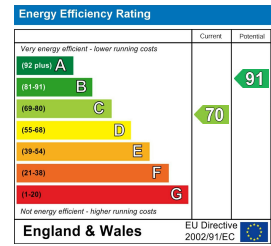

These particulars, whilst believed to be accurate are set out as a general outline only for guidance and do not constitute any part of an offer or contract. Intending purchasers should not rely on them as statements of representation of fact, but must satisfy themselves by inspection or otherwise as to their accuracy. No person in this firm's employment has the authority to make or give any representation or warranty in respect of the property.