



## 10 Perch Close

Ashford, TN23 5FN

Price £290,000

A spacious modern home in a pleasant cul de sac setting, within easy reach of popular local schools, shops and countryside walks.

The well appointed accommodation comprises an entrance hall, cloakroom, kitchen/dining room, sitting room, two double bedrooms with built in wardrobes, en suite and family bathroom/WC.

Allocated parking is included whilst the property also enjoys gas central heating, double glazing and enclosed rear garden.

### Viewing

Please contact our Ashford Office on 01233 646411 if you wish to arrange a viewing appointment for this property or require further information.

- SPACIOUS TERRACED HOUSE
- TWO DOUBLE BEDROOMS WITH BUILT IN WARDROBES
- EN SUITE & FAMILY BATHROOM
- KITCHEN/DINING ROOM
- ALLOCATED PARKING SPACE
- CUL DE SAC POSITION
- GF CLOAKROOM
- GAS CENTRAL HEATING & DOUBLE GLAZING
- CLOSE TO LOCAL SCHOOLS & AMENITIES



B

Floor Plan

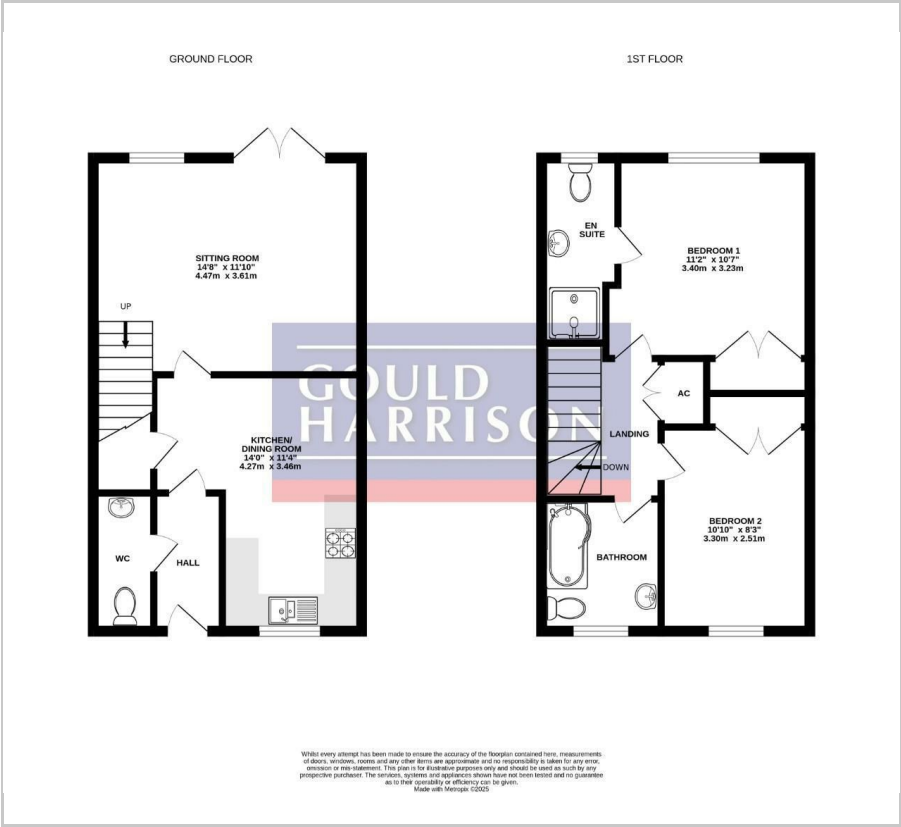

Area Map



Energy Efficiency Graph

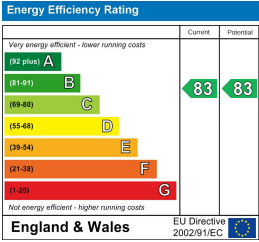

These particulars, whilst believed to be accurate are set out as a general outline only for guidance and do not constitute any part of an offer or contract. Intending purchasers should not rely on them as statements of representation of fact, but must satisfy themselves by inspection or otherwise as to their accuracy. No person in this firm's employment has the authority to make or give any representation or warranty in respect of the property.