



361 Hythe Road

Willesborough, TN24 0QF

Price £335,000

Offered for sale with no onward chain is this delightful semi-detached home in the popular Willesborough area. The extended accommodation comprises an entrance hall, sitting room, dining room, kitchen, three bedrooms and shower room/WC. The rear garden is notably generous with the property also benefitting from gas central heating, double glazing and garage accessed via a shared driveway.

Multiple schools of good standing are easily accessible as is the William Harvey Hospital and Ashford mainline station only 1.5 miles away making this a popular location for families and commuters.

Viewing

Please contact our Ashford Office on 01233 646411 if you wish to arrange a viewing appointment for this property or require further information.

- EXTENDED SEMI DETACHED HOUSE
- THREE BEDROOMS
- THREE RECEPTION ROOMS
- VERY GENEROUS REAR GARDEN
- GARAGE & DRIVEWAY
- 1.5 MILES FROM ASHFORD MAINLINE STATION
- GAS CENTRAL HEATING & DOUBLE GLAZING
- SHORT WALK TO POPULAR LOCAL SCHOOLS



Floor Plan

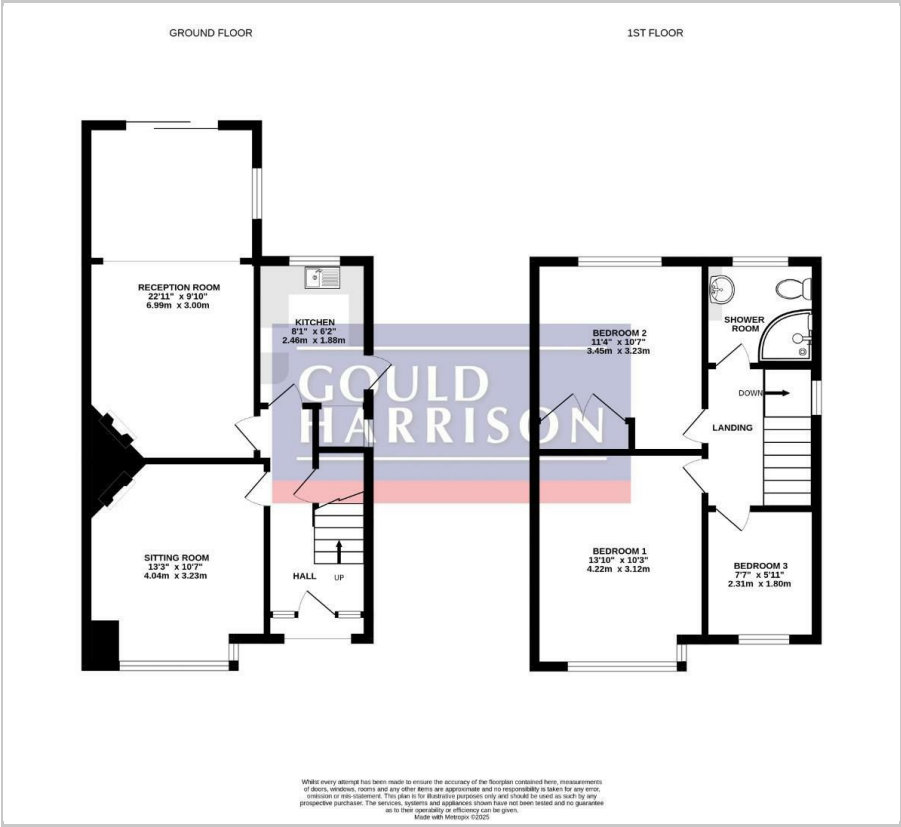

Area Map



Energy Efficiency Graph

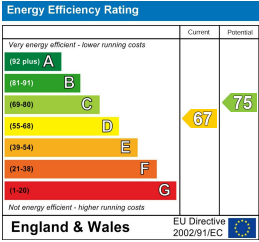

These particulars, whilst believed to be accurate are set out as a general outline only for guidance and do not constitute any part of an offer or contract. Intending purchasers should not rely on them as statements of representation of fact, but must satisfy themselves by inspection or otherwise as to their accuracy. No person in this firms employment has the authority to make or give any representation or warranty in respect of the property.