



Gray Haniestep Victoria Crescent

Ashford, TN23 7HL

Price £270,000

A pleasantly appointed semi detached home just to the south of Ashford town centre, offered for sale with no onward chain. This central location affords excellent access to Ashford mainline station, local schools of good standing and a range shops and leisure facilities including the Designer Outlet. The property would benefit from some modernisation and comprises an entrance hall, sitting room, dining room, kitchen, three bedrooms and bathroom/WC. To the rear is a generous garden which enjoys a secluded feel and southerly aspect. Viewing by appointment.

Viewing

Please contact our Ashford Office on 01233 646411 if you wish to arrange a viewing appointment for this property or require further information.

- SEMI DETACHED HOUSE
- THREE BEDROOMS
- TWO RECEPTION ROOMS
- SHORT WALK FROM TOWN CENTRE & ASHFORD MAINLINE STATION
- GENEROUS SECLUDED REAR GARDEN
- SOME MODERNISATION REQUIRED
- EXCITING POTENTIAL
- NO ONWARD CHAIN

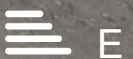

Floor Plan

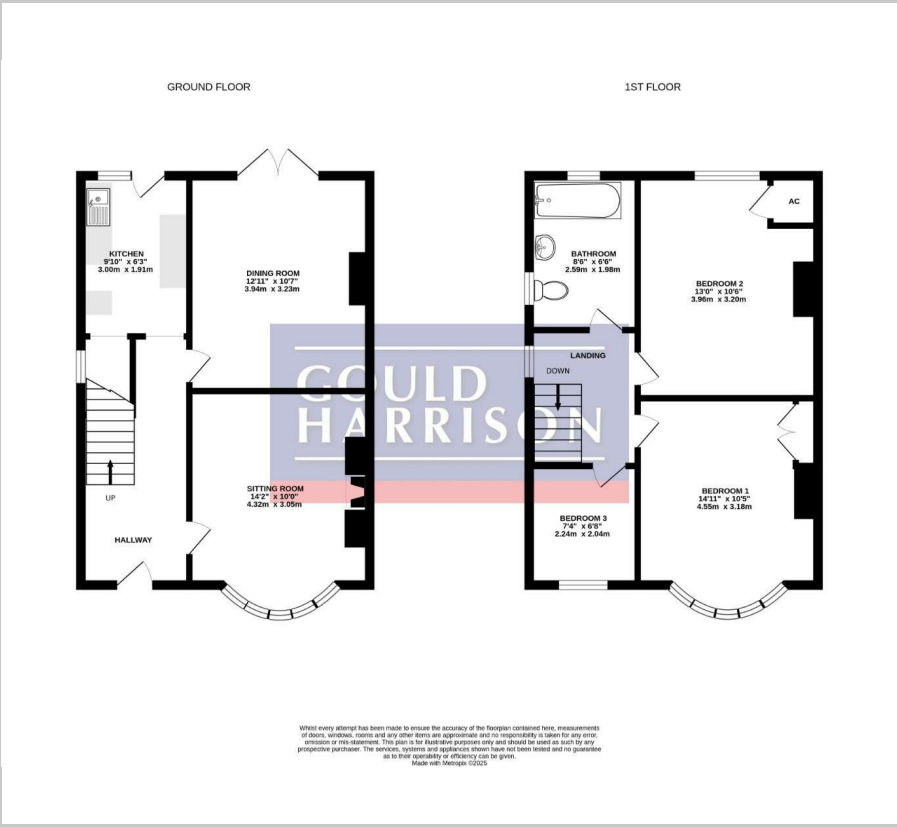

Area Map

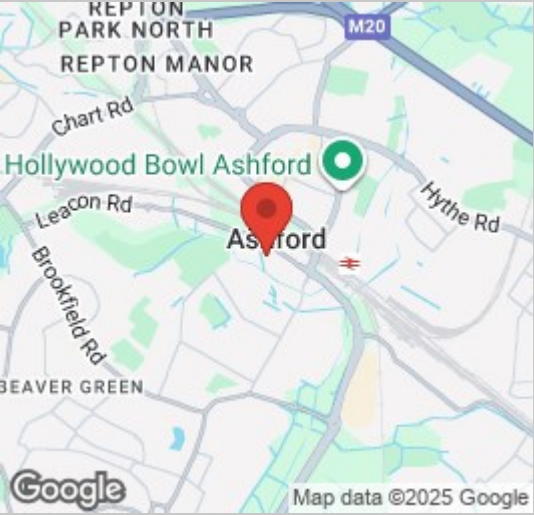

Energy Efficiency Graph

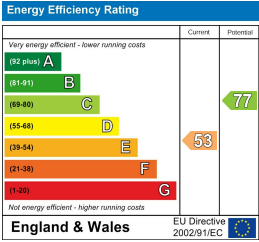

These particulars, whilst believed to be accurate are set out as a general outline only for guidance and do not constitute any part of an offer or contract. Intending purchasers should not rely on them as statements of representation of fact, but must satisfy themselves by inspection or otherwise as to their accuracy. No person in this firms employment has the authority to make or give any representation or warranty in respect of the property.