



15 Herdwick Close

Kingsnorth, TN25 7FH

Price £360,000

A spacious semi-detached house arranged over three floors on the popular Bridgefield development.

The property comprises an entrance hall, cloakroom, kitchen/breakfast room, sitting room, conservatory, three double bedrooms, en suite and family bathroom. To the side of the property is a driveway and carport with an enclosed garden to rear. Gas central heating and double glazing is installed whilst local schools, bus routes and amenities are within easy reach.

- SPACIOUS SEMI DETACHED HOUSE
- ARRANGED OVER THREE FLOORS
- THREE DOUBLE BEDROOMS
- EN-SUITE & FAMILY BATHROOM
- FITTED KITCHEN/BREAKFAST ROOM
- CONSERVATORY
- CARPORT & DRIVEWAY
- GAS CENTRAL HEATING & DOUBLE GLAZING
- POPULAR MODERN DEVELOPMENT

Viewing

Please contact our Ashford Office on 01233 646411 if you wish to arrange a viewing appointment for this property or require further information.



Floor Plan

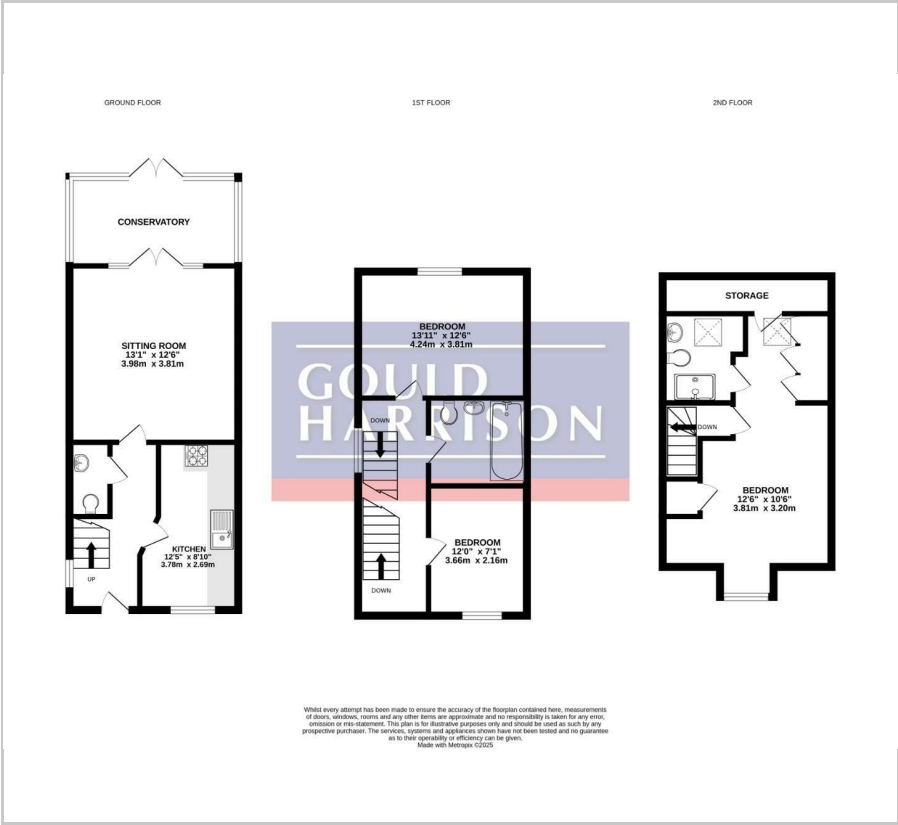

Area Map



Energy Efficiency Graph

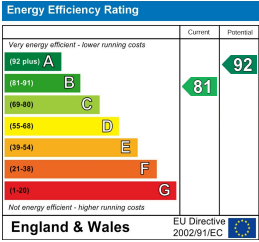

These particulars, whilst believed to be accurate are set out as a general outline only for guidance and do not constitute any part of an offer or contract. Intending purchasers should not rely on them as statements of representation of fact, but must satisfy themselves by inspection or otherwise as to their accuracy. No person in this firms employment has the authority to make or give any representation or warranty in respect of the property.