



23 Magazine Road

, Ashford, TN24 8NJ

£2,000 Per Month

Large family home just outside the centre of Ashford offering great access to the M20 motorway and local amenities. Having just been decorated and recarpeted this home views extremely well and in our opinion offers great sized living accommodation on both floors. Downstairs offers a large living room with bay window, dining room, modern fitted kitchen, utility area and a cloakroom whilst upstairs there are four bedrooms and a three piece bathroom suite. Outside is a large well established rear garden, a drive to the front with parking for multiple vehicles and a garage. With double glazing throughout and a new gas central heating system this really is a house you will feel proud to call home. Call us now to register your interest and to arrange a viewing.

Minimum tenancy 6 calendar months
Security deposit £2307
Council Tax Band - F
EPC - Awaiting confirmation

Viewing

Please contact our Ashford Office on 01233 646411 if you wish to arrange a viewing appointment for this property or require further information.

- LARGE REFURBISHED FAMILY HOME
- WELL LOCATED
- FOUR BEDROOMS
- TWO RECEPTION ROOMS
- DOUBLE GLAZING AND GAS CENTRAL HEATING
- LARGE REAR GARDEN
- PARKING AND GARAGE
- MINIMUM TENANCY 6 CALENDAR MONTHS
- SECURITY DEPOSIT £2307
- CALL US NOW TO ARRANGE A VIEWING

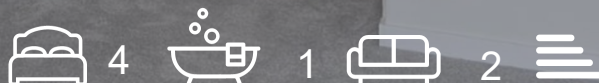

Floor Plan

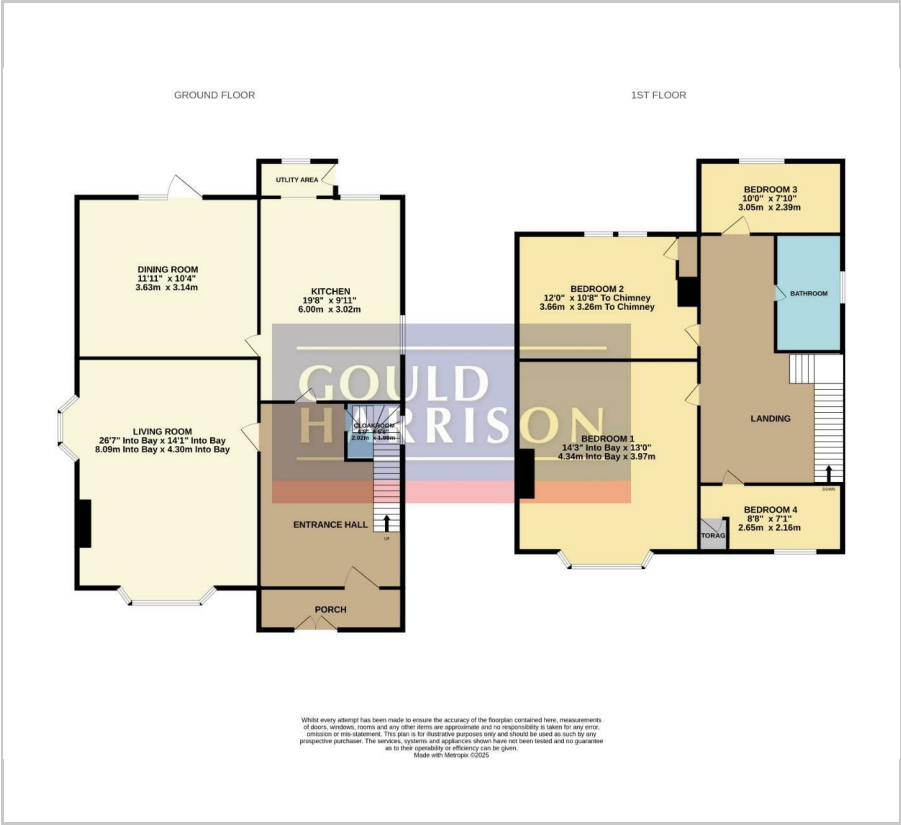

Area Map



Energy Efficiency Graph

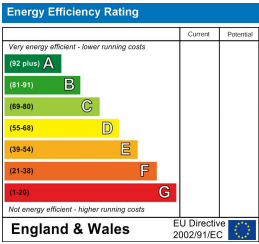

These particulars, whilst believed to be accurate are set out as a general outline only for guidance and do not constitute any part of an offer or contract. Intending purchasers should not rely on them as statements of representation of fact, but must satisfy themselves by inspection or otherwise as to their accuracy. No person in this firms employment has the authority to make or give any representation or warranty in respect of the property.