



## 20 Samuel Peto Way

Ashford, TN24 0XP

Price £298,500

Offered for sale with no onward chain is this modern end of terrace home, just a few minutes walk from Ashford mainline station.

The property comprises an entrance hall, ground floor cloakroom, kitchen, sitting room, three bedrooms and bathroom/wc. A carport can be found to the rear of the property providing covered parking along with an enclosed garden. The property also benefits from gas central heating and double glazing.

- MODERN END OF TERRACE HOUSE
- THREE BEDROOMS
- OPEN PLAN KITCHEN/LIVING SPACE
- GROUND FLOOR CLOAKROOM
- CARPORT PROVIDING COVERED PARKING
- SHORT WALK FROM MAINLINE STATION
- GAS CENTRAL HEATING
- DOUBLE GLAZING
- NO ONWARD CHAIN

### Viewing

Please contact our Ashford Office on 01233 646411 if you wish to arrange a viewing appointment for this property or require further information.





Floor Plan

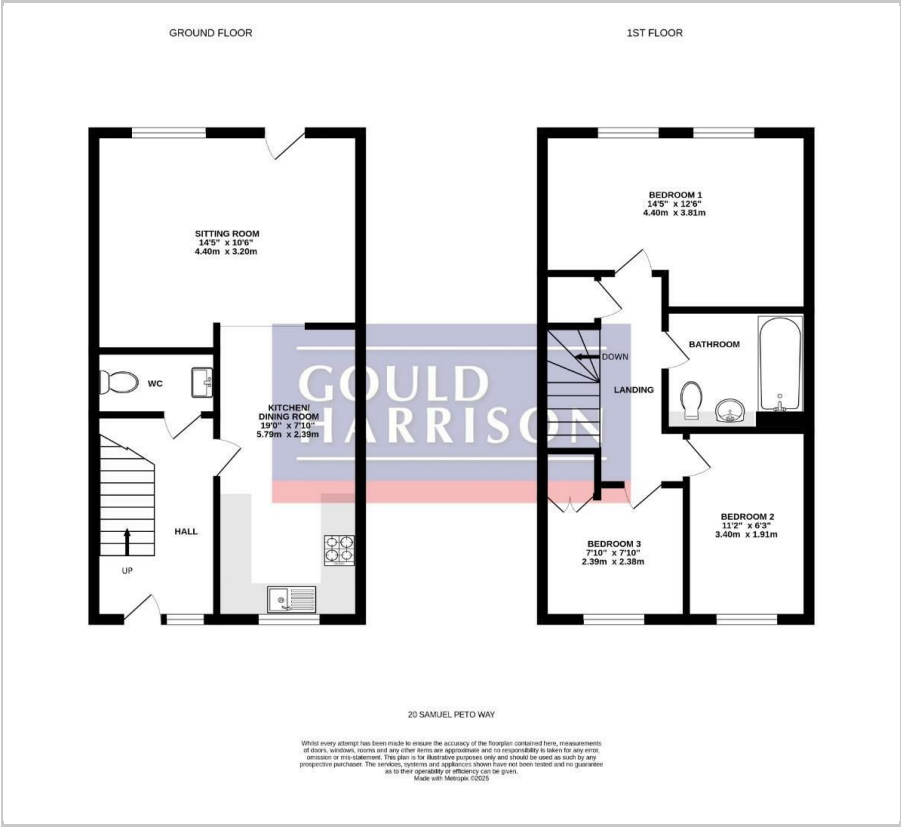

Area Map



Energy Efficiency Graph

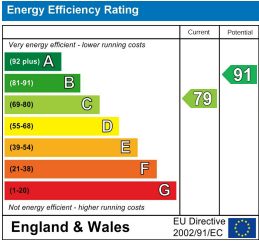

These particulars, whilst believed to be accurate are set out as a general outline only for guidance and do not constitute any part of an offer or contract. Intending purchasers should not rely on them as statements of representation of fact, but must satisfy themselves by inspection or otherwise as to their accuracy. No person in this firm's employment has the authority to make or give any representation or warranty in respect of the property.