



2 Lakemead

Ashford, TN23 4XX

Price £290,000

A very well presented semi detached house in a sought after residential area, just a short walk from local schools, shops and transport links.

The tastefully decorated accommodation comprises an entrance hall, cloakroom, kitchen, sitting room, two bedrooms and modern bathroom/wc. The rear garden is laid for ease of maintenance and provides access to the converted garage with offers a useful utility and space to work from home.

Gas central heating and double glazing are installed along with a driveway providing off road parking.

Viewing

Please contact our Ashford Office on 01233 646411 if you wish to arrange a viewing appointment for this property or require further information.

- SEMI DETACHED HOUSE
- TWO BEDROOMS
- VERY WELL PRESENTED
- ENCLOSED EASY TO MAINTAIN REAR GARDEN
- DRIVEWAY
- GAS CENTRAL HEATING
- DOUBLE GLAZING
- CONVERTED GARAGE OFFERING STUDY & UTILITY
- CLOSE TO LOCAL SCHOOLS & SHOPS



Floor Plan

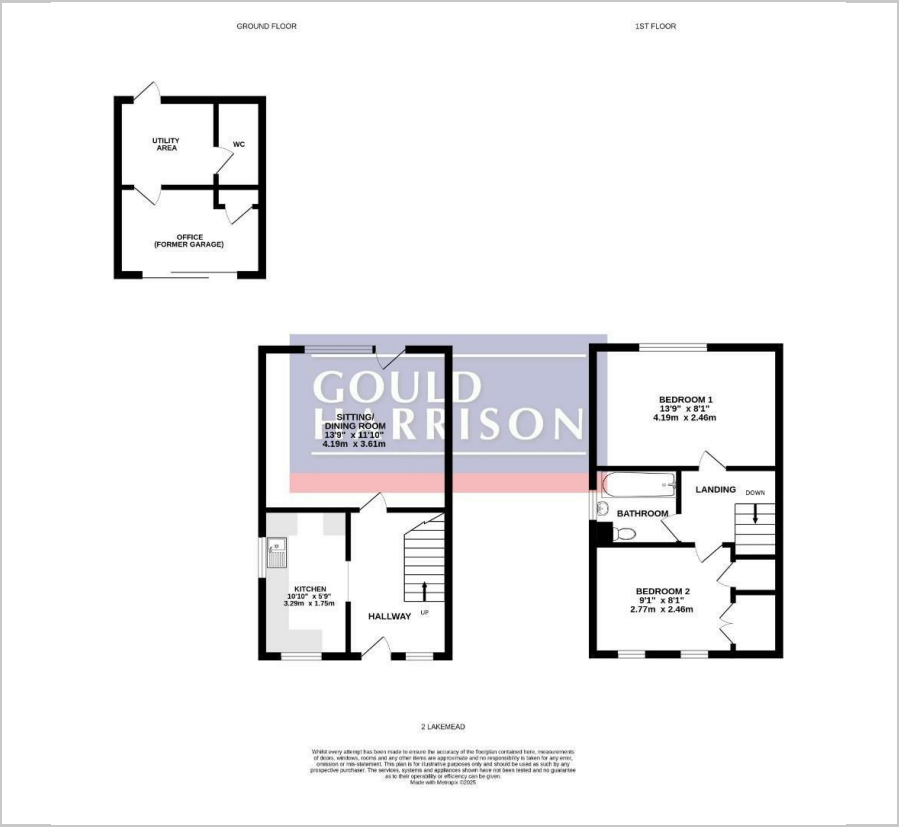

Area Map



Energy Efficiency Graph

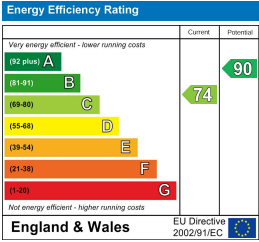

These particulars, whilst believed to be accurate are set out as a general outline only for guidance and do not constitute any part of an offer or contract. Intending purchasers should not rely on them as statements of representation of fact, but must satisfy themselves by inspection or otherwise as to their accuracy. No person in this firm's employment has the authority to make or give any representation or warranty in respect of the property.