



44 Bowens Field

Ashford, TN23 4QW

Price £225,000

A modern end terrace house converted into two bedrooms, in quiet convenient location close to Ashford town centre and mainline station.

The accommodation comprises entrance lobby, lounge, kitchen, two bedrooms and shower room with parking at the front of the property for two cars.

- MODERN END OF TERRACE HOUSE
- TWO BEDROOMS
- QUIET LOCATION CLOSE TO TOWN CENTRE & STATION
- PARKING FOR TWO CARS
- SHOWER ROOM

Viewing

Please contact our Ashford Office on 01233 646411 if you wish to arrange a viewing appointment for this property or require further information.

Floor Plan

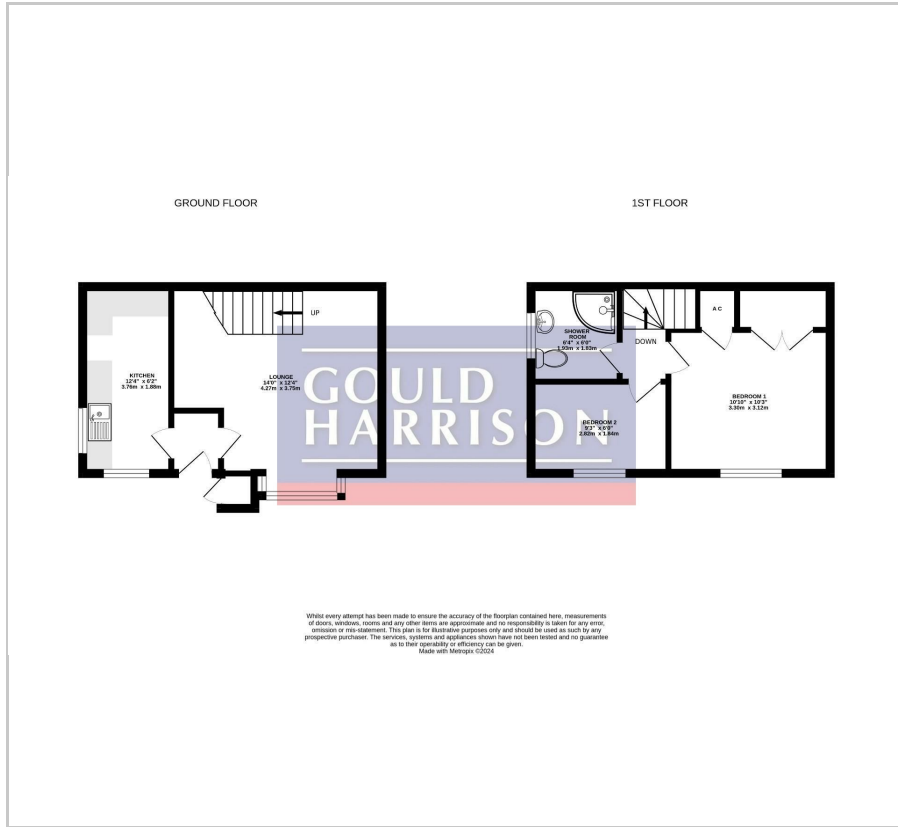

Area Map



Energy Efficiency Graph

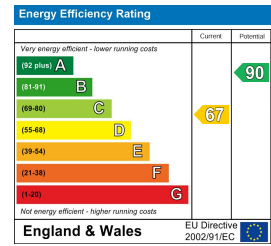

These particulars, whilst believed to be accurate are set out as a general outline only for guidance and do not constitute any part of an offer or contract. Intending purchasers should not rely on them as statements of representation of fact, but must satisfy themselves by inspection or otherwise as to their accuracy. No person in this firm's employment has the authority to make or give any representation or warranty in respect of the property.