



13 Orchard Drive

Wye, TN25 5AU

Offers In Excess Of £400,000

A pleasantly appointed detached bungalow in the sought after village of Wye, offered for sale with no onward chain.

Backing on to open farmland, the property comprises an entrance hall, cloakroom, sitting room, kitchen, two bedrooms and shower room/WC and lean to conservatory.

The attractive rear garden enjoys far reaching views across open farmland whilst the property also benefits from central heating, driveway and garage.

Local shops, shops and transport link are easily accessible in the village along with some wonderful countryside walks on the doorstep.

Viewing

Please contact our Ashford Office on 01233 646411 if you wish to arrange a viewing appointment for this property or require further information.

- DETACHED BUNGALOW
- TWO BEDROOMS
- BACKING ON TO OPEN FARMLAND
- ATTRACTIVE REAR GARDEN
- GARAGE & DRIVEWAY
- EXCELLENT POTENTIAL
- CLOSE TO LOCAL SHOPS AND AMENITIES
- CLOAKROOM & SHOWER ROOM/WC
- NO ONWARD CHAIN

Floor Plan

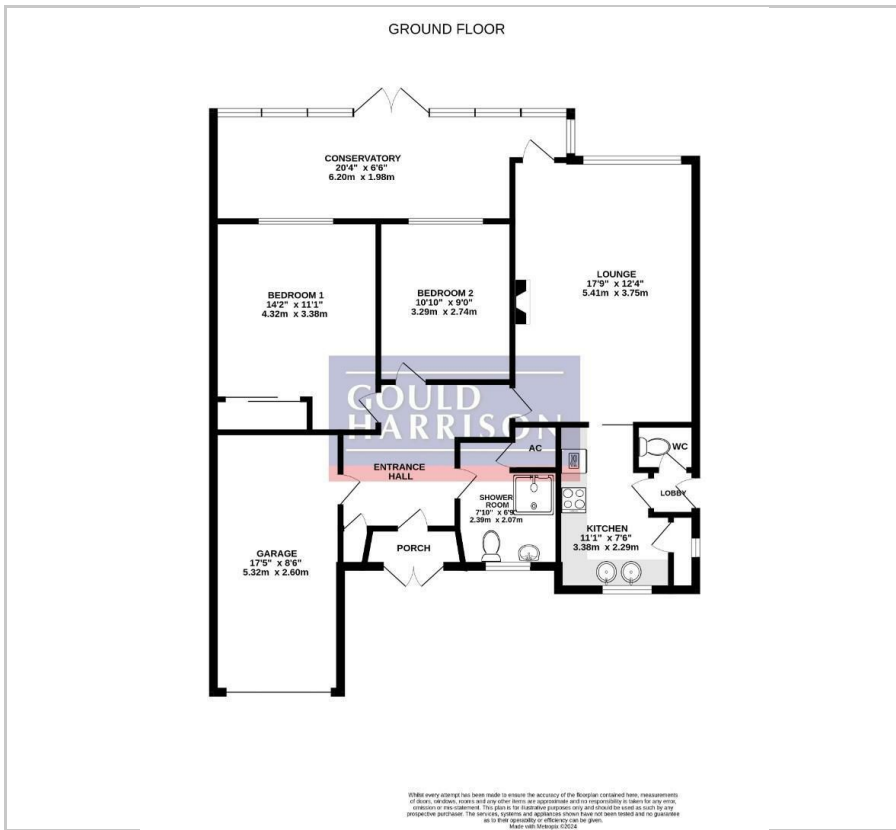

Area Map



Energy Efficiency Graph

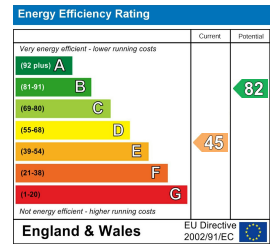

These particulars, whilst believed to be accurate are set out as a general outline only for guidance and do not constitute any part of an offer or contract. Intending purchasers should not rely on them as statements of representation of fact, but must satisfy themselves by inspection or otherwise as to their accuracy. No person in this firm's employment has the authority to make or give any representation or warranty in respect of the property.