



## 33 Thornlea

Ashford, TN23 3JX

Price £475,000

An impressive detached home in the popular Godinton Park area, close to local schools, shops and transport links.

Thoughtfully extended, this wonderful family home comprises an entrance hall, sitting room, dining room, kitchen, bedroom and luxury bathroom suite.

To the first floor are four bedrooms, en suite dressing room and bathroom with a further family bathroom.

Presented in very good order throughout, the property also benefits from gas central heating, double glazing, an enclosed rear garden and driveway providing off road parking.

### Viewing

Please contact our Ashford Office on 01233 646411 if you wish to arrange a viewing appointment for this property or require further information.

- STUNNING DETACHED HOUSE
- SPACIOUS LIVING ACCOMMODATION
- FIVE BEDROOMS
- THREE LUXURY BATHROOM SUITES
- EN SUITE DRESSING ROOM
- OFF ROAD PARKING
- CLOSE TO LOCAL SCHOOLS AND AMENITIES
- CUL DE SAC LOCATION
- VERY WELL PRESENTED



# Floor Plan

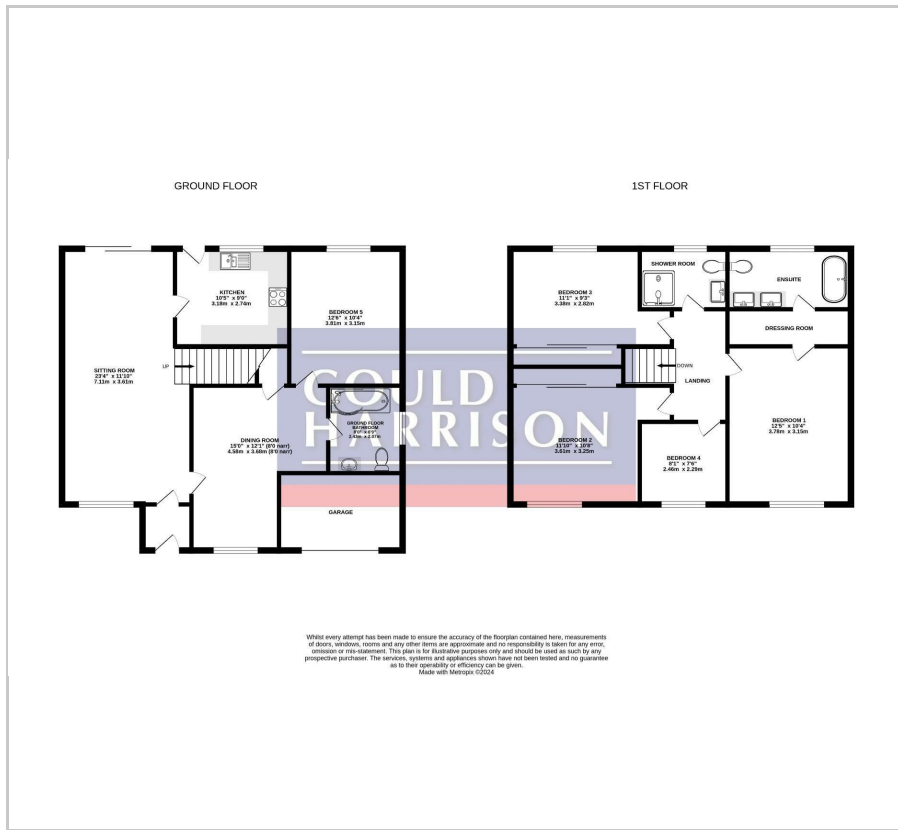

# Area Map



# Energy Efficiency Graph

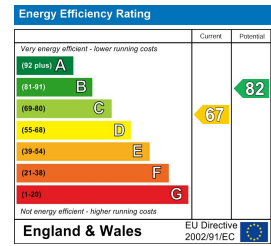

These particulars, whilst believed to be accurate are set out as a general outline only for guidance and do not constitute any part of an offer or contract. Intending purchasers should not rely on them as statements of representation of fact, but must satisfy themselves by inspection or otherwise as to their accuracy. No person in this firm's employment has the authority to make or give any representation or warranty in respect of the property.