



**12 Kempes Place, Wye, TN25 5AX**  
**70% Shared ownership £112,000**

One bedroom first floor retirement flat set in the centre of the popular village of Wye. Reception room, kitchen, shower room, bedroom, gas central heating and well kept communal gardens with parking area.

Quietly situated and being one of a development of 12 properties comprising Kempes Place and is administered by Anchor Management Services which is specifically designed accommodation for the retired with a 24 hour emergency monitoring system.

The discounted price of £112,000 takes account of the 30% share holding by Anchor Management Services.

**Communal Front Door to:**

**Hallway**

With entry phone facility and staircase to first floor.

**Entrance Hall**

With storage and meter cupboards.

**Lounge 14'7 x 10'6 (4.45m x 3.20m)**

UPVC double glazed window to rear.

**Kitchen 10'11 x 5'8 (3.33m x 1.73m)**

Porcelain sink unit, range of drawers and cupboards beneath worktops, wall cupboards, Vaillant gas boiler for central heating and domestic hot water.

**Bedroom 12'7 x 9'10 (3.84m x 3.00m)**

Window to front.

**Shower Room 7'2 x 5'9 (2.18m x 1.75m)**

Glass fronted shower cubicle, pedestal wash hand basin and low level WC, built in linen cupboard.

**Outside**

Well kept communal gardens and parking area.

**Tenure**

Leasehold - Balance of 99 year lease from 1987. Service Charge: £154.51 per month (tbc) to include buildings insurance.

**Services**

All main services are connected.

**Council Tax**

Ashford Borough Council Band: B.

**Energy Efficiency Graph**

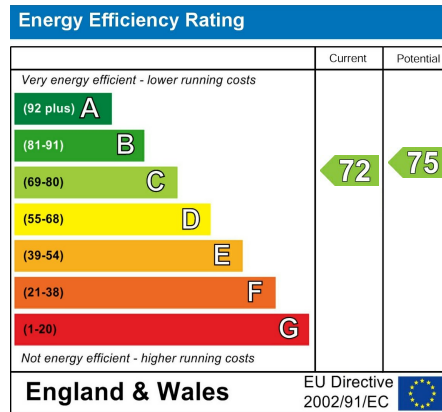

**Floor Plan**

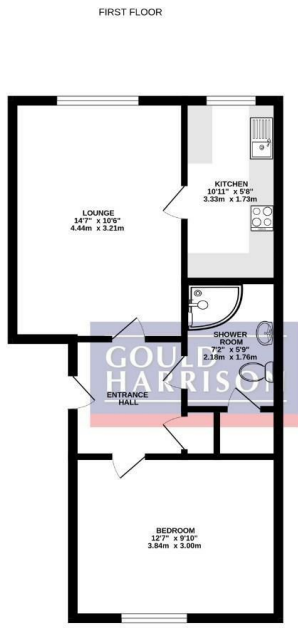

Whilst every effort has been made to ensure the accuracy of the floorplan, we cannot guarantee the accuracy of the measurements. The plan is for information only and should not be used as a basis for any contract. The actual measurements may vary from those shown on the plan. We do not warrant or guarantee the accuracy of the measurements. We do not warrant or guarantee the accuracy of the measurements. We do not warrant or guarantee the accuracy of the measurements.

**Area Map**

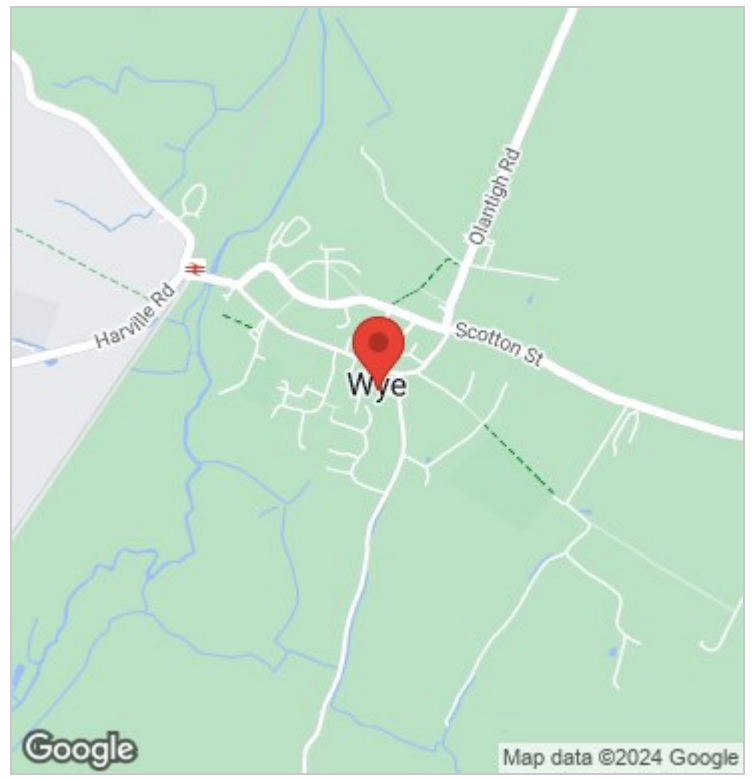

These particulars, whilst believed to be accurate are set out as a general outline only for guidance and do not constitute any part of an offer or contract. Intending purchasers should not rely on them as statements of representation of fact, but must satisfy themselves by inspection or otherwise as to their accuracy. No person in this firm's employment has the authority to make or give any representation or warranty in respect of the property.