



11 Earlsworth Road

Willesborough, Ashford, TN24 0DF

Price £270,000

A spacious terraced home close to local schools and amenities, offered for sale with no onward chain.

The property comprises an entrance porch, sitting room, kitchen/dining room, cloakroom, three bedrooms and large bathroom/WC. The rear garden is pleasantly enclosed and backs on to open ground with the property also benefiting from gas central heating, double glazing and off road parking.

- SPACIOUS TERRACED HOUSE
- THREE BEDROOMS
- KITCHEN/DINING ROOM
- OFF ROAD PARKING
- ENCLOSED REAR GARDEN
- GAS CENTRAL HEATING
- DOUBLE GLAZING
- PLEASANT OUTLOOK TO REAR
- NO ONWARD CHAIN

Viewing

Please contact our Ashford Office on 01233 646411 if you wish to arrange a viewing appointment for this property or require further information.

Floor Plan

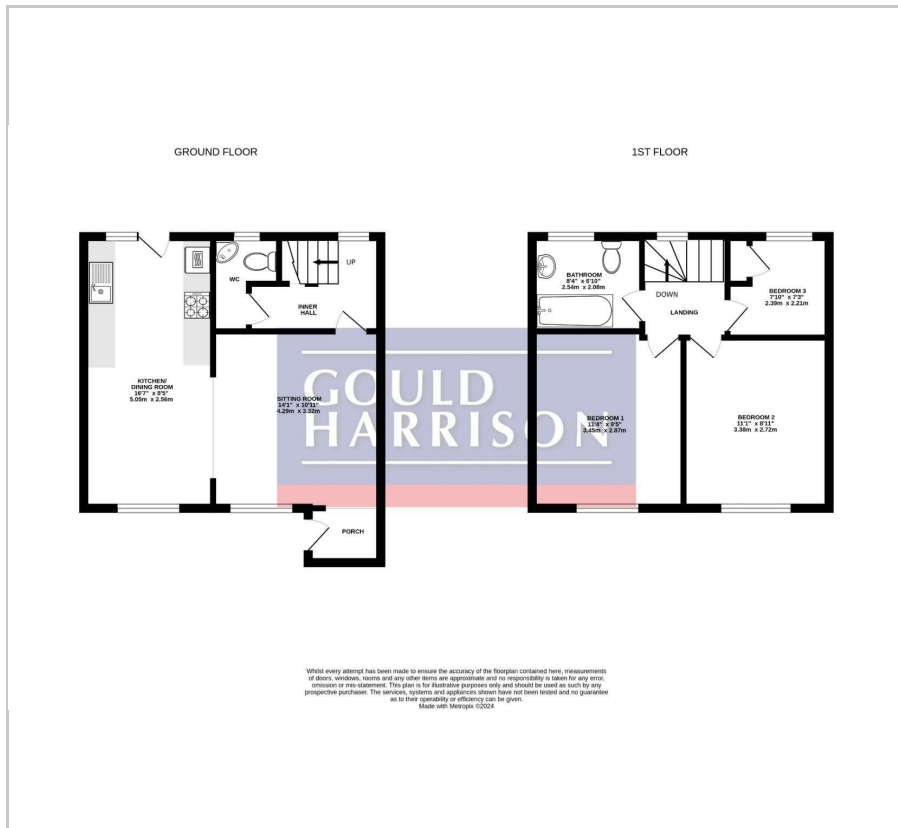

Area Map



Energy Efficiency Graph

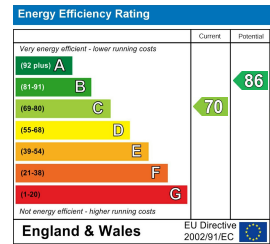

These particulars, whilst believed to be accurate are set out as a general outline only for guidance and do not constitute any part of an offer or contract. Intending purchasers should not rely on them as statements of representation of fact, but must satisfy themselves by inspection or otherwise as to their accuracy. No person in this firm's employment has the authority to make or give any representation or warranty in respect of the property.