



6 Pattison Farm Close

Aldington, Ashford, TN25 7BG

Price £200,000

Situated in a quiet cul de sac on the southern side of the popular village of Aldington. Ashford town centre and mainline station are about seven miles.

Three good sized bedrooms and cloakroom on the first floor, lounge, kitchen, conservatory and wet room on the ground floor, gardens to front and rear with a nearby garage en bloc. No Chain.

- SEMI DETACHED VILLAGE HOUSE
- THREE BEDROOMS
- VILLAGE LOCATION
- GROUND FLOOR WET ROOM
- CASH BUYERS ONLY
- NO ONWARD CHAIN
- GARAGE EN BLOC

Viewing

Please contact our Ashford Office on 01233 646411 if you wish to arrange a viewing appointment for this property or require further information.

Floor Plan

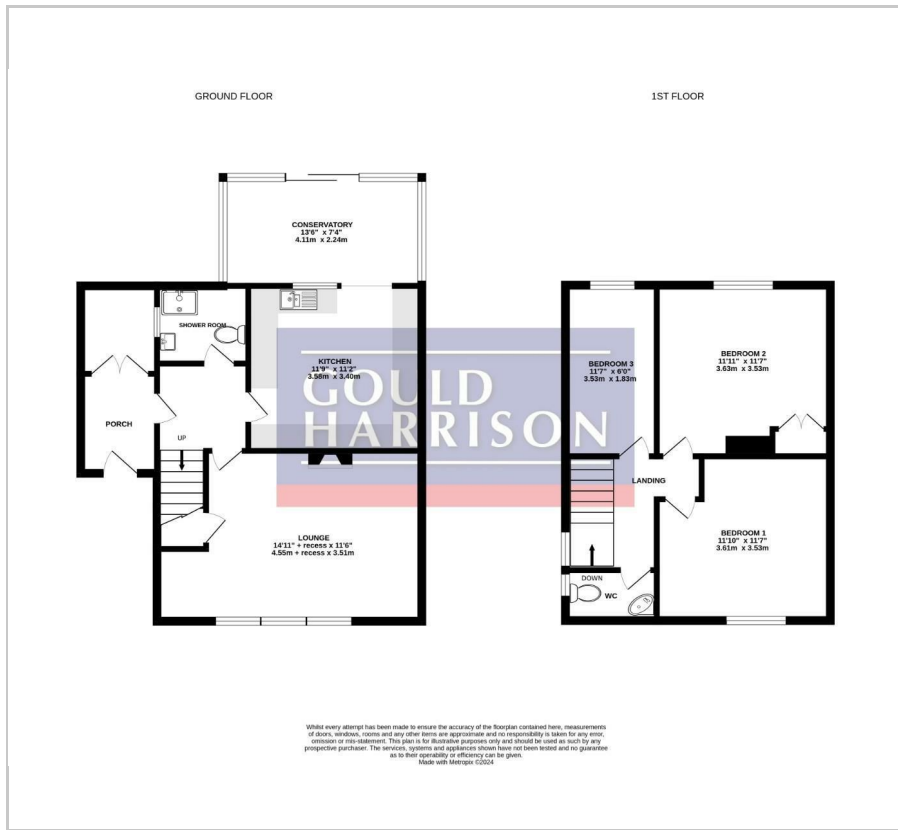

Area Map



Energy Efficiency Graph

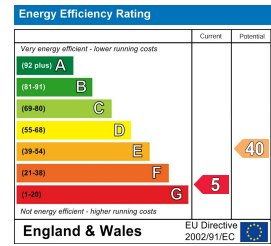

These particulars, whilst believed to be accurate are set out as a general outline only for guidance and do not constitute any part of an offer or contract. Intending purchasers should not rely on them as statements of representation of fact, but must satisfy themselves by inspection or otherwise as to their accuracy. No person in this firm's employment has the authority to make or give any representation or warranty in respect of the property.