



16 Siegfried Close

Sellindge, Ashford, TN25 6BX

Offers In The Region Of £330,000

An immaculate well designed modern semi detached house.

Situated in the popular village of Sellindge, the property comprises entrance hall, cloakroom, kitchen/dining room, sitting room, bedroom with en suite shower room, two further bedrooms and bathroom. The enclosed rear garden is laid to lawn with paved patio and with the property also benefitting from gas central heating, double glazing and allocated parking with car barn.

Viewing

Please contact our Ashford Office on 01233 646411 if you wish to arrange a viewing appointment for this property or require further information.

- IMMACULATE SEMI DETACHED HOUSE
- SOUGHT AFTER VILLAGE LOCATION
- THREE BEDROOMS
- EN SUITE SHOWER ROOM & FAMILY BATHROOM
- GROUND FLOOR WC
- NICELY ENCLOSED GARDEN
- CARPORT & DRIVEWAY
- CLOSE TO VILLAGE AMENITIES
- KITCHEN/DINING ROOM

Floor Plan

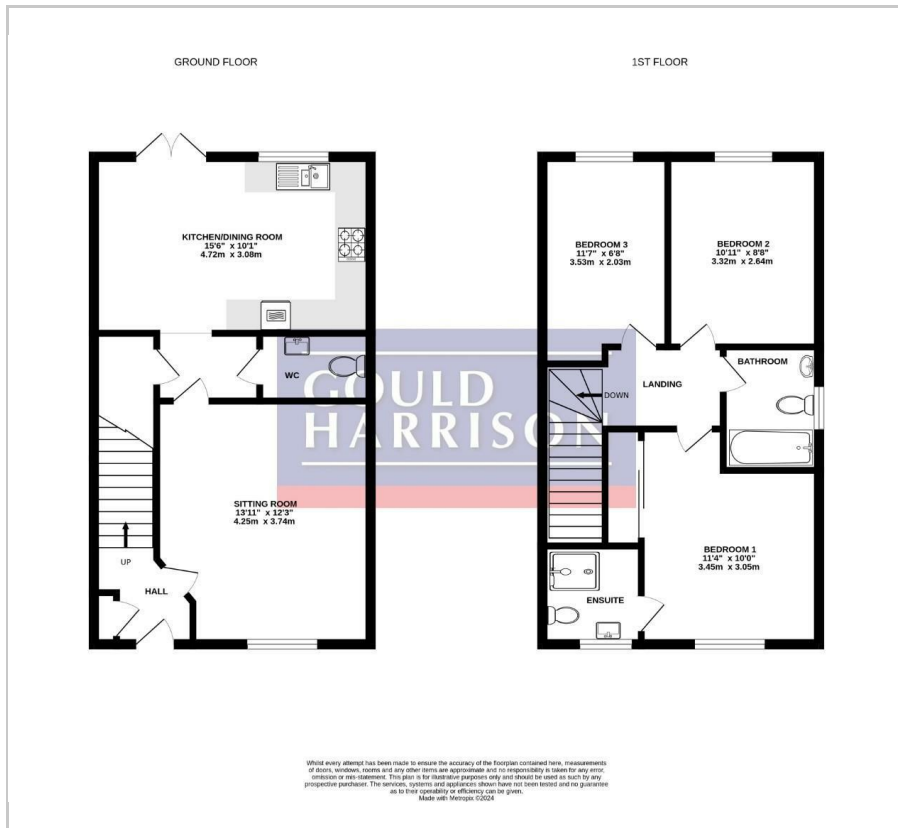

Area Map



Energy Efficiency Graph

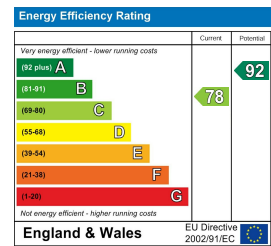

These particulars, whilst believed to be accurate are set out as a general outline only for guidance and do not constitute any part of an offer or contract. Intending purchasers should not rely on them as statements of representation of fact, but must satisfy themselves by inspection or otherwise as to their accuracy. No person in this firm's employment has the authority to make or give any representation or warranty in respect of the property.