



58 Langney Drive

Ashford, TN23 5UL

Offers In Excess Of £320,000

Spacious three bedroom semi detached house with extended ground floor living accommodation. Offered Chain Free.

Situated in the popular Bridewell area of Ashford the house comprises entrance lobby, hallway, cloakroom, 23ft lounge, dining room, family room, kitchen, three bedrooms, bathroom, driveway and garden.

Viewing

Please contact our Ashford Office on 01233 646411 if you wish to arrange a viewing appointment for this property or require further information.

- SPACIOUS SEMI DETACHED HOUSE
- THREE BEDROOMS
- EXTENDED ON THE GROUND FLOOR
- THREE RECEPTION ROOMS
- MODERN KITCHEN & BATHROOM
- NO ONWARD CHAIN
- EXCELLENT CATCHMENT FOR LOCAL SCHOOLS
- GAS CENTRAL HEATING
- ENCLOSED REAR GARDEN
- DRIVEWAY PROVIDING OFF ROAD PARKING



Floor Plan

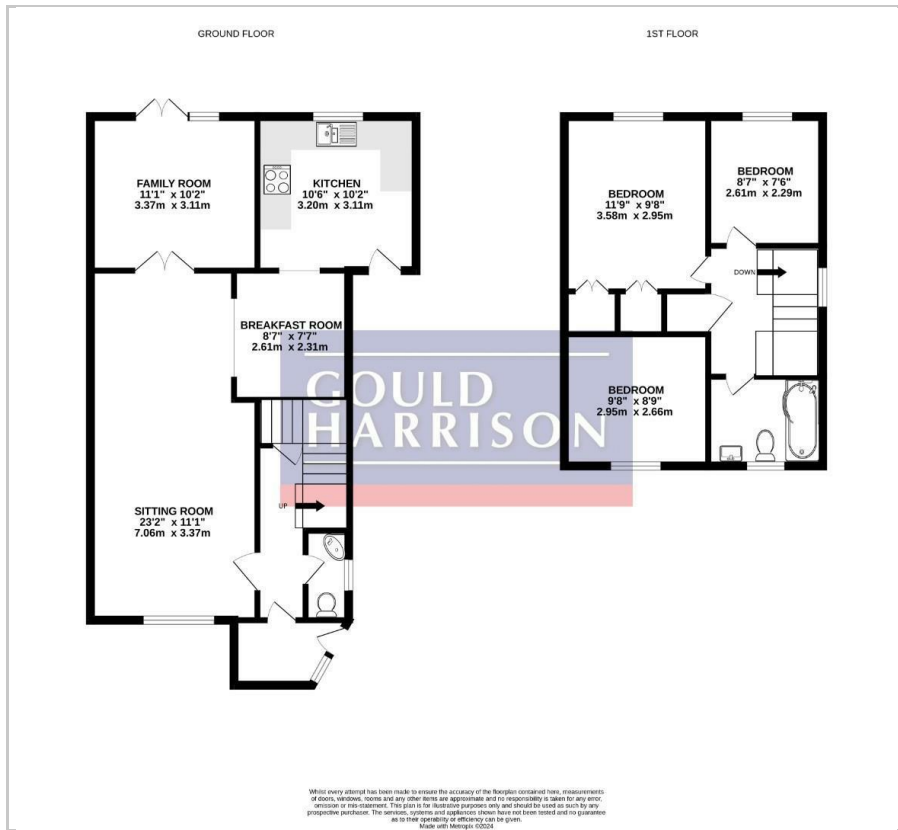

Area Map



Energy Efficiency Graph

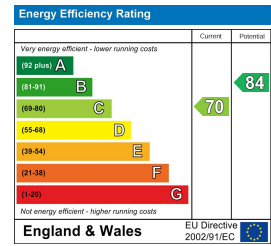

These particulars, whilst believed to be accurate are set out as a general outline only for guidance and do not constitute any part of an offer or contract. Intending purchasers should not rely on them as statements of representation of fact, but must satisfy themselves by inspection or otherwise as to their accuracy. No person in this firm's employment has the authority to make or give any representation or warranty in respect of the property.