



61 Richmond Meech Drive

Kennington, Ashford, TN24 9RF

Offers In Excess Of £175,000

Pleasantly appointed apartment ideally located for access to local shops, schools and leisure facilities.

Located on the first floor, the property comprises an entrance hall, sitting/dining room, kitchen, two double bedrooms and bathroom/WC.

The property also benefits from double glazing, electric heating and allocated parking.

Offered for sale with no onward chain.

Balance of 125 year lease from 2004.

Ground Rent: £125 doubling every 25 years from 2004.

Management Charge for 2023: £1,338.

Viewing

Please contact our Ashford Office on 01233 646411 if you wish to arrange a viewing appointment for this property or require further information.

- MODERN PURPOSE BUILT FLAT
- FIRST FLOOR
- TWO DOUBLE BEDROOMS
- SITTING/DINING ROOM
- ALLOCATED PARKING & VISITORS SPACES
- NO ONWARD CHAIN
- EPC - C (77)
- DOUBLE GLAZING
- BALANCE OF 125 YEAR LEASE FROM 2004



Floor Plan

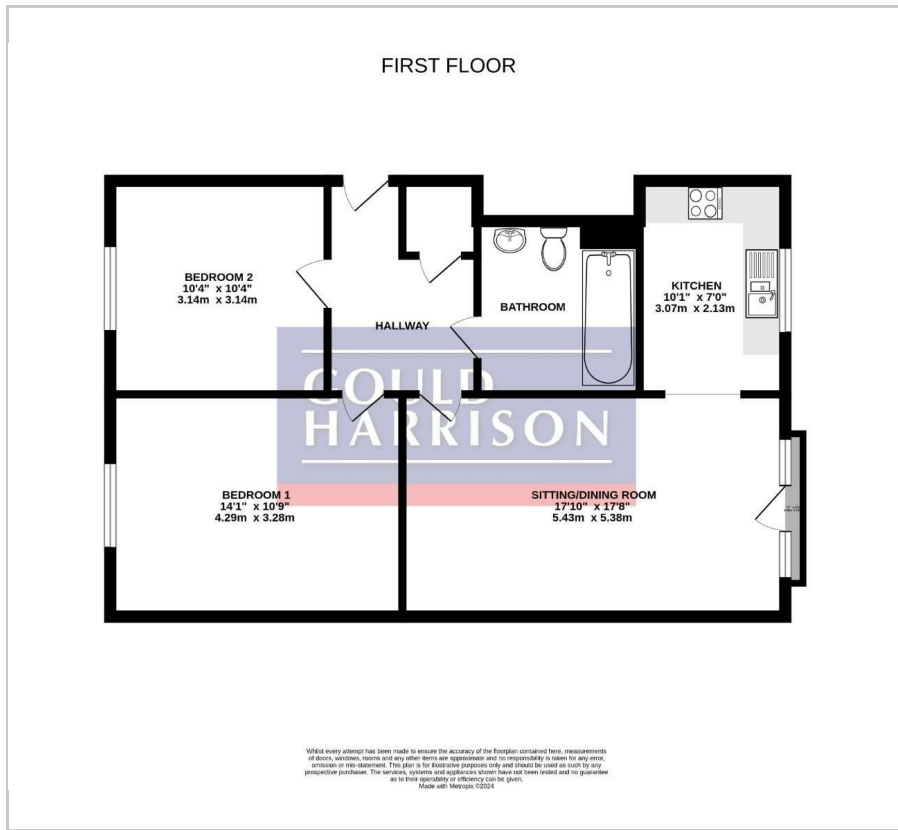

Area Map



Energy Efficiency Graph

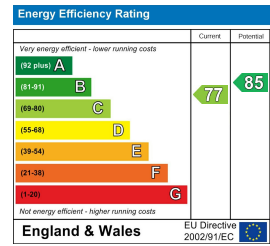

These particulars, whilst believed to be accurate are set out as a general outline only for guidance and do not constitute any part of an offer or contract. Intending purchasers should not rely on them as statements of representation of fact, but must satisfy themselves by inspection or otherwise as to their accuracy. No person in this firm's employment has the authority to make or give any representation or warranty in respect of the property.