



7 St Ambrose Green

Oxenturn Road, Wye, TN25 5AG

£1,800 Per Month

A most attractive, spacious home in a tranquil setting, just a short walk from all the wonderfully convenient amenities of Wye village.

The light and airy accommodation comprises an inviting entrance hall, sitting room overlooking the garden, kitchen/dining room, cloakroom, four bedrooms, en suite shower room and bathroom/WC.

The garden enjoys a secluded feel with further benefits of gas central heating, double glazing and double car port.

Available now

Security deposit £2076

Council tax band F

EPC Rating C

Viewing

Please contact our Ashford Office on 01233 646411 if you wish to arrange a viewing appointment for this property or require further information.

- ATTRACTIVE MODERN HOME
- TRANQUIL VILLAGE SETTING
- FOUR BEDROOMS
- OPEN PLAN KITCHEN/DINING ROOM
- GARDEN WITH SECLUDED FEEL
- DOUBLE CARPORT
- LIGHT AND AIRY ACCOMMODATION
- GF CLOAKROOM
- SHORT WALK TO AMENITIES
- EPC RATING C



Floor Plan

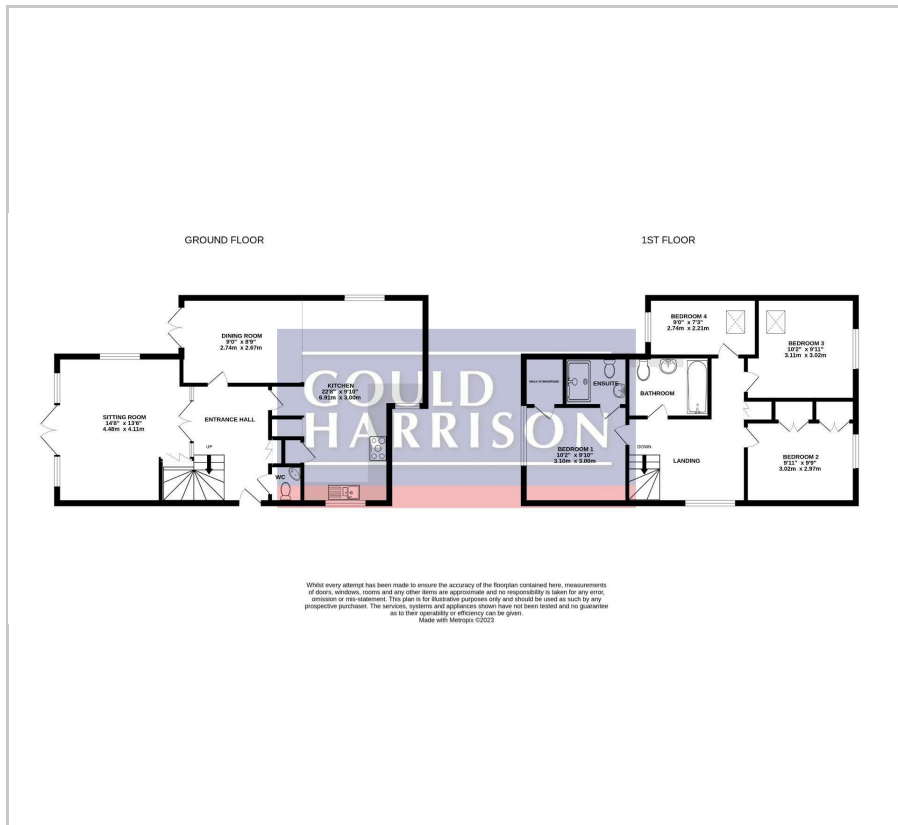

Area Map



Energy Efficiency Graph

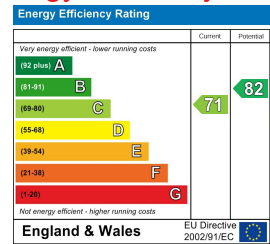

These particulars, whilst believed to be accurate are set out as a general outline only for guidance and do not constitute any part of an offer or contract. Intending purchasers should not rely on them as statements of representation of fact, but must satisfy themselves by inspection or otherwise as to their accuracy. No person in this firm's employment has the authority to make or give any representation or warranty in respect of the property.

1 Middle Row, Ashford, Kent, TN24 8SQ

Tel: 01233 646411 Email: sales@gouldharrison.co.uk