



19 Raymond Fuller Way

Kennington, Ashford, TN24 9TA

Offers In Excess Of £325,000

Available for sale with no onward chain is this modern, end of terrace home on the popular Little Burton Development.

The property comprises an entrance hall, cloakroom, sitting room, dining room, kitchen, three bedrooms and bathroom/WC. Gas central heating is installed along with double glazing with the property also benefitting from an enclosed rear garden and allocated parking.

Local schools, shops and transport links are all within easy.

Viewing

Please contact our Ashford Office on 01233 646411 if you wish to arrange a viewing appointment for this property or require further information.

- END OF TERRACE HOUSE
- THREE BEDROOMS
- TWO RECEPTION ROOMS
- ENCLOSED REAR GARDEN
- NO ONWARD CHAIN
- GAS CENTRAL HEATING
- DOUBLE GLAZING
- CLOSE TO LOCAL AMENITIES
- ALLOCATED PARKING

Floor Plan

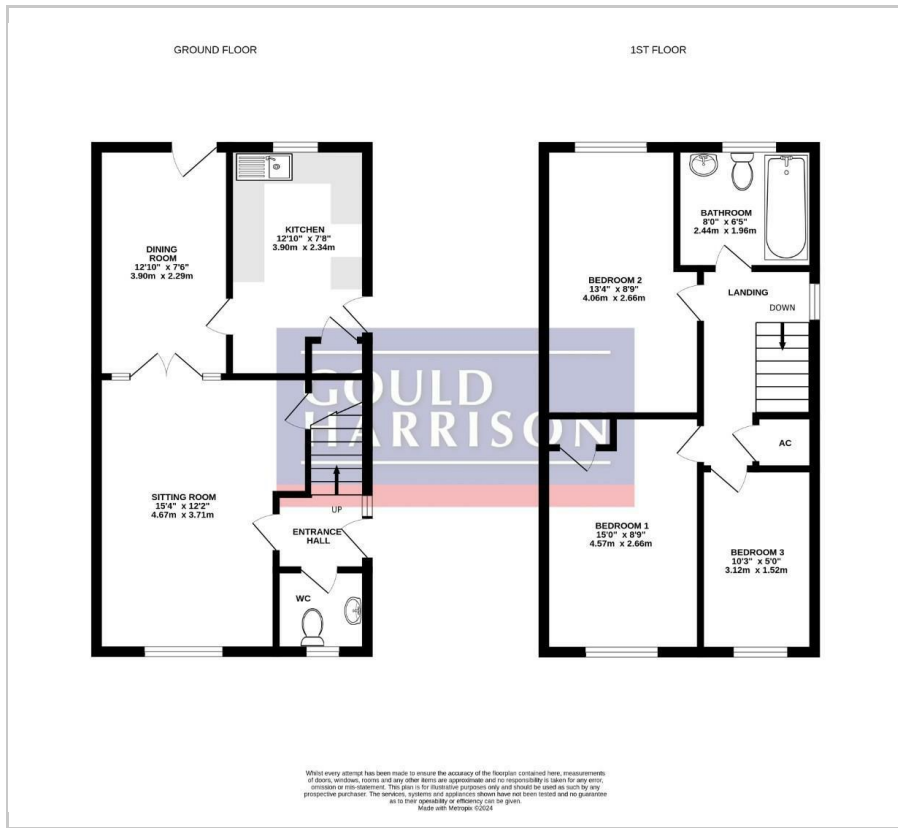

Area Map



Energy Efficiency Graph

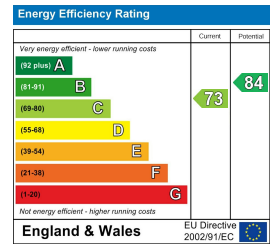

These particulars, whilst believed to be accurate are set out as a general outline only for guidance and do not constitute any part of an offer or contract. Intending purchasers should not rely on them as statements of representation of fact, but must satisfy themselves by inspection or otherwise as to their accuracy. No person in this firm's employment has the authority to make or give any representation or warranty in respect of the property.