



119 Newenden Close

Ashford, TN23 5TF

Price £275,000

Spacious three bedroom end of terrace house in good order throughout, with open outlook to the front. Off road parking.

- SPACIOUS END OF TERRACE HOUSE
- OPEN OUTLOOK TO THE FRONT
- THREE BEDROOMS
- OFF ROAD PARKING

Viewing

Please contact our Ashford Office on 01233 646411 if you wish to arrange a viewing appointment for this property or require further information.

Floor Plan

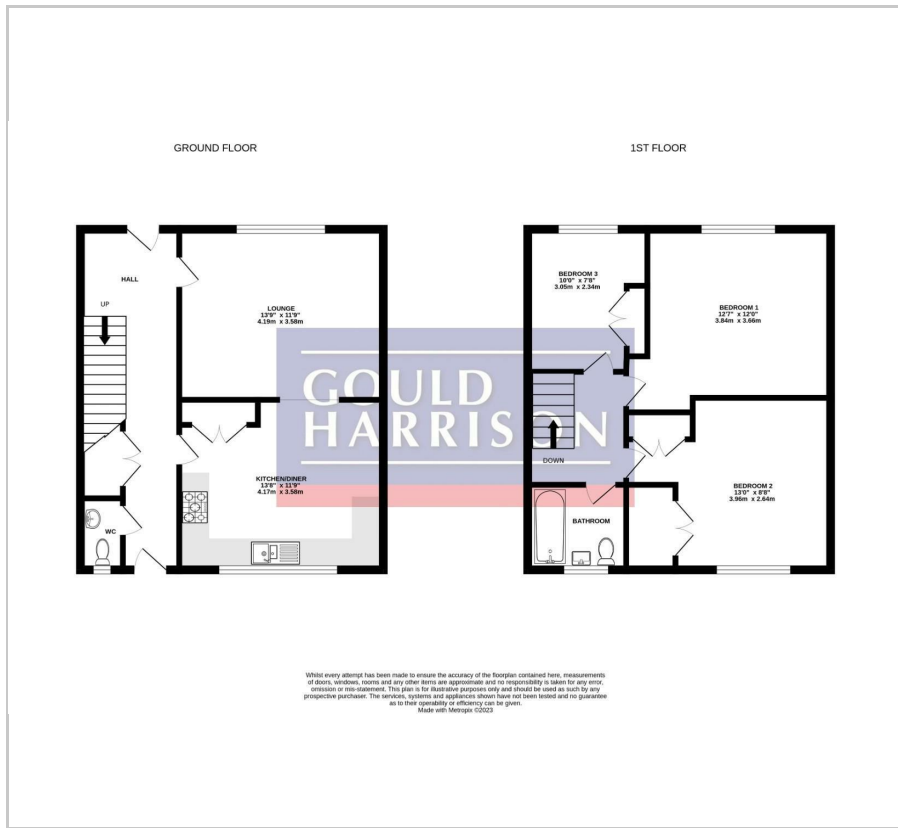

Area Map



Energy Efficiency Graph

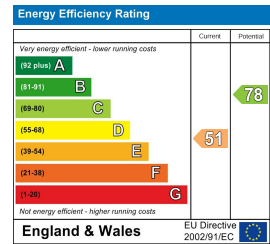

These particulars, whilst believed to be accurate are set out as a general outline only for guidance and do not constitute any part of an offer or contract. Intending purchasers should not rely on them as statements of representation of fact, but must satisfy themselves by inspection or otherwise as to their accuracy. No person in this firm's employment has the authority to make or give any representation or warranty in respect of the property.