



## 9 Hestia Way

Kingsnorth, Ashford, TN23 3RH

Guide Price £270,000

GUIDE PRICE £270,000 - £290,000

A very well presented staggered terraced home in the popular Kingsnorth area, in easy reach of local schools, shops and leisure facilities. The tastefully decorated accommodation comprises an entrance hall, sitting/dining room, kitchen, ground floor cloakroom, three bedrooms and bathroom/WC. Further benefits include; gas fired central heating, double glazing, an enclosed rear garden, garage to the rear and parking.

NO ONWARD CHAIN

### Viewing

Please contact our Ashford Office on 01233 646411 if you wish to arrange a viewing appointment for this property or require further information.

- STAGGERED TERRACED HOUSE
- THREE BEDROOMS
- SITTING/DINING ROOM
- GROUND FLOOR CLOAKROOM
- MODERN BOILER
- ENCLOSED REAR GARDEN
- VERY WELL PRESENTED
- GARAGE TO REAR
- POPULAR RESIDENTIAL LOCATION
- NO ONWARD CHAIN



# Floor Plan

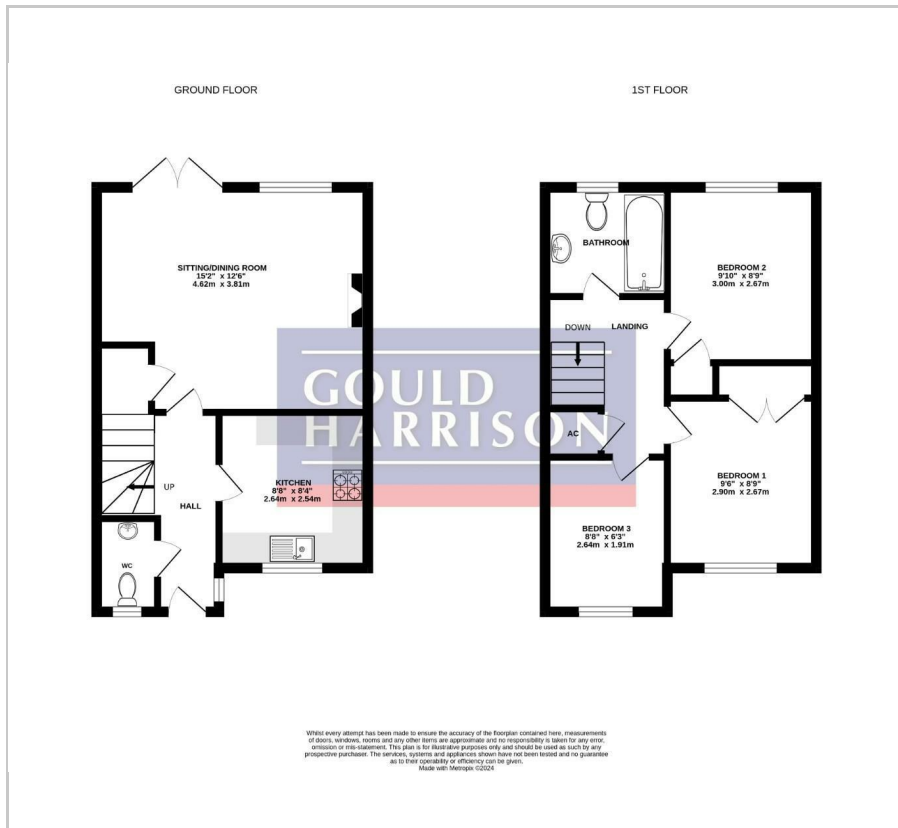

# Area Map



# Energy Efficiency Graph

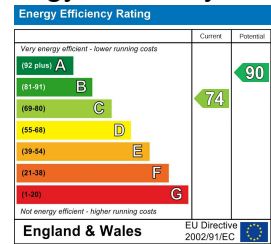

These particulars, whilst believed to be accurate are set out as a general outline only for guidance and do not constitute any part of an offer or contract. Intending purchasers should not rely on them as statements of representation of fact, but must satisfy themselves by inspection or otherwise as to their accuracy. No person in this firm's employment has the authority to make or give any representation or warranty in respect of the property.

1 Middle Row, Ashford, Kent, TN24 8SQ

**Tel:** 01233 646411 **Email:** sales@gouldharrison.co.uk