



## 104 Grasmere Road

Kennington, Ashford, TN24 9BG

Price £355,000

An impressively energy efficient semi detached house in a popular residential area, looking out across a protected green.

Extended to the ground floor, the property comprises an entrance hall, cloakroom, kitchen/breakfast room, sitting room, three bedrooms and bathroom/WC.

Solar panels are installed providing excellent benefit to the current owners on a transferable tariff with further benefits including double glazing, gas central heating and off road parking.

EPC Rating - B (89)

- ENERGY EFFICIENT SEMI DETACHED HOUSE
- THREE BEDROOMS
- OVERLOOKING PROTECTED GREEN
- DOWNSTAIRS CLOAKROOM
- GARAGE & PARKING
- SOLAR PANELS INSTALLED
- EPC RATING - B (89)

### Viewing

Please contact our Ashford Office on 01233 646411 if you wish to arrange a viewing appointment for this property or require further information.



3



1



1



B

# Floor Plan

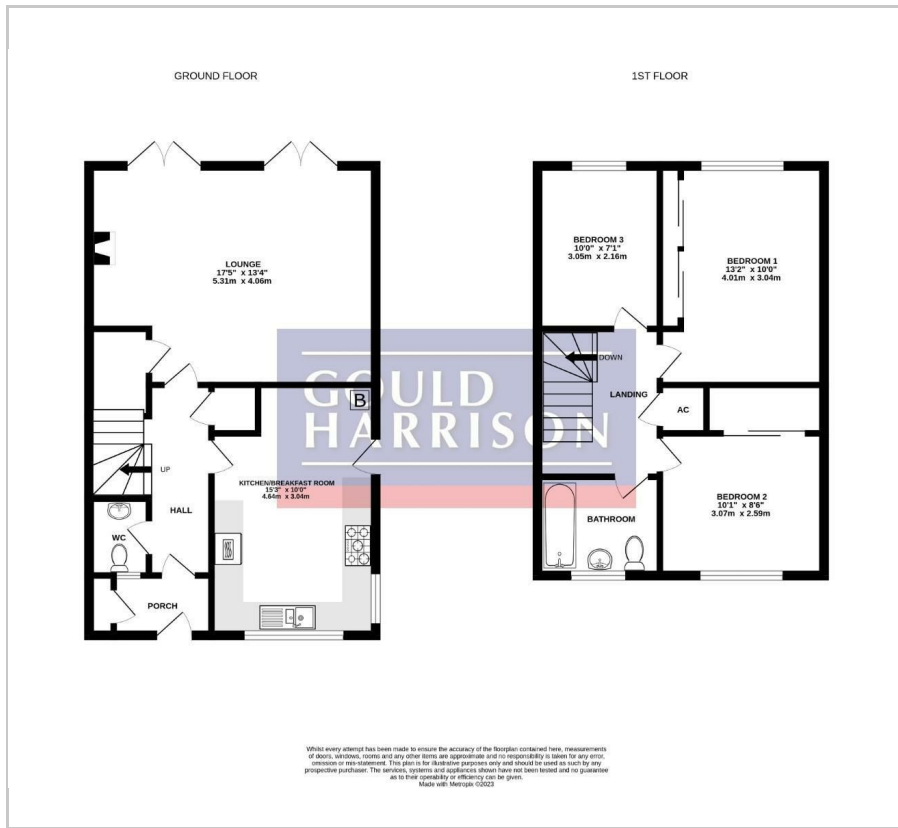

# Area Map



# Energy Efficiency Graph

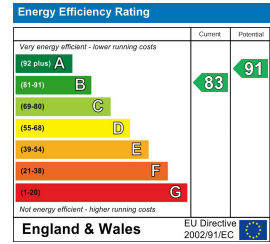

These particulars, whilst believed to be accurate are set out as a general outline only for guidance and do not constitute any part of an offer or contract. Intending purchasers should not rely on them as statements of representation of fact, but must satisfy themselves by inspection or otherwise as to their accuracy. No person in this firm's employment has the authority to make or give any representation or warranty in respect of the property.

1 Middle Row, Ashford, Kent, TN24 8SQ

Tel: 01233 646411 Email: sales@gouldharrison.co.uk