



## 9 Oxenturn Road

Wye, Ashford, TN25 5BH

Offers In Excess Of £625,000

A most attractive detached bungalow in the village of Wye, backing on to the beautiful cricket club grounds.

The property comprises an entrance porch and hallway, sitting/dining room, kitchen/breakfast room, three bedrooms, bathroom and cloakroom.

The delightful rear garden enjoys views up towards the Wye Crown with the property also benefitting from a newly installed boiler, double glazing, garage and driveway.

- EXTENDED DETACHED BUNGALOW
- BACKING ON TO WYE CRICKET CLUB
- THREE BEDROOMS
- KITCHEN/BREAKFAST ROOM
- GARAGE & DRIVEWAY
- BEAUTIFUL REAR GARDEN
- SHORT WALK FROM STATION & SHOPS

### Viewing

Please contact our Ashford Office on 01233 646411 if you wish to arrange a viewing appointment for this property or require further information.



# Floor Plan

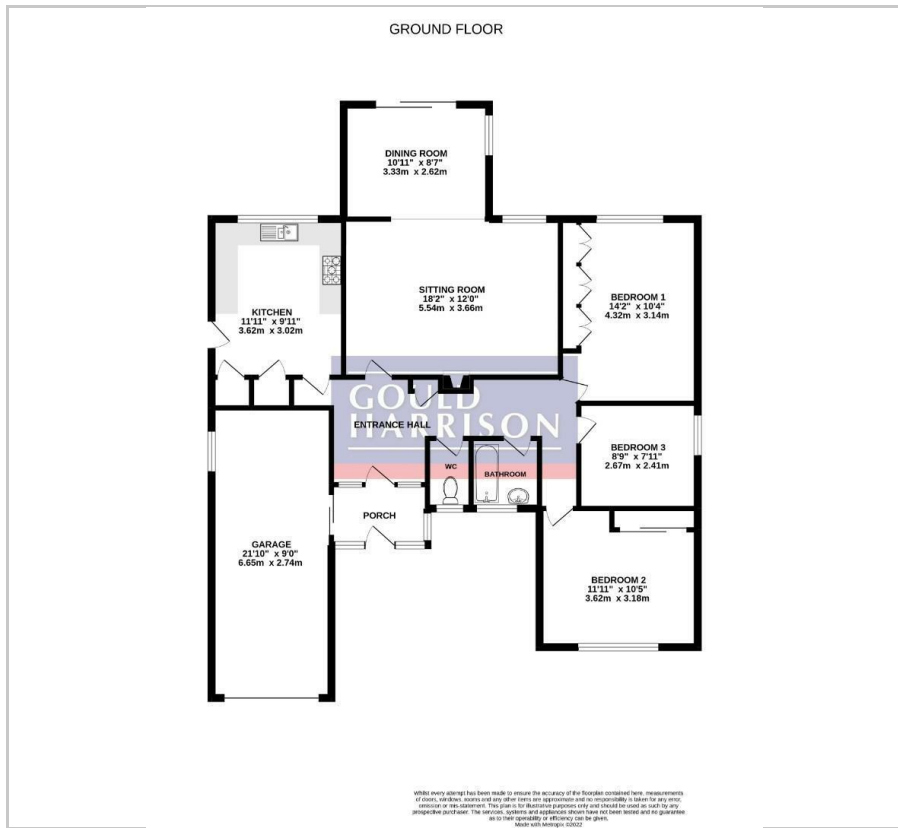

# Area Map



# Energy Efficiency Graph

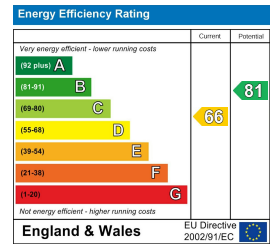

These particulars, whilst believed to be accurate are set out as a general outline only for guidance and do not constitute any part of an offer or contract. Intending purchasers should not rely on them as statements of representation of fact, but must satisfy themselves by inspection or otherwise as to their accuracy. No person in this firm's employment has the authority to make or give any representation or warranty in respect of the property.