



14 Jarmans Field

Wye, TN25 5AQ

Offers In Excess Of £325,000

A very well presented and spacious home on the popular Jarmans Field development for the over 60's.

Arranged over two floors this delightful property comprises an entrance hall, utility/WC, sitting room, dining room, kitchen, three bedrooms and bathroom/WC. To the rear is a private courtyard and parking with the property also benefitting from gas central heating, double glazing and a single garage.

Viewing

Please contact our Ashford Office on 01233 646411 if you wish to arrange a viewing appointment for this property or require further information.

- SPACIOUS ATTACHED PROPERTY
- OVER 60'S
- THREE BEDROOMS
- TWO RECEPTION ROOMS
- UTILITY/WC
- GARAGE & DRIVEWAY
- PRIVATE GARDEN
- FAR REACHING VIEWS TO REAR
- NO ONWARD CHAIN

Floor Plan

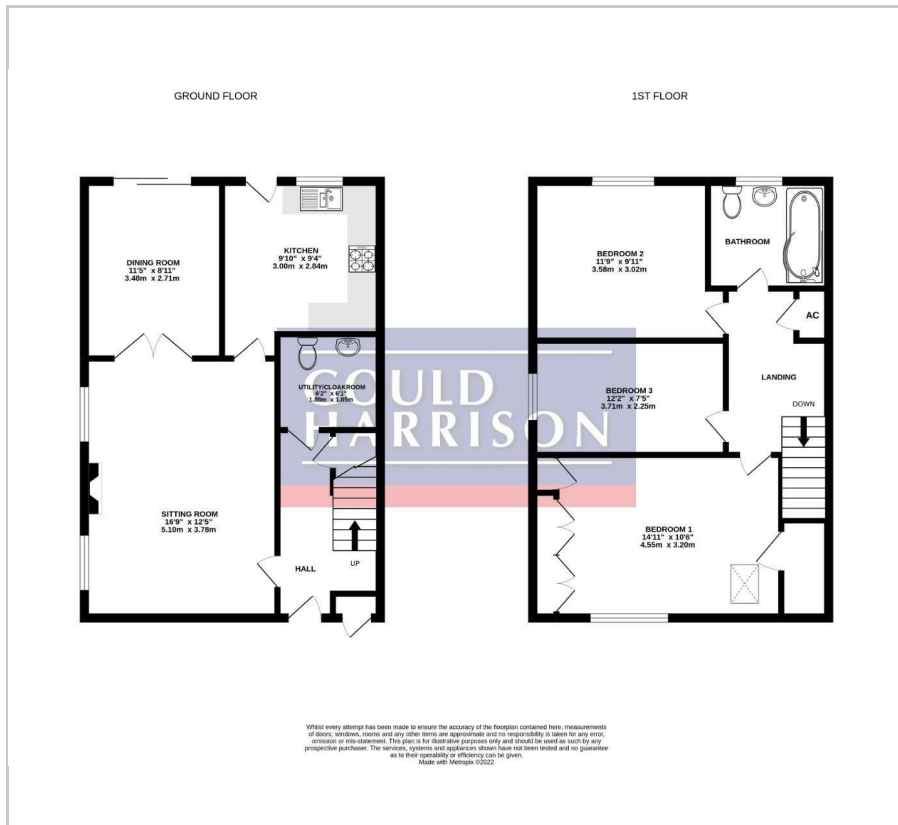

Area Map



Energy Efficiency Graph

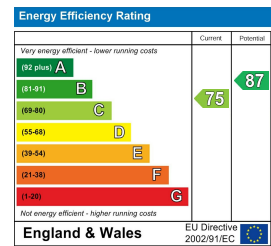

These particulars, whilst believed to be accurate are set out as a general outline only for guidance and do not constitute any part of an offer or contract. Intending purchasers should not rely on them as statements of representation of fact, but must satisfy themselves by inspection or otherwise as to their accuracy. No person in this firm's employment has the authority to make or give any representation or warranty in respect of the property.