

Habershon Drive,
Frimley, Camberley, GU16 9TW

£995 PCM



Luff Associates are delighted to bring to the market this first floor one bedroom apartment located in a quiet cul de sac location on the popular Cheylesmore Park Development.

The accommodation comprises entrance hall with built in storage cupboards, lounge/diner, kitchen, double bedroom with fitted wardrobe and bathroom with shower. Communal grounds surround the property with parking bays situated to the front of the block.

Available 27th March 2026 - Unfurnished
Regretfully no children or pets.

Council tax band: B
EPC rating: C
Minimum tenancy length - 12 months with a 6 month break clause.

Deposit = 5 weeks rent - £1,148
First Months rent - £995
Holding deposit - £229 (will be deducted from the first months rent upon move in)



1a Guildford Road, Frimley Green, Camberley, Surrey, GU16 6NL
Tel: 01252 834949 admin@luff-associates.com www.luff-associates.com

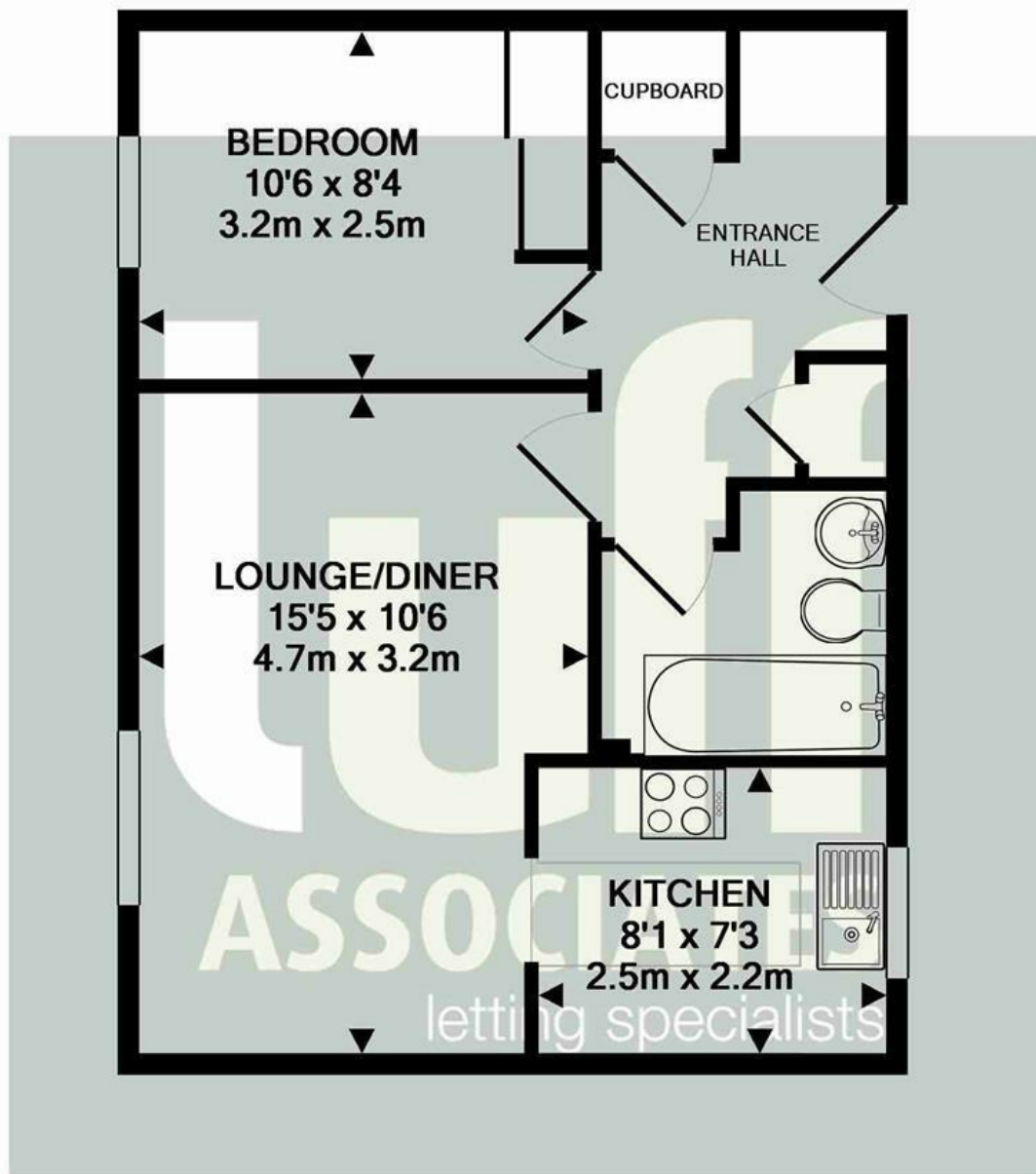

Whilst every attempt has been made to ensure the accuracy of the floor plan contained here, measurements of doors, windows, rooms and any other items are approximate and no responsibility is taken for any error, omission, or mis-statement. This plan is for illustrative purposes only and should be used as such by any prospective purchaser. The services, systems and appliances shown have not been tested and no guarantee as to their operability or efficiency can be given
Made with Metropix ©2014

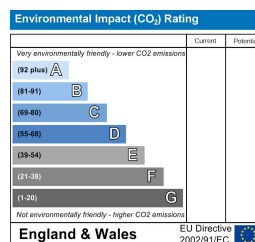
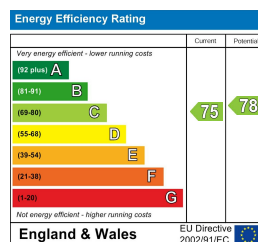

In partnership with
LUFF & WILKIN
sales 01252 838 899

Disclaimer: The Rent advertised does not include the Tenancy Deposit or any fee's or charges which are payable. Further information can be obtained from the agent or at the point of viewing. These details have been prepared and issued in good faith and do not constitute representations of fact or form part of any offer or contract Luff Associates Ltd have not carried out a structural survey of the property, nor have we tested any of the services or appliances. All measurements are intended to be approximate only and all photographs show parts of the property as they were at the time they were taken. Any reference to alterations or particular use of the property wherever stated, is not a statement that planning, building regulations or other relevant sent has been obtained