

# Cambrian Close, Camberley, Surrey, GU15 3LD

**£1,995 PCM**



\*\*\* Available 6th June 2025\*\*\*

Luff Associates are proud to offer this four bedroom two bathroom detached home, situated in a small and sought after cul de sac close to Camberley town centre and British Rail mainline station. It is also ideally placed for local schools.

The newly redecorated accommodation on the ground floor comprises of a large living/dining room with doors to garden, kitchen with white goods, dining room and cloakroom and on the first floor there are the four double bedrooms, family bathroom and additional en-suite shower room. Outside there is driveway parking and single garage. To the rear is a lovely garden that is mainly laid to lawn with mature shrubs.

Unfurnished  
Regret No Pets  
Council tax band F £ 3534.79PA  
Disclaimer; Council tax charges change annually

- Detached four bedroom house
- Single garage
- Driveway parking
- Enclosed rear garden
- Fitted kitchen
- Close to Camberley town centre
- Redecorated throughout
- Quiet location

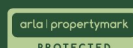

1a Guildford Road, Frimley Green, Camberley, Surrey, GU16 6NL  
Tel: 01252 834949 admin@luff-associates.com www.luff-associates.com

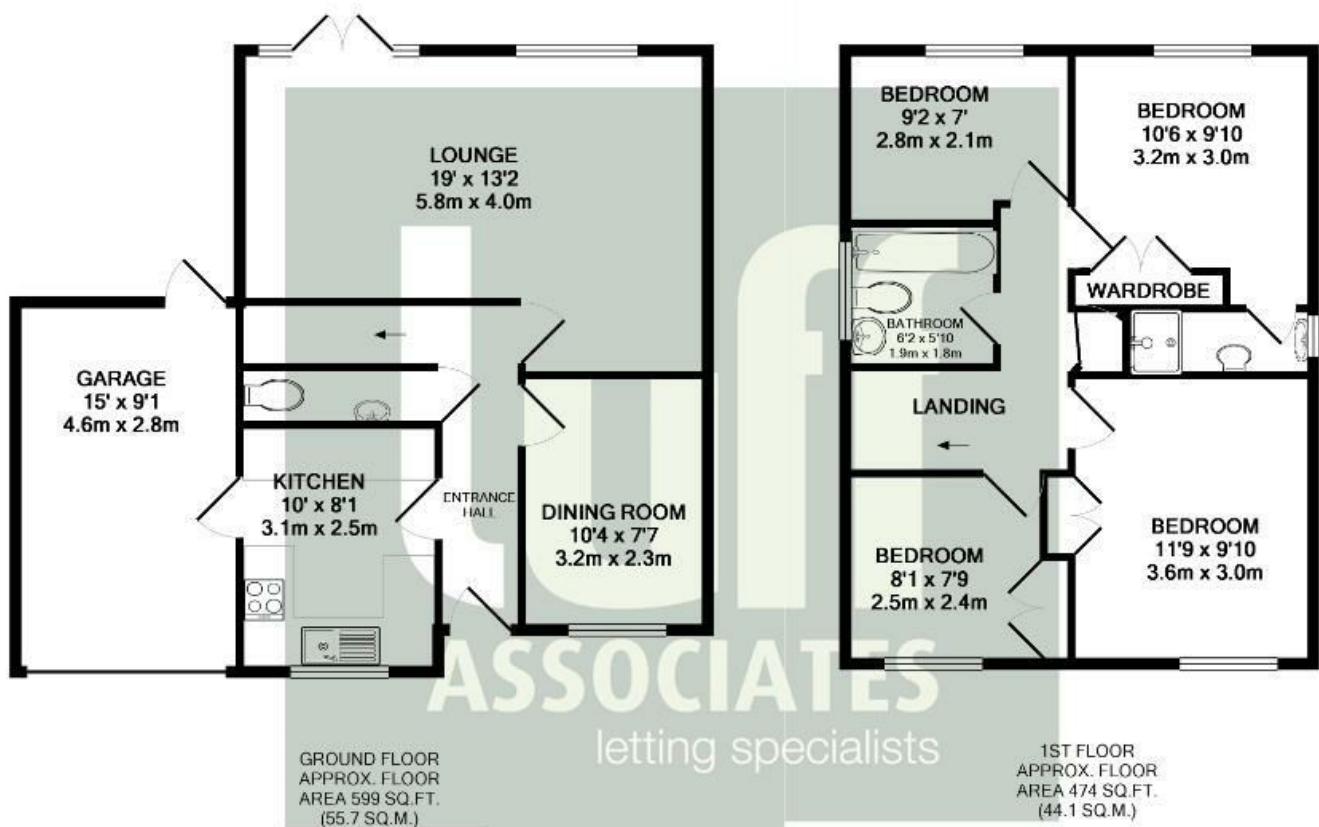

Whilst every attempt has been made to ensure the accuracy of the floor plan contained here, measurements of doors, windows, rooms and any other items are approximate and no responsibility is taken for any error, omission, or mis-statement. This plan is for illustrative purposes only and should be used as such by any prospective purchaser. The services, systems and appliances shown have not been tested and no guarantee as to their operability or efficiency can be given  
Made with Metropix ©2017

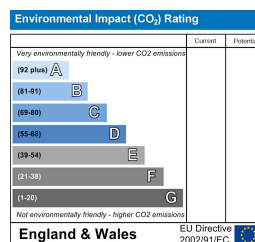
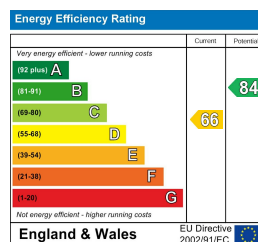

In partnership with  
**LUFF & WILKIN**  
sales 01252 838 899

Disclaimer: The Rent advertised does not include the Tenancy Deposit or any fee's or charges which are payable. Further information can be obtained from the agent or at the point of viewing. These details have been prepared and issued in good faith and do not constitute representations of fact or form part of any offer or contract Luff Associates Ltd have not carried out a structural survey of the property, nor have we tested any of the services or appliances. All measurements are intended to be approximate only and all photographs show parts of the property as they were at the time they were taken. Any reference to alterations or particular use of the property wherever stated, is not a statement that planning, building regulations or other relevant sent has been obtained